

COURROIES

X SPECIAL BELT

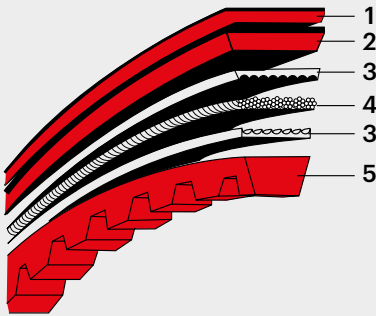

Utilisation Touring - Sportive

Caractéristiques techniques:

1. TISSU EN POLYAMIDE
2. TISSU CAOUTCHOUTE EN CHLOROPRENE
3. EPAISSEUR EN CHLOROPRENE
4. INSERT EN POLYESTERE
5. MELANGE DU CORPS EN CHLOROPRENE CHARGE EN FIBRES

XKBELT

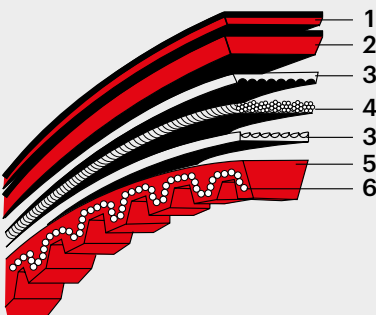

Utilisation Sportive - Racing

Caractéristiques techniques:

1. TISSU EN POLYAMIDE
2. TISSU CAOUTCHOUTE EN CHLOROPRENE
3. EPAISSEUR EN CHLOROPRENE
4. INSERT EN KEVLAR
5. MELANGE DU CORPS EN CHLOROPRENE CHARGE EN FIBRES
6. TISSU EN POLYAMIDE

COURROIES

COURROIES - Caractéristiques techniques par ordre de largeur

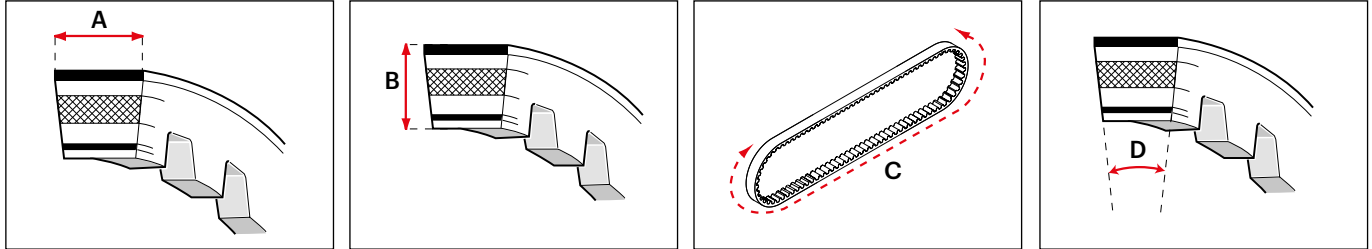

| Largeur mm (A) | Épaisseur mm (B) | Mesure extérieure mm (C) | Angle (D) | Modele | Réf. | Applications |
|----------------|------------------|--------------------------|-----------|----------------|----------------|--|
| 10 | 8 | 927 | 36° | X SPECIAL belt | 61 7224 | ITALJET PACK 50 2T PIAGGIO CIAO 50 2T PIAGGIO CIAO PX 50 2T |
| 10 | 8 | 950 | 36° | X SPECIAL belt | 61 7226 | ITALJET PACK 50 2T PIAGGIO CIAO 50 2T PIAGGIO CIAO PX 50 2T |
| 13 | 6,5 | 1056 | 30° | X K belt | 6117005 | PIAGGIO BRAVO 50 2T PIAGGIO SUPERBRAVO 50 2T |
| 13 | 6,5 | 1089 | 34° | X SPECIAL belt | 61 7222 | PIAGGIO GRILLO 50 2T |
| 13 | 6,5 | 1134 | 30° | X K belt | 6117006 | PIAGGIO BOSS 50 2T PIAGGIO BOXER 50 2T PIAGGIO SI 50 2T |
| 13 | 6,5 | 1143 | 34° | X SPECIAL belt | 61 7314 | PIAGGIO BOSS 50 2T PIAGGIO BOXER 50 2T PIAGGIO SI 50 2T |
| 13 | 6,5 | 974 | 30° | X K belt | 6116830 | PIAGGIO CIAO 50 2T PIAGGIO CIAO PX 50 2T |
| 13 | 6,5 | 978 | 34° | X SPECIAL belt | 61 7227 | PIAGGIO CIAO 50 2T PIAGGIO CIAO PX 50 2T |
| 13 | 8 | 870 | 38° | X SPECIAL belt | 61 7219 | PEUGEOT 103 -104 -105 50 2T PEUGEOT 103 SP 50 2T LC PEUGEOT ADVENGER 50 PEUGEOT HOLLYWOOD 50 PEUGEOT VOGUE 50 2T PEUGEOT XP 50 2T PEUGEOT XP 50 2T LC |
| 13,4 | 6,5 | 1060 | 34° | X SPECIAL belt | 61 7223 | PIAGGIO BRAVO 50 2T PIAGGIO SUPERBRAVO 50 2T |
| 14,5 | 8 | 819 | 30° | X SPECIAL belt | 6112745 | MBK 51 V 50 (AV 10) MBK MAGNUM 50 (AV 10) MBK PASSION 50 (AV 10) MBK RACING 50 (AV 10) MBK ROCK 50 |
| 15 | 8 | 650 | 32° | X K belt | 61 7215 | BSV DIO SP 50 (AF18E) BSV DIO SR 50 (AF18E) HONDA DIO SP 50 2T (AF18E) HONDA DIO SR 50 2T (AF18E) HSC SC 01 50 (AF18E) |
| 15 | 8 | 747 | 30° | X SPECIAL belt | 61 7220 | PEUGEOT 103 RCX 50 PEUGEOT 103 SPX 50 |
| 15 | 8 | 793 | 30° | X SPECIAL belt | 61 7216 | GARELLI PONY 50 2T ITALJET BAZOOKA 50 2T ITALJET PISTA 50 2T ITALJET REPORTER 50 MBK ACTIVE 50 |

COURROIES

COURROIES - Caractéristiques techniques par ordre de largeur

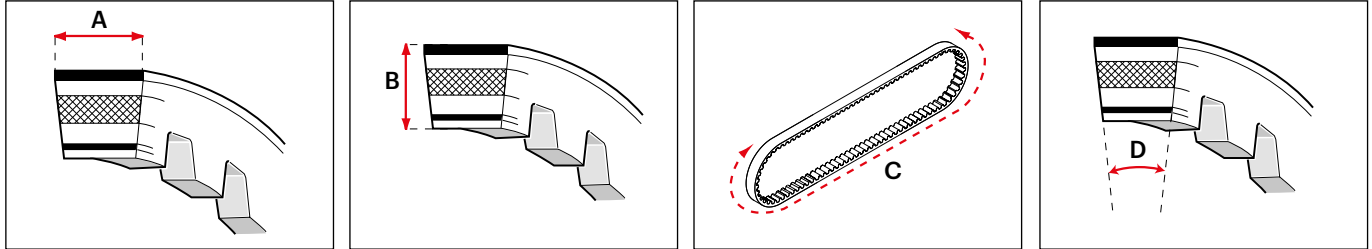

| Largeur mm (A) | Épaisseur mm (B) | Mesure extérieure mm (C) | Angle (D) | Modele | Réf. | Applications |
|----------------|------------------|--------------------------|-----------|----------------|----------------|--|
| 15 | 8 | 852 | 32° | X SPECIAL belt | 61 7233 | MBK SORRISO 50 2T <-1995 YAMAHA BELUGA 50 YAMAHA CT 50 2T |
| 15,3 | 8 | 642 | 32° | X SPECIAL belt | 61 7213 | HONDA SH 50 2T <-1995 HONDA AERO NB 50 2T 1987 HONDA VISION 50 2T HONDA VISION MET IN 50 2T PEUGEOT RAPIDO 50 2T PEUGEOT ST 50 2T |
| 15,5 | 8,5 | 1049 | 30° | X SPECIAL belt | 6119260 | PIAGGIO BRAVO 50 2T |
| 15,5 | 8,5 | 1163 | 30° | X SPECIAL belt | 6118940 | HONDA WALLAROO 50 PEUGEOT FOX 50 PIAGGIO BOSS 50 2T PIAGGIO SI 50 2T |
| 15,5 | 8,5 | 969 | 30° | X SPECIAL belt | 6119261 | PIAGGIO CIAO PX 50 2T |
| 16 | 8 | 751 | 28° | X SPECIAL belt | 6118140 | APRILIA AMICO 50 2T APRILIA AREA 51 50 2T LC APRILIA GULLIVER 50 2T APRILIA GULLIVER 50 2T LC APRILIA RALLY 50 2T (MINARELLI) APRILIA RALLY 50 2T LC (MINARELLI) APRILIA SCARABEO 50 2T (MINARELLI) APRILIA SR 50 2T <-1993 APRILIA SR 50 2T 1994-> APRILIA SR NETSCAPER 50 2T LC (MINARELLI) APRILIA SR RACING 50 2T LC (MINARELLI) APRILIA SR REPLICA 50 2T LC <-1999 APRILIA SR STEALTH 50 2T LC (MINARELLI) APRILIA SR WWW 50 2T ATALA CAROSELLO 50 2T BENELLI 491 GT 50 2T (MINARELLI) BENELLI 491 SPORT 50 2T LC (MINARELLI) BENELLI K2 50 2T BENELLI K2 50 2T LC BENELLI NAKED 50 2T BENELLI PEPE 50 2T BETA ARK 50 2T BETA ARK 50 2T LC BETA CHRONO 50 2T BETA EIKON 50 2T LC BETA QUADRA 50 2T BETA TEMPO 50 2T ITALJET DRAGSTER 50 2T LC ITALJET PISTA 2 50 2T ITALJET SCOOP 50 2T ITALJET YANKEE 50 2T |

COURROIES

COURROIES - Caractéristiques techniques par ordre de largeur

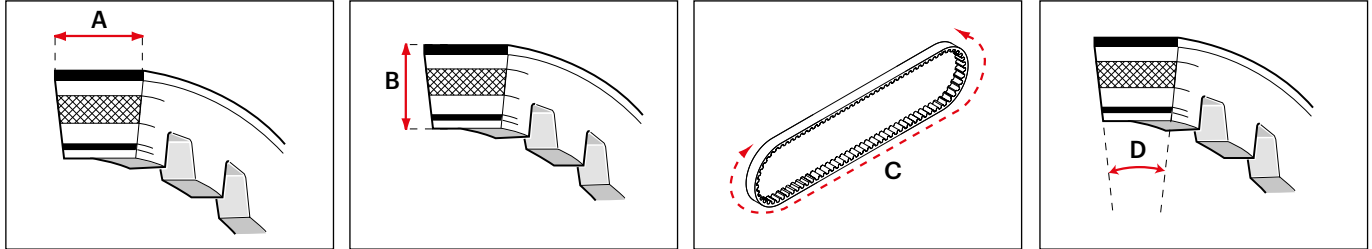

| Largeur mm (A) | Épaisseur mm (B) | Mesure extérieure mm (C) | Angle (D) | Modele | Réf. | Applications |
|----------------|------------------|--------------------------|-----------|--------|------|--------------|
|----------------|------------------|--------------------------|-----------|--------|------|--------------|

- MALAGUTI** CENTRO 50 2T
- MALAGUTI** CIAK 50 2T
- MALAGUTI** F12 DIGIT KAT-PHANTOM 50 2T LC
- MALAGUTI** F12 DIGIT KAT-PHANTOM 50 2T LC euro 2
- MALAGUTI** F12 R LC 50 2T LC euro 2
- MALAGUTI** F12-PHANTOM 50 2T
- MALAGUTI** F12-PHANTOM 50 2T LC
- MALAGUTI** F15 FIREFOX 50 2T LC
- MBK** BOOSTER 50 2T euro 0-1
- MBK** BOOSTER 50 2T euro 2 (A137E)
- MBK** BOOSTER NAKED 50 2T euro 2 (A137E)
- MBK** BOOSTER NG 50 2T euro 0-1
- MBK** BOOSTER NG 50 2T euro 2 (A137E)
- MBK** BOOSTER ROCKET 50 2T euro 0-1
- MBK** BOOSTER ROCKET 50 2T euro 2 (A137E)
- MBK** BOOSTER SPIRIT 50 2T euro 0-1
- MBK** FLIPPER 50 2T
- MBK** MACH G 50 2T
- MBK** MACH G 50 2T LC
- MBK** NITRO 50 2T LC
- MBK** OVETTO 50 2T
- MBK** STUNT 50 2T euro 0-1
- MBK** STUNT 50 2T euro 2
- YAMAHA** AEROX 50 2T LC euro 0-1
- YAMAHA** AEROX 50 2T LC euro 2
- YAMAHA** BW'S 50 2T euro 0-1
- YAMAHA** BW'S 50 2T euro 2 (A137E)
- YAMAHA** BW'S NG 50 2T euro 0-1
- YAMAHA** BW'S NG 50 2T euro 2 (A137E)
- YAMAHA** BW'S Original/Naked 50 2T euro 2 2010-> (A137E)
- YAMAHA** JOG R 50 2T
- YAMAHA** JOGRR 50 2T LC euro 2
- YAMAHA** NEO'S 50 2T
- YAMAHA** SLIDER 50 2T
- YAMAHA** SPY 50 2T
- YAMAHA** WHY 50 2T
- YAMAHA** ZUMA 50 2T

16 8 832 26° X SPECIAL belt **6111164**

- CAGIVA** PROGRESS 50 2T
- DERBI** ATLANTIS 50 2T <-2002
- DERBI** ATLANTIS 50 2T LC
- DERBI** HUNTER 50 2T
- DERBI** PADDOCK 50 2T
- DERBI** PADDOCK 50 2T LC
- DERBI** PREDATOR 50 2T
- DERBI** PREDATOR 50 2T LC

COURROIES

COURROIES - Caractéristiques techniques par ordre de largeur

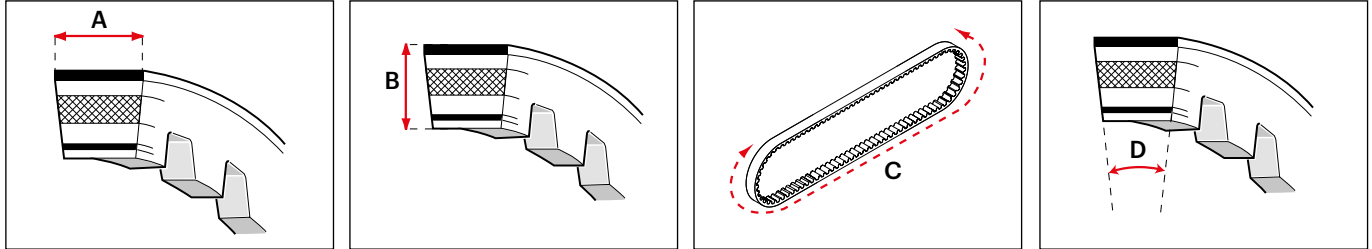

| Largeur mm (A) | Épaisseur mm (B) | Mesure extérieure mm (C) | Angle (D) | Modele | Réf. | Applications |
|----------------|------------------|--------------------------|-----------|----------------|----------------|---|
| 16,5 | 8 | 670 | 30° | X K belt | 61 7231 | ITALJET TORPEDO 50 2T ITALJET VELOCIFERO 50 2T RIZZATO VAMOS 50 SUZUKI ADDRESS AH 50 2T SUZUKI AP 50 2T SUZUKI SEPIA 50 2T SUZUKI SEPIA ZZ 50 2T |
| 16,5 | 8 | 703 | 30° | X K belt | 61 7664 | CAGIVA CITY 50 2T |
| 16,5 | 8 | 796 | 30° | X SPECIAL belt | 6112741 | AEON MOTOR COBRA 50 2T (AT70) APRILIA SONIC 50 2T APRILIA SONIC 50 2T LC DINLI HELIX DL603 50 2T (06A53) DINLI HELIX DL603 90 2T (06B93) DINLI T.REX 50 2T DRR DRX 90 2T LC <-2015 DRR DRX 90 2T LC 2016-> E-TON VIPER RXL 50 2T E-TON VIPER RXL 90 2T LAVERDA QUASAR 50 2T (AR 03) MALAGUTI F10 50 2T MALAGUTI YESTERDAY 50 2T MBK BOOSTER X 50 ie 4T LC euro 2 MBK EVOLIS 50 2T MBK FIZZ 50 2T MBK FORTE 50 2T MBK NITRO 50 ie 4T LC euro 2 MBK OVETTO UBS 50 ie 4T LC euro 2 MBK SORRISO 50 2T 1996-> MBK TARGET 50 2T YAMAHA AEROX 4 50 ie 4T LC euro 2 (A326E) YAMAHA AEROX 4 50 ie 4T LC euro 4 2018-> (A333E) YAMAHA AXIS 50 2T YAMAHA BREEZE 50 2T YAMAHA C3 [XF] 50 ie 4T LC euro 2 (A311E) YAMAHA CRZ 50 2T YAMAHA GIGGLE [XF] 50 ie 4T LC euro 2 (A311E) YAMAHA JOG 50 2T YAMAHA JOG ER 50 2T YAMAHA JOG Z 50 2T YAMAHA NEO'S 4 50 ie 4T LC euro 2 (A316E) YAMAHA NEO'S 4 50 ie 4T LC euro 4 2019-> YAMAHA VINO 50 2T YAMAHA VOX [XF] 50 ie 4T LC euro 2 (A311E) YAMAHA ZEST 50 2T YAMAHA ZUMA FX 50 ie 4T LC |

COURROIES

COURROIES - Caractéristiques techniques par ordre de largeur

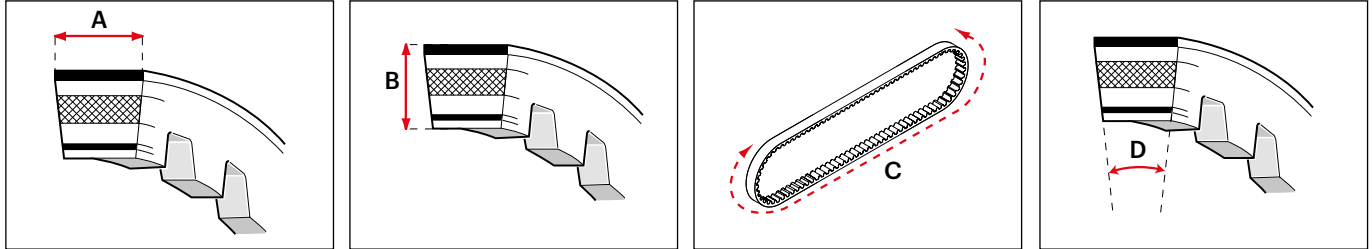

| Largeur mm (A) | Épaisseur mm (B) | Mesure extérieure mm (C) | Angle (D) | Modele | Réf. | Applications |
|----------------|------------------|--------------------------|-----------|----------|----------------|---|
| 16,6 | 8 | 745 | 28° | X K belt | 6117010 | APRILIA AMICO 50 2T APRILIA AREA 51 50 2T LC APRILIA GULLIVER 50 2T APRILIA GULLIVER 50 2T LC APRILIA RALLY 50 2T (MINARELLI) APRILIA RALLY 50 2T LC (MINARELLI) APRILIA SCARABEO 50 2T (MINARELLI) APRILIA SR 50 2T <-1993 APRILIA SR 50 2T 1994-> APRILIA SR NETSCAPER 50 2T LC (MINARELLI) APRILIA SR RACING 50 2T LC (MINARELLI) APRILIA SR REPLICA 50 2T LC <-1999 APRILIA SR STEALTH 50 2T LC (MINARELLI) APRILIA SR WWW 50 2T ATALA CAROSELLO 50 2T BENELLI 491 GT 50 2T (MINARELLI) BENELLI 491 SPORT 50 2T LC (MINARELLI) BENELLI K2 50 2T BENELLI K2 50 2T LC BENELLI NAKED 50 2T BENELLI PEPE 50 2T BETA ARK 50 2T BETA ARK 50 2T LC BETA CHRONO 50 2T BETA EIKON 50 2T LC BETA QUADRA 50 2T BETA TEMPO 50 2T ITALJET DRAGSTER 50 2T LC ITALJET PISTA 2 50 2T ITALJET SCOOP 50 2T ITALJET YANKEE 50 2T MALAGUTI CENTRO 50 2T MALAGUTI CIAK 50 2T MALAGUTI F12 DIGIT KAT-PHANTOM 50 2T LC MALAGUTI F12 DIGIT KAT-PHANTOM 50 2T LC euro 2 MALAGUTI F12 R LC 50 2T LC euro 2 MALAGUTI F12-PHANTOM 50 2T MALAGUTI F12-PHANTOM 50 2T LC MALAGUTI F15 FIREFOX 50 2T LC MBK BOOSTER 50 2T euro 0-1 MBK BOOSTER 50 2T euro 2 (A137E) MBK BOOSTER NAKED 50 2T euro 2 (A137E) MBK BOOSTER NG 50 2T euro 0-1 MBK BOOSTER NG 50 2T euro 2 (A137E) MBK BOOSTER ROCKET 50 2T euro 0-1 MBK BOOSTER ROCKET 50 2T euro 2 (A137E) |

COURROIES

COURROIES - Caractéristiques techniques par ordre de largeur

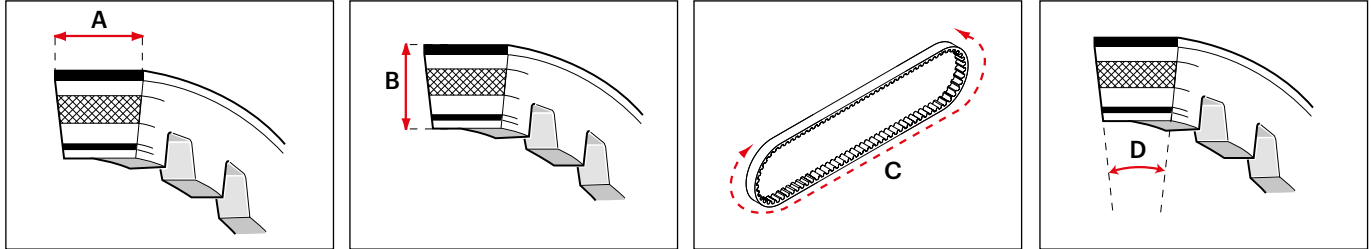

| Largeur mm (A) | Épaisseur mm (B) | Mesure extérieure mm (C) | Angle (D) | Modele | Réf. | Applications |
|----------------|------------------|--------------------------|-----------|--------|------|--------------|
|----------------|------------------|--------------------------|-----------|--------|------|--------------|

| | | | | | | |
|--|--|--|--|--|--|---|
| | | | | | | MBK BOOSTER SPIRIT 50 2T euro 0-1 MBK FLIPPER 50 2T MBK MACH G 50 2T MBK MACH G 50 2T LC MBK NITRO 50 2T LC MBK OVETTO 50 2T MBK STUNT 50 2T euro 0-1 MBK STUNT 50 2T euro 2 YAMAHA AEROX 50 2T LC euro 0-1 YAMAHA AEROX 50 2T LC euro 2 YAMAHA BW'S 50 2T euro 0-1 YAMAHA BW'S 50 2T euro 2 (A137E) YAMAHA BW'S NG 50 2T euro 0-1 YAMAHA BW'S NG 50 2T euro 2 (A137E) YAMAHA BW'S Original/Naked 50 2T euro 2 2010-> (A137E) YAMAHA JOG R 50 2T YAMAHA JOGRR 50 2T LC euro 2 YAMAHA NEO'S 50 2T YAMAHA SLIDER 50 2T YAMAHA SPY 50 2T YAMAHA WHY 50 2T YAMAHA ZUMA 50 2T |
|--|--|--|--|--|--|---|

| | | | | | | |
|------|---|-----|-----|----------|----------------|---|
| 16,9 | 8 | 800 | 28° | X K belt | 6117087 | AEON MOTOR COBRA 50 2T (AT70) APRILIA SONIC 50 2T APRILIA SONIC 50 2T LC DINLI HELIX DL603 50 2T (06A53) DINLI HELIX DL603 90 2T (06B93) DINLI T.REX 50 2T DRR DRX 90 2T LC <-2015 DRR DRX 90 2T LC 2016-> E-TON VIPER RXL 50 2T E-TON VIPER RXL 90 2T LAVERDA QUASAR 50 2T (AR 03) MALAGUTI F10 50 2T MALAGUTI YESTERDAY 50 2T MBK BOOSTER X 50 ie 4T LC euro 2 MBK EVOLIS 50 2T MBK FIZZ 50 2T MBK FORTE 50 2T MBK NITRO 50 ie 4T LC euro 2 MBK OVETTO UBS 50 ie 4T LC euro 2 MBK SORRISO 50 2T 1996-> MBK TARGET 50 2T YAMAHA AEROX 4 50 ie 4T LC euro 2 (A326E) YAMAHA AEROX 4 50 ie 4T LC euro 4 2018-> (A333E) YAMAHA AXIS 50 2T |
|------|---|-----|-----|----------|----------------|---|

COURROIES

COURROIES - Caractéristiques techniques par ordre de largeur

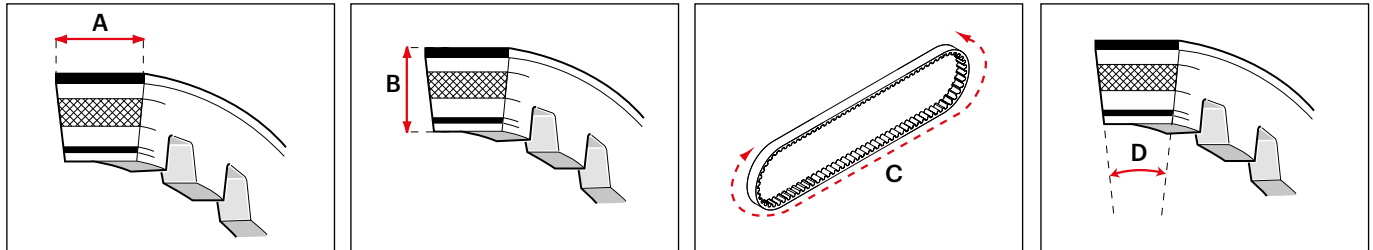

| Largeur mm (A) | Épaisseur mm (B) | Mesure extérieure mm (C) | Angle (D) | Modele | Réf. | Applications |
|----------------|------------------|--------------------------|-----------|----------------|----------------|---|
| 17 | 8 | 735 | 30° | X K belt | 61 7229 | YAMAHA BREEZE 50 2T YAMAHA C3 [XF] 50 ie 4T LC euro 2 (A311E) YAMAHA CRZ 50 2T YAMAHA GIGGLE [XF] 50 ie 4T LC euro 2 (A311E) YAMAHA JOG 50 2T YAMAHA JOG ER 50 2T YAMAHA NEO'S 4 50 ie 4T LC euro 2 (A316E) YAMAHA NEO'S 4 50 ie 4T LC euro 4 2019-> YAMAHA VINO 50 2T YAMAHA VOX [XF] 50 ie 4T LC euro 2 (A311E) YAMAHA ZEST 50 2T YAMAHA ZUMA FX 50 ie 4T LC |
| 17 | 8 | 781 | 30° | X K belt | 61 9591 | PIAGGIO SFERA 50 2T PIAGGIO SFERA 75 2T PIAGGIO ZIP 50 2T <-1999 SUZUKI KATANA 50 2T SUZUKI KATANA 50 2T LC |
| 17,5 | 8 | 724 | 30° | X K belt | 61 7665 | GILERA EASY MOVING 50 2T PIAGGIO QUARTZ 50 2T LC PIAGGIO SFERA RESTYLING 50 2T PIAGGIO ZIP Fast Rider 50 2T PIAGGIO ZIP SP 50 2T LC <-2000 VESPA ET2 50 2T <-1999 |
| 17,5 | 8 | 728 | 30° | X SPECIAL belt | 61 9829 | GILERA EASY MOVING 50 2T PIAGGIO QUARTZ 50 2T LC PIAGGIO SFERA RESTYLING 50 2T PIAGGIO ZIP Fast Rider 50 2T PIAGGIO ZIP SP 50 2T LC <-2000 VESPA ET2 50 2T <-1999 |
| 17,5 | 8 | 805 | 30° | X SPECIAL belt | 61 9832 | BENELLI PEPE LX 50 2T euro 2 (QJ1E40QMB-4) BENELLI QuattronoveX 50 2T euro 2 CPI ARAGON GP 50 2T CPI HUSSAR 50 2T 2003-> CPI OLIVER 50 2T 2003-> CPI POPCORN 50 2T 2003-> EXPLORER CRACKER 50 2T 2003-> (GE 1E 400 MB) GARELLI GSP 50 2T LC euro 2 (1PE40MB) GARELLI TIESSE 50R 50 2T euro 2 (1E40QMB) GARELLI VIP 50 4T (139 QMA) GILERA STORM 50 2T GILERA TYPHOON 50 2T HUPPER MONTECARLO 30 50 2T (1E40QMB) KEEWAY F-ACT 50 2T KEEWAY GOCCIA 50 2T (KW1E40QMB-4) |

COURROIES

COURROIES - Caractéristiques techniques par ordre de largeur

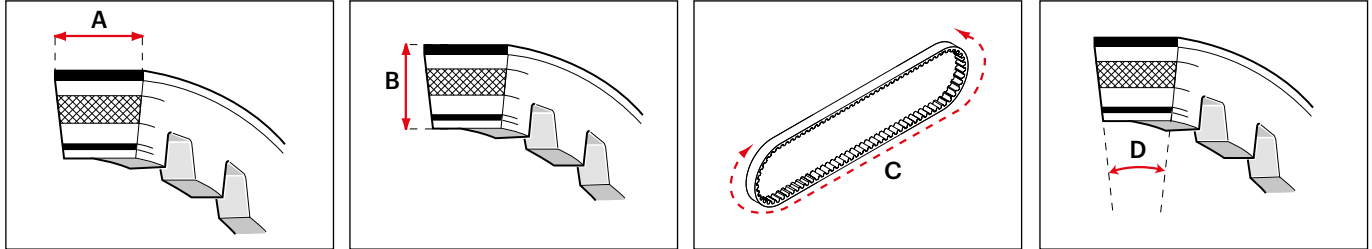

| Largeur mm (A) | Épaisseur mm (B) | Mesure extérieure mm (C) | Angle (D) | Modele | Réf. | Applications |
|----------------|------------------|--------------------------|-----------|--------|------|--------------|
|----------------|------------------|--------------------------|-----------|--------|------|--------------|

| | | | | | | |
|--|--|--|--|--|--|---|
| | | | | | | KEEWAY HURRICANE 50 2T euro 2 (KW1E40QMB) KEEWAY MATRIX 50 2T (KW1E40QMB-4) KEEWAY PIXEL 50 2T euro 2 (KW1E40QMB) KEEWAY RY8 50 2T (KW1E40QMB-4) MALAGUTI F10 WAP 50 2T euro 2 (QJ*CMA03C*) MALAGUTI F12 R ARIA 50 2T euro 2 (QJ*CMA02C*) OVER B3 50 4T LC (LJ1P38MB) OVER THOR 50 2T LC 2013-> (LJ1PE40MB) PIAGGIO FREE 50 2T PIAGGIO NRG 50 2T LC PIAGGIO NRG MC2 50 2T LC <-1997 PIAGGIO NTT 50 2T LC |
|--|--|--|--|--|--|---|

| | | | | | | |
|------|---|-----|-----|----------|----------------|---|
| 17,5 | 8 | 815 | 30° | X K belt | 6111108 | APRILIA SONIC 50 2T APRILIA SONIC 50 2T LC DRR DRX 90 2T LC <-2015 DRR DRX 90 2T LC 2016-> MALAGUTI F10 50 2T MALAGUTI YESTERDAY 50 2T MBK EVOLIS 50 2T MBK FIZZ 50 2T MBK FORTE 50 2T MBK HOT CHAMP 50 2T PEUGEOT LOOXOR TSDI 50 2T YAMAHA AXIS 50 2T YAMAHA BREEZE 50 2T YAMAHA JOG 50 2T YAMAHA JOG ER 50 2T YAMAHA JOG Z 50 2T YAMAHA VINO 50 2T YAMAHA ZEST 50 2T |
|------|---|-----|-----|----------|----------------|---|

| | | | | | | |
|------|-----|-----|-----|----------|----------------|---|
| 17,5 | 9,5 | 778 | 28° | X K belt | 6112959 | APRILIA SCARABEO 100 2T BENELLI K2 100 2T ITALJET MILLENNIUM 100 2T MBK BOOSTER 100 2T MBK NITRO 100 2T MBK OVETTO 100 2T YAMAHA AEROX 100 2T YAMAHA BW'S 100 2T YAMAHA NEO'S 100 2T |
|------|-----|-----|-----|----------|----------------|---|

| | | | | | | |
|------|-----|-----|-----|----------|---------------|--|
| 17,5 | 9,8 | 821 | 30° | X K belt | 618779 | ATALA HACKER 50 2T ATALA HACKER 50 2T LC ITALJET FORMULA 50 2T (F.MORINI) ITALJET FORMULA 50 2T LC (F.MORINI) MALAGUTI CIAK 100 2T MALAGUTI CROSSER CR1 50 2T |
|------|-----|-----|-----|----------|---------------|--|

COURROIES

COURROIES - Caractéristiques techniques par ordre de largeur

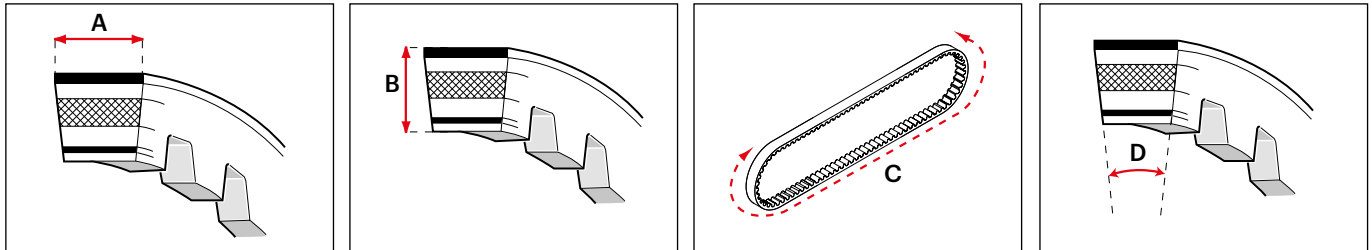

| Largeur mm (A) | Épaisseur mm (B) | Mesure extérieure mm (C) | Angle (D) | Modele | Réf. | Applications |
|----------------|------------------|--------------------------|-----------|--------|------|--------------|
|----------------|------------------|--------------------------|-----------|--------|------|--------------|

| | | | | | | |
|----|------|-----|-----|----------|----------------|--|
| 18 | 10,2 | 782 | 28° | X K belt | 6115822 | MALAGUTI F12-PHANTOM 100 2T APRILIA AMICO 50 2T APRILIA AREA 51 50 2T LC APRILIA GULLIVER 50 2T LC APRILIA RALLY 50 2T (MINARELLI) APRILIA RALLY 50 2T LC (MINARELLI) APRILIA SCARABEO 50 2T (MINARELLI) APRILIA SR 50 2T 1994-> APRILIA SR NETSCAPER 50 2T LC (MINARELLI) APRILIA SR RACING 50 2T LC (MINARELLI) APRILIA SR REPLICA 50 2T LC <-1999 APRILIA SR STEALTH 50 2T LC (MINARELLI) APRILIA SR WWW 50 2T BENELLI 491 GT 50 2T (MINARELLI) BENELLI 491 SPORT 50 2T LC (MINARELLI) BENELLI K2 50 2T BENELLI K2 50 2T LC BENELLI NAKED 50 2T BETA ARK 50 2T BETA ARK 50 2T LC BETA EIKON 50 2T LC BETA QUADRA 50 2T ITALJET DRAGSTER 50 2T LC MALAGUTI F12 DIGIT KAT-PHANTOM 50 2T LC MALAGUTI F12 DIGIT KAT-PHANTOM 50 2T LC euro 2 MALAGUTI F12 R LC 50 2T LC euro 2 MALAGUTI F12-PHANTOM 50 2T MALAGUTI F12-PHANTOM 50 2T LC MALAGUTI F15 FIREFOX 50 2T LC MBK BOOSTER 50 2T euro 0-1 MBK BOOSTER 50 2T euro 2 (A137E) MBK BOOSTER NAKED 50 2T euro 2 (A137E) MBK BOOSTER NG 50 2T euro 0-1 MBK BOOSTER NG 50 2T euro 2 (A137E) MBK BOOSTER ROCKET 50 2T euro 0-1 MBK BOOSTER ROCKET 50 2T euro 2 (A137E) MBK BOOSTER SPIRIT 50 2T euro 0-1 MBK FLIPPER 50 2T MBK MACH G 50 2T MBK MACH G 50 2T LC MBK NITRO 50 2T LC MBK OVETTO 50 2T MBK STUNT 50 2T euro 0-1 MBK STUNT 50 2T euro 2 YAMAHA AEROX 50 2T LC euro 0-1 YAMAHA AEROX 50 2T LC euro 2 |
|----|------|-----|-----|----------|----------------|--|

COURROIES

COURROIES - Caractéristiques techniques par ordre de largeur

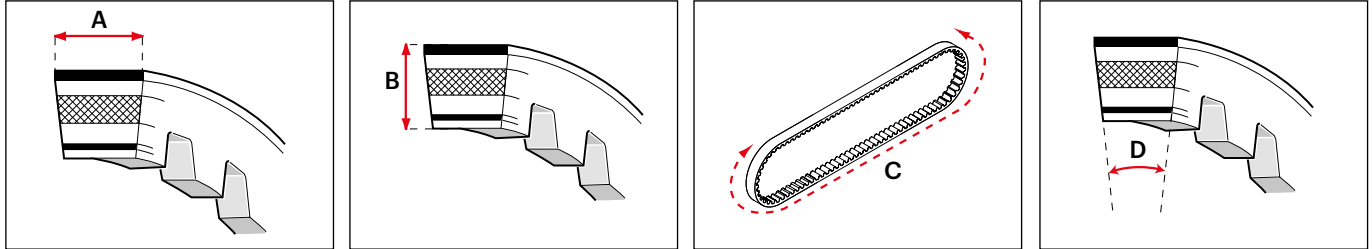

| Largeur mm (A) | Épaisseur mm (B) | Mesure extérieure mm (C) | Angle (D) | Modele | Réf. | Applications |
|----------------|------------------|--------------------------|-----------|----------------|----------------|--|
| 18 | 8 | 703 | 32° | X SPECIAL belt | 618396 | YAMAHA BW'S 50 2T euro 0-1 YAMAHA BW'S 50 2T euro 2 (A137E) YAMAHA BW'S NG 50 2T euro 0-1 YAMAHA BW'S NG 50 2T euro 2 (A137E) YAMAHA BW'S Original/Naked 50 2T euro 2 2010-> (A137E) YAMAHA JOG R 50 2T YAMAHA JOGRR 50 2T LC euro 2 YAMAHA NEO'S 50 2T YAMAHA SLIDER 50 2T YAMAHA SPY 50 2T YAMAHA WHY 50 2T YAMAHA ZUMA 50 2T |
| 18 | 8 | 769 | 32° | X SPECIAL belt | 6112735 | HONDA BALI 50 2T HONDA SFX 50 2T HONDA SHADOW 50 2T (AF18E) HONDA SXR 50 2T PEUGEOT SV GEO 50 2T PEUGEOT ZENITH 50 2T PEUGEOT BUXY 50 2T PEUGEOT BUXY RS 50 2T PEUGEOT ELYSEO 50 2T PEUGEOT JET FORCE C-TECH 50 2T LC PEUGEOT JET FORCE TSDI 50 2T LC (HL 1) PEUGEOT LOOXOR 50 2T PEUGEOT LUDIX 50 2T PEUGEOT LUDIX BLASTER 50 2T LC (HL 2) PEUGEOT METAL-X 50 2T PEUGEOT SPEEDAKE 50 2T PEUGEOT SPEEDFIGHT 2 50 2T LC 2004-> PEUGEOT SPEEDFIGHT 3 50 2T (B1E 40 QMB) PEUGEOT SPEEDFIGHT 3 50 2T LC PEUGEOT SPEEDFIGHT 3 50 4T (XS1P37QMA-2) PEUGEOT SPEEDFIGHT 50 2T PEUGEOT SPEEDFIGHT 50 2T LC PEUGEOT SQUAB 50 2T PEUGEOT TREKKER 50 2T PEUGEOT TWEET 50 4T euro 2 PEUGEOT TWEET ² RS 50 4T euro 2 PEUGEOT VIVACITY 50 2T PEUGEOT VIVACITY COMPACT 50 2T (FB2FP) PEUGEOT X-FIGHT 2 50 2T LC 2004-> PEUGEOT X-FIGHT 50 2T PEUGEOT X-FIGHT 50 2T LC SYM CROX 50 4T LC euro 4 2019-> (XS1P37QMA-2A) |
| 18 | 8 | 798 | 30° | X SPECIAL belt | 6117248 | HONDA RUCKUS 50 4T LC |

COURROIES

COURROIES - Caractéristiques techniques par ordre de largeur

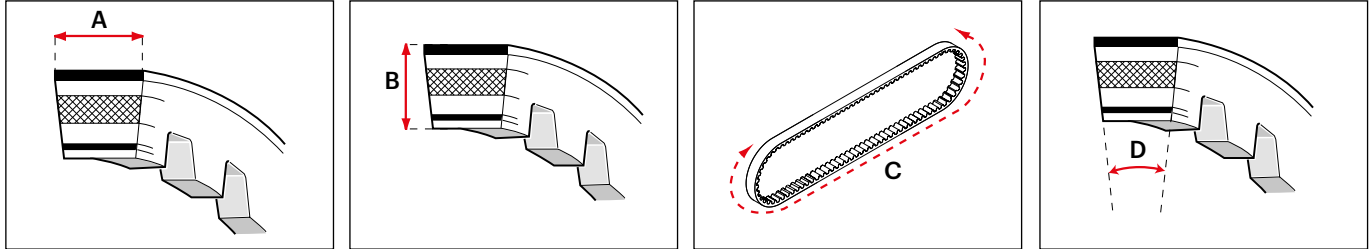

| Largeur mm (A) | Épaisseur mm (B) | Mesure extérieure mm (C) | Angle (D) | Modele | Réf. | Applications |
|----------------|------------------|--------------------------|-----------|----------------|----------------|--|
| 18 | 8 | 840 | 32° | X SPECIAL belt | 61 9221 | HONDA ZOOMER 50 4T LC HONDA SGX SKY 50 2T HONDA SH 50 2T 1996-> HONDA X8R X - X8R S 50 2T SYM JOYRIDE Evo I 200 ie 4T LC (KB2) |
| 18 | 9 | 675 | 32° | X K belt | 61 7211 | BSV DIO GP 50 (AF18E) BSV DIO ZX 50 <-1993 (AF18E) BSV DIO ZX 50 2T 1994-> (AF34E) HONDA DIO G 50 2T (AF18E) HONDA DIO ZX 50 2T <-1993 (AF18E) HONDA DIO ZX 50 2T 1994-> (AF34E) HSC SC 01 L 50 (AF18E) KYMCO CX 50 2T KYMCO DJ X 50 2T KYMCO DJ Y 50 2T SYM DD 50 2T |
| 18 | 9,5 | 680 | 30° | X SPECIAL belt | 6113397 | BAOTIAN ECO BIKE 50 4T (139 QMB) MALAGUTI DVD 50 4T (139 QMB) PEUGEOT V-CLIC 50 4T |
| 18 | 9,5 | 741 | 30° | X K belt | 6113501 | GARELLI FLEXI' 50 4T euro 2 (1P139 QMB) GARELLI TIESSE FOUR 50 4T euro 2 (1P39QMB) HUPPER MONTECARLO 30 50 4T (139QMB) KYMCO AGILITY R10/12 - RS 50 4T euro 2 (KL10B) KYMCO AGILITY R12 50 ie 4T euro 4 2019-> KYMCO AGILITY R16 - RS 50 4T euro 2 (KL10B) KYMCO AGILITY R16 + 50 2T euro 2 2016-> (KF10D) KYMCO AGILITY R16 + 50 4T euro 2 2017-> (KL10C) KYMCO AGILITY R16 + 50 ie 4T euro 4 2019->2021 KYMCO AGILITY R16 + 50 ie 4T euro 5 2022-> KYMCO AGILITY R16 50 2T euro 2 (KF10B) KYMCO DINK 50 4T euro 2 KYMCO LIKE 50 4T euro 2 (KG10A) KYMCO PEOPLE 50 4T euro 2 KYMCO PEOPLE S 50 4T euro 2 (BB10) KYMCO PEOPLE S 50 ie 4T euro 4 2019-> (KP10) KYMCO SUPER 8 50 4T euro 2 (KL10) KYMCO SUPER 8 R 50 4T euro 5 2023-> (KP10G) KYMCO VITALITY 50 4T euro 2 (SG10) SYM JET EuroX 50 2T euro 2 |

COURROIES

COURROIES - Caractéristiques techniques par ordre de largeur

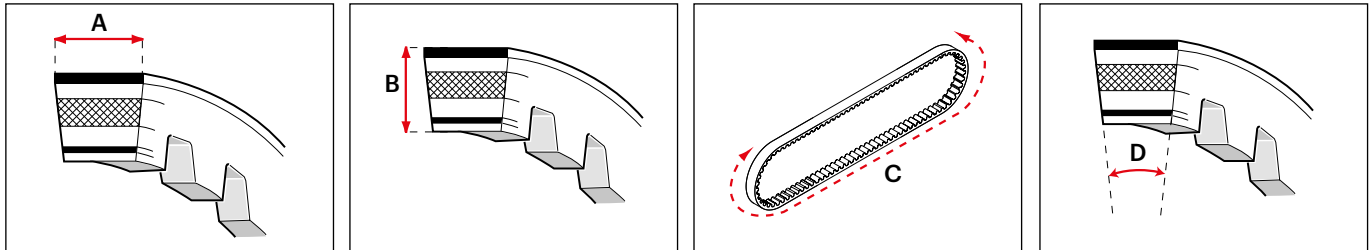

| Largeur mm (A) | Épaisseur mm (B) | Mesure extérieure mm (C) | Angle (D) | Modele | Réf. | Applications |
|----------------|------------------|--------------------------|-----------|----------------|----------------|---|
| 18,2 | 8 | 734 | 30° | X K belt | 6111153 | SYM JET SportX-S - SportX-R 50 2T euro 2 (T5C/1) WT MOTORS BILBAO 50 4T (PEDA 139QMB) KYMC O DINK 50 2T KYMC O DINK 50 2T LC KYMC O PEOPLE 50 2T KYMC O SUPER 9 50 2T LC KYMC O TOP BOY - COBRA 50 2T VESPA ET4 125 4T |
| 18,4 | 8 | 785 | 30° | X SPECIAL belt | 6116844 | APRILIA HABANA 50 2T APRILIA MOJITO 50 2T APRILIA SCARABEO DITECH 50 2T APRILIA SR DITECH 50 2T LC () APRILIA SR REPLICA 50 2T LC 2000-> () SUZUKI ESTILETE - UF 50 2T SUZUKI KATANA 50 2T SUZUKI KATANA 50 2T LC SUZUKI ZILLION 50 2T LC SYM PHONY 50 4T euro 2 (XS1P37QMA-2) SYM PHONY 50 4T euro 5 2021-> (XS1P37QMA-3) SYM PHONY ST 50 4T euro 5 2021-> (XS1P37QMA-3) SYM PLY 50 4T euro 2 (XS1P39QMB) |
| 18,5 | 8 | 727 | 30° | X SPECIAL belt | 6111246 | PIAGGIO FLY 50 4T PIAGGIO ZIP 3V iGet 50 ie 4T euro 5 2021-> PIAGGIO ZIP 50 2T 2000-> (C25EM) PIAGGIO ZIP 50 4T PIAGGIO ZIP S 3V iGet 50 ie 4T euro 5 2021-> PIAGGIO ZIP SP 50 2T LC 2001-> SYM MIO 100 4T euro 3 (A5A-1) VESPA ET2 50 2T 2000-> VESPA ET4 50 4T VESPA LX 4V 50 4T euro 2 VESPA LX 50 2T VESPA LX 50 4T VESPA S 4V 50 4T euro 2 (C386M) VESPA S 50 2T euro 2 (C381M) |
| 18,5 | 8 | 765 | 30° | X K belt | 6116424 | APRILIA SXR 50 ie 4T euro 5 2021-> (CD32M) PIAGGIO ZIP 3V iGet 50 ie 4T euro 4 2018->2020 VESPA Primavera 3V iGet 50 ie 4T euro 4 2018->2020 (CA03M) VESPA Primavera 3V iGet 50 ie 4T euro 5 2021->2023 (CD01M) VESPA Primavera 3V iGet 50 ie 4T euro 5 2024-> |

COURROIES

COURROIES - Caractéristiques techniques par ordre de largeur

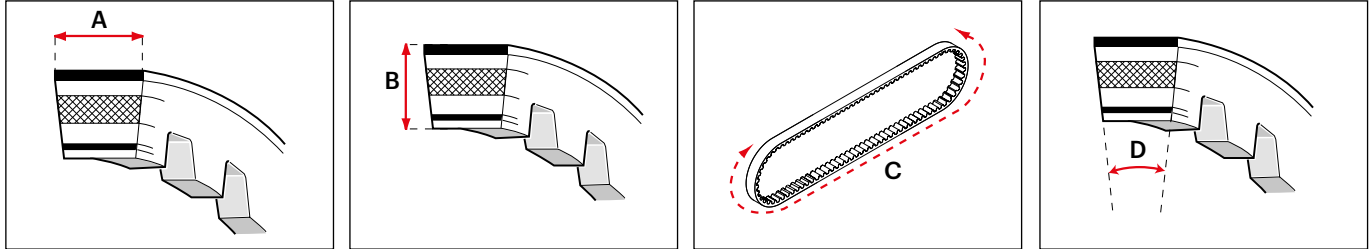

| Largeur mm (A) | Épaisseur mm (B) | Mesure extérieure mm (C) | Angle (D) | Modele | Réf. | Applications |
|----------------|------------------|--------------------------|-----------|--------|------|--------------|
|----------------|------------------|--------------------------|-----------|--------|------|--------------|

| | | | | | | |
|------|---|-----|-----|----------------|---------------|---|
| 18,5 | 8 | 834 | 30° | X K belt | 619535 | VESPA Primavera 4V 50 4T euro 2 (C532M) VESPA Primavera S 3V iGet 50 ie 4T euro 5 2024-> VESPA Primavera Tech 3V iGet 50 ie 4T euro 5 2024-> VESPA SPRINT 3V iGet 50 ie 4T euro 4 2018->2020 (CA01M) VESPA SPRINT 3V iGet 50 ie 4T euro 5 2021->2023 (CD01M) VESPA Sprint S 3V iGet 50 ie 4T euro 5 2024-> |
| 18,5 | 8 | 834 | 30° | X SPECIAL belt | 619830 | APRILIA SCARABEO CLASSIC 50 2T euro 4 2018-> (CA91M) APRILIA SCARABEO STREET 50 2T (PIAGGIO) APRILIA SCARABEO STREET 50 2T euro 4 2018-> (CA91M) APRILIA SPORTCITY ONE STREET 50 2T euro 2 APRILIA SR MOTARD 50 2T euro 4 2018-> (CA41M) DERBI VARIANT Sport 50 2T GILERA DNA 50 2T LC ITALJET TORPEDO NEW 50 2T PIAGGIO LIBERTY 3V iGet 50 ie 4T euro 3 2016->2017 (C541M) PIAGGIO LIBERTY 3V iGet 50 ie 4T euro 4 2018->2020 (CA11M) PIAGGIO LIBERTY 3V iGet 50 ie 4T euro 5 2021->2024 (CD11M) PIAGGIO LIBERTY 3V iGet 50 ie 4T euro 5 2025-> (CD11M) PIAGGIO LIBERTY 50 2T PIAGGIO LIBERTY S 3V iGet 50 ie 4T euro 5 2025-> (CD11M) PIAGGIO TYPHOON 50 2T euro 2 2011->2017 (C421M) PIAGGIO TYPHOON 50 2T euro 4 2018-> (CA41M) APRILIA SCARABEO CLASSIC 50 2T euro 4 2018-> (CA91M) APRILIA SCARABEO STREET 50 2T (PIAGGIO) APRILIA SCARABEO STREET 50 2T euro 4 2018-> (CA91M) APRILIA SPORTCITY ONE STREET 50 2T euro 2 |

COURROIES

COURROIES - Caractéristiques techniques par ordre de largeur

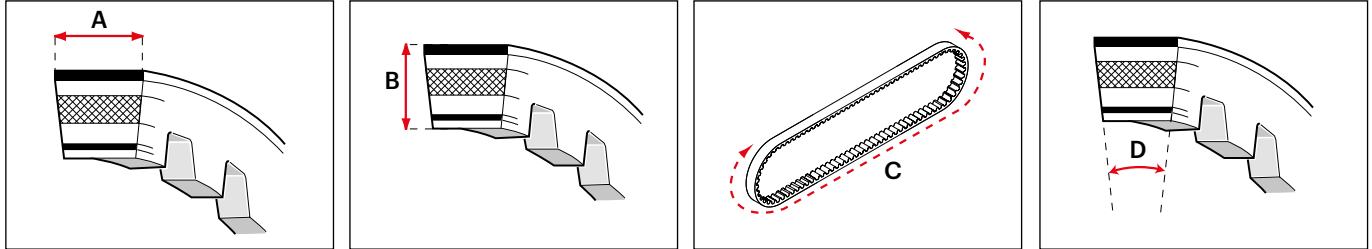

| Largeur mm (A) | Épaisseur mm (B) | Mesure extérieure mm (C) | Angle (D) | Modele | Réf. | Applications |
|----------------|------------------|--------------------------|-----------|--------|------|--------------|
|----------------|------------------|--------------------------|-----------|--------|------|--------------|

| | | | | | | |
|------|------|-----|-----|----------------|----------------|---|
| | | | | | | APRILIA SR MOTARD 50 2T euro 4 2018-> (CA41M) DERBI VARIANT Sport 50 2T GILERA DNA 50 2T LC ITALJET TORPEDO NEW 50 2T PIAGGIO LIBERTY 3V iGet 50 ie 4T euro 3 2016->2017 (C541M) PIAGGIO LIBERTY 3V iGet 50 ie 4T euro 4 2018->2020 (CA11M) PIAGGIO LIBERTY 3V iGet 50 ie 4T euro 5 2021->2024 (CD11M) PIAGGIO LIBERTY 3V iGet 50 ie 4T euro 5 2025-> (CD11M) PIAGGIO LIBERTY 50 2T PIAGGIO LIBERTY S 3V iGet 50 ie 4T euro 5 2025-> (CD11M) PIAGGIO TYPHOON 50 2T euro 2 2011->2017 (C421M) PIAGGIO TYPHOON 50 2T euro 4 2018-> (CA41M) |
| 18,5 | 8,5 | 794 | 30° | X SPECIAL belt | 6116748 | HONDA VISION 110 ie 4T euro 3 2010->2012 (JF31E) |
| 18,7 | 10,2 | 812 | 28° | X K belt | 6115668 | APRILIA MOJITO CUSTOM 50 2T APRILIA SR (carb.) 50 2T LC 2004-> (PIAGGIO) APRILIA SR DITECH GP1 50 2T LC (PIAGGIO C361M) APRILIA SR MOTARD 50 2T euro 2 APRILIA SR R (carb.) 50 2T LC (PIAGGIO) APRILIA SR R 50 2T LC euro 4 2018-> (PIAGGIO CA81M) APRILIA SR R FACTORY 50 2T LC (PIAGGIO C361M) APRILIA SR Street 50 2T LC euro 2 DERBI ATLANTIS - BULLET 50 2T 2003-> DERBI GP1 50 2T LC DERBI GP1 OPEN 50 2T LC DERBI GP1 REVOLUTION 50 2T LC GILERA ICE 50 2T GILERA RUNNER 50 2T LC GILERA RUNNER PureJet 50 2T LC <-2005 GILERA RUNNER PureJet 50 2T LC 2006-> GILERA RUNNER SP 50 2T LC <-2005 GILERA RUNNER SP 50 2T LC 2006-> (C451M) GILERA STALKER 50 2T GILERA STORM 50 2T |

COURROIES

COURROIES - Caractéristiques techniques par ordre de largeur

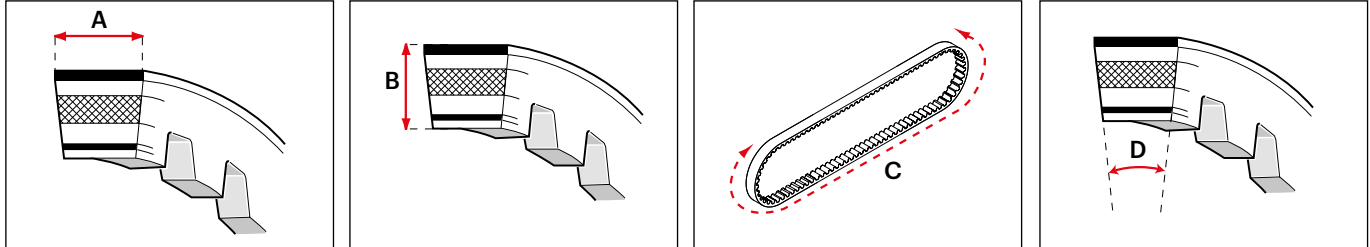

| Largeur mm (A) | Épaisseur mm (B) | Mesure extérieure mm (C) | Angle (D) | Modele | Réf. | Applications |
|----------------|------------------|--------------------------|-----------|--------|------|--------------|
|----------------|------------------|--------------------------|-----------|--------|------|--------------|

GILERA TYPHOON 50 2T
GILERA TYPHOON X 50 2T
ITALJET JET SET 50 2T
PEUGEOT ELYSEO 100 2T
PEUGEOT SPEEDFIGHT 100 2T
PEUGEOT TREKKER 100 2T
PEUGEOT VIVACITY 100 2T
PIAGGIO DIESIS 50 2T
PIAGGIO FLY 50 2T
PIAGGIO NRG 50 2T LC
PIAGGIO NRG EXTREME 50 2T
PIAGGIO NRG EXTREME 50 2T LC
PIAGGIO NRG MC2 50 2T LC <-1997
PIAGGIO NRG MC2 50 2T LC 1998->
PIAGGIO NRG MC3 DD 50 2T LC
PIAGGIO NRG MC3 DT 50 2T
PIAGGIO NRG MC3 Purejet 50 2T LC
PIAGGIO NRG Power 50 2T LC euro 4 2018->2020 (CA71M)
PIAGGIO NRG Power DD 50 2T LC
PIAGGIO NRG Power DT 50 2T (C453M)
PIAGGIO NRG Power Purejet 50 2T LC
PIAGGIO NTT 50 2T LC
PIAGGIO TYPHOON 50 2T 2007->2010
VESPA Primavera 50 2T euro 2 (C533M)
VESPA Sprint 50 2T euro 2

| | | | | | | |
|------|---|-----|-----|----------------|----------------|---|
| 18,7 | 8 | 810 | 30° | X SPECIAL belt | 6116889 | APRILIA MOJITO CUSTOM 50 2T APRILIA SCARABEO 4V 50 4T euro 2 APRILIA SCARABEO 50 4T (PIAGGIO C373M) APRILIA SPORTCITY ONE 50 4T (PIAGGIO C377M) APRILIA SR (carb.) 50 2T LC 2004-> (PIAGGIO) APRILIA SR DITECH GP1 50 2T LC (PIAGGIO C361M) APRILIA SR MOTARD 50 2T euro 2 APRILIA SR R (carb.) 50 2T LC (PIAGGIO) APRILIA SR R 50 2T LC euro 4 2018-> (PIAGGIO CA81M) APRILIA SR R FACTORY 50 2T LC (PIAGGIO C361M) APRILIA SR Street 50 2T LC euro 2 DERBI ATLANTIS - BULLET 50 2T 2003-> DERBI GP1 50 2T LC DERBI GP1 OPEN 50 2T LC DERBI GP1 REVOLUTION 50 2T LC GILERA ICE 50 2T GILERA RUNNER 50 2T LC |
|------|---|-----|-----|----------------|----------------|---|

COURROIES

COURROIES - Caractéristiques techniques par ordre de largeur

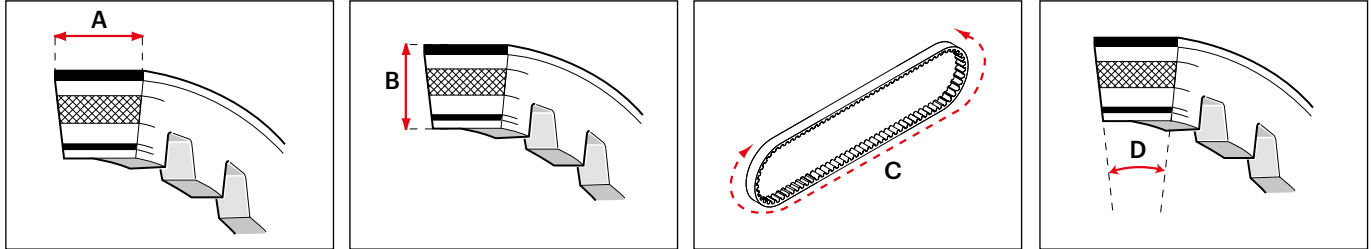

| Largeur mm (A) | Épaisseur mm (B) | Mesure extérieure mm (C) | Angle (D) | Modele | Réf. | Applications |
|----------------|------------------|--------------------------|-----------|--------|------|--------------|
|----------------|------------------|--------------------------|-----------|--------|------|--------------|

| | | | | | | |
|------|------|-----|-----|----------|----------------|--|
| 18,8 | 10,6 | 814 | 28° | X K belt | 6116215 | GILERA RUNNER PureJet 50 2T LC <-2005 GILERA RUNNER PureJet 50 2T LC 2006-> GILERA RUNNER SP 50 2T LC <-2005 GILERA RUNNER SP 50 2T LC 2006-> (C451M) GILERA STALKER 50 2T GILERA TYPHOON X 50 2T ITALJET JET SET 50 2T ITALJET TORPEDO 50 4T MALAGUTI CENTRO 50 4T euro 2 (C432M) MALAGUTI CIAK MASTER 50 4T euro 2 PIAGGIO DIESIS 50 2T PIAGGIO FLY 50 2T PIAGGIO LIBERTY 50 4T PIAGGIO NRG EXTREME 50 2T PIAGGIO NRG EXTREME 50 2T LC PIAGGIO NRG MC2 50 2T LC 1998-> PIAGGIO NRG MC3 DD 50 2T LC PIAGGIO NRG MC3 DT 50 2T PIAGGIO NRG MC3 Purejet 50 2T LC PIAGGIO NRG Power 50 2T LC euro 4 2018->2020 (CA71M) PIAGGIO NRG Power DD 50 2T LC PIAGGIO NRG Power DT 50 2T (C453M) PIAGGIO NRG Power Purejet 50 2T LC PIAGGIO TYPHOON 50 2T 2007->2010 VESPA Primavera 50 2T euro 2 (C533M) VESPA Sprint 50 2T euro 2 |
| 19 | 10,2 | 745 | 28° | X K belt | 6115104 | APRILIA LEONARDO 125 4T LC APRILIA LEONARDO 150 4T LC APRILIA SCARABEO 125 4T LC (ROTAX) APRILIA SCARABEO 150 4T LC (ROTAX) APRILIA SCARABEO 200 4T LC (ROTAX) BETA EIKON 125 4T LC BETA EIKON 150 4T LC KYMCO BET & WIN 125 4T LC KYMCO BET & WIN 150 4T LC KYMCO DINK 125 4T LC euro 0-1-2 KYMCO DINK 150 4T LC euro 0-1-2 KYMCO DINK 200 4T LC (SH 40 A) KYMCO DINK DD 200 ie 4T LC (SJ 40) KYMCO GRAND DINK 125 4T LC euro 0-1-2 KYMCO GRAND DINK 150 4T LC euro 0-1-2 KYMCO YAGER GT 200 ie 4T LC euro 3 (SJ40) MALAGUTI F18 WARRIOR 125 4T LC MALAGUTI F18 WARRIOR 150 4T LC |
| | | | | | | GILERA EASY MOVING 50 2T PIAGGIO QUARTZ 50 2T LC PIAGGIO SFERA RESTYLING 50 2T PIAGGIO ZIP 50 2T 2000-> (C25EM) |

COURROIES

COURROIES - Caractéristiques techniques par ordre de largeur

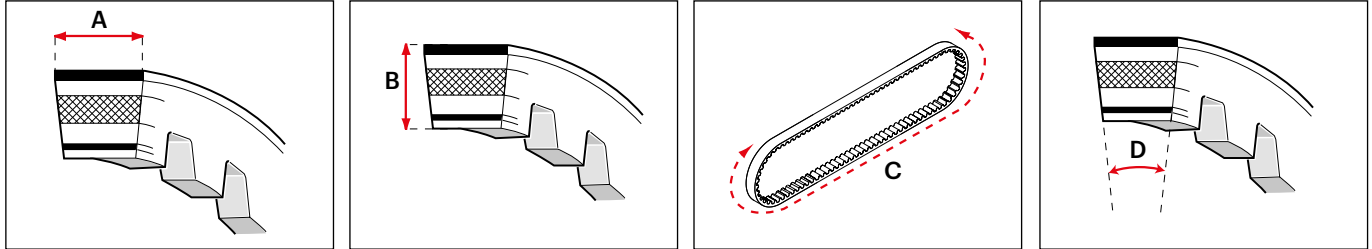

| Largeur mm (A) | Épaisseur mm (B) | Mesure extérieure mm (C) | Angle (D) | Modele | Réf. | Applications |
|----------------|------------------|--------------------------|-----------|----------|----------------|--|
| | | | | | | PIAGGIO ZIP Fast Rider 50 2T PIAGGIO ZIP SP 50 2T LC <-2000 PIAGGIO ZIP SP 50 2T LC 2001-> VESPA ET2 50 2T <-1999 VESPA ET2 50 2T 2000-> VESPA LX 50 2T VESPA S 50 2T euro 2 (C381M) |
| 19 | 8 | 776 | 30° | X K belt | 6116671 | HONDA NSC50R 50 ie 4T euro 2 (AF72E) HONDA VISION 50 ie 4T euro 3 2010->2012 (AF72E) |
| 19 | 9,7 | 939 | 30° | X K belt | 6117451 | SYM HD Evo I 200 ie 4T LC euro 3 (HHA-1) |
| 19,2 | 10 | 833 | 31° | X K belt | 6117452 | SYM JOYRIDE 150 4T LC |
| 19,4 | 10,6 | 834 | 30° | X K belt | 6119431 | APRILIA MOJITO CUSTOM 50 2T APRILIA SR (carb.) 50 2T LC 2004-> (PIAGGIO) APRILIA SR MOTARD 50 2T euro 2 APRILIA SR R (carb.) 50 2T LC (PIAGGIO) APRILIA SR R 50 2T LC euro 4 2018-> (PIAGGIO CA81M) APRILIA SR Street 50 2T LC euro 2 DERBI ATLANTIS - BULLET 50 2T 2003-> DERBI GP1 50 2T LC DERBI GP1 OPEN 50 2T LC DERBI GP1 REVOLUTION 50 2T LC GILERA ICE 50 2T GILERA RUNNER 50 2T LC GILERA RUNNER SP 50 2T LC <-2005 GILERA RUNNER SP 50 2T LC 2006-> (C451M) GILERA STALKER 50 2T GILERA TYPHOON X 50 2T ITALJET JET SET 50 2T PIAGGIO DIESIS 50 2T PIAGGIO FLY 50 2T PIAGGIO FREE 50 2T PIAGGIO NRG EXTREME 50 2T PIAGGIO NRG EXTREME 50 2T LC PIAGGIO NRG MC2 50 2T LC 1998-> PIAGGIO NRG MC3 DD 50 2T LC PIAGGIO NRG MC3 DT 50 2T PIAGGIO NRG Power 50 2T LC euro 4 2018->2020 (CA71M) PIAGGIO NRG Power DD 50 2T LC PIAGGIO NRG Power DT 50 2T (C453M) PIAGGIO TYPHOON 50 2T 2007->2010 VESPA Primavera 50 2T euro 2 (C533M) |

COURROIES

COURROIES - Caractéristiques techniques par ordre de largeur

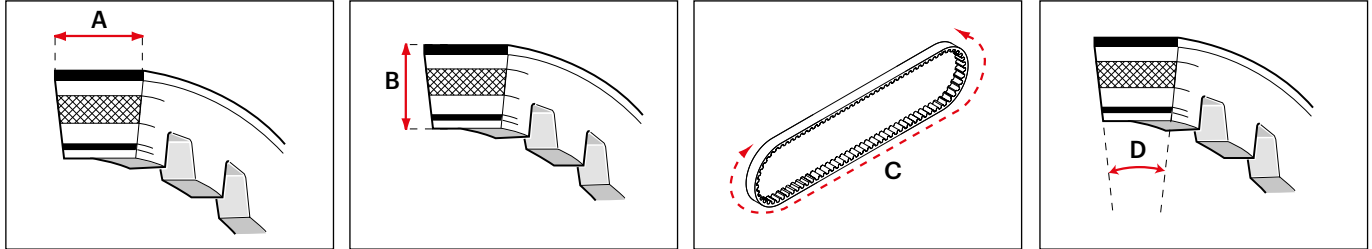

| Largeur mm (A) | Épaisseur mm (B) | Mesure extérieure mm (C) | Angle (D) | Modele | Réf. | Applications |
|----------------------------------|------------------|--------------------------|-----------|----------|----------------|---|
| VESPA Sprint 50 2T euro 2 | | | | | | |
| 19,8 | 9,3 | 806 | 30° | X K belt | 6117453 | SYM EURO MX 125 4T |
| 19,9 | 9,7 | 785 | 30,5° | X K belt | 6116148 | PIAGGIO LIBERTY 3V 125 ie 4T euro 3 PIAGGIO LIBERTY iGet 125 ie 4T euro 3 (M893M) PIAGGIO LIBERTY iGet 125 ie 4T euro 4 2017->2020 PIAGGIO LIBERTY iGet 125 ie 4T euro 5 2021->2024 (MD41M) PIAGGIO LIBERTY iGet 125 ie 4T euro 5+ 2025-> (MD43M) PIAGGIO LIBERTY iGet 150 ie 4T euro 3 PIAGGIO LIBERTY iGet 150 ie 4T euro 4 2017->2020 PIAGGIO LIBERTY S iGet 125 ie 4T euro 4 2017->2020 PIAGGIO LIBERTY S iGet 125 ie 4T euro 5 2021->2024 (MD41M) PIAGGIO LIBERTY S iGet 125 ie 4T euro 5+ 2025-> (MD43M) PIAGGIO LIBERTY S iGet 150 ie 4T euro 4 2017->2020 VESPA Primavera 3V 125 ie 4T euro 3 2014->2015 (M811M) VESPA Primavera Batik iGet 125 ie 4T euro 5+ 2025-> VESPA Primavera iGet 125 ie 4T euro 4 2016->2020 VESPA Primavera iGet 125 ie 4T euro 5 2021->2023 (MD11M) VESPA Primavera iGet 125 ie 4T euro 5+ 2024-> (MD13M) VESPA Primavera RED iGet 125 ie 4T euro 5+ 2025-> VESPA Primavera S iGet 125 ie 4T euro 5+ 2025-> VESPA Primavera Tech iGet 125 ie 4T euro 5+ 2025-> VESPA Sprint 3V 125 ie 4T euro 3 2014->2015 VESPA Sprint iGet 125 ie 4T euro 4 2016->2020 (MA13M) VESPA Sprint iGet 125 ie 4T euro 5 2021->2023 (MD11M) VESPA Sprint S iGet 125 ie 4T euro 5+ 2024-> |

COURROIES

COURROIES - Caractéristiques techniques par ordre de largeur

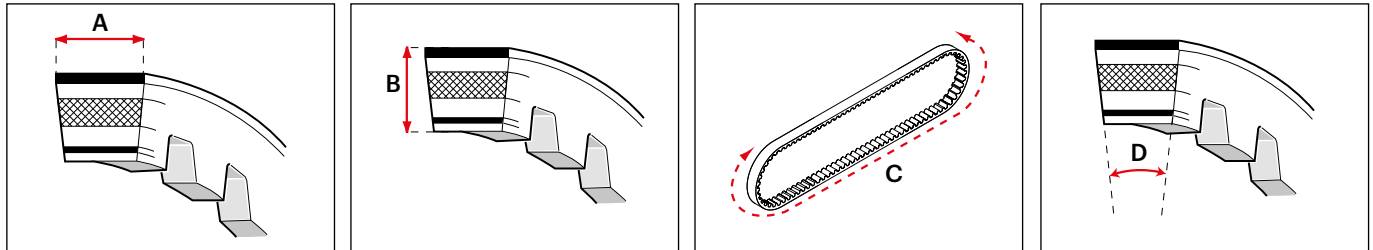

| Largeur mm (A) | Épaisseur mm (B) | Mesure extérieure mm (C) | Angle (D) | Modele | Réf. | Applications |
|----------------|------------------|--------------------------|-----------|----------|----------------|--|
| 20 | 9,5 | 795,5 | 30° | X K belt | 6116665 | KYMC O AGILITY 125 4T euro 3 (KN25) KYMC O AGILITY 150 4T euro 3 KYMC O AGILITY R16 + 125 ie 4T euro 3 2014->2017 (KL25D) KYMC O AGILITY R16 + 125 ie 4T euro 4 2018->2020 (KL25F) KYMC O AGILITY R16 + 125 ie 4T euro 5 2021->(KL25H) KYMC O AGILITY R16 + 150 ie 4T euro 4 2017-> KYMC O AGILITY R16 + 200 ie 4T euro 5 2021-> KYMC O AGILITY R16 125 4T euro 3 (KL25B) KYMC O AGILITY R16 150 4T euro 3 (KL30) KYMC O AGILITY R16 i 200 4T LC euro 3 (KF40-KF40B) KYMC O AGILITY RS 125 4T euro 3 (KN25SR) KYMC O AGILITY S 125 ie 4T euro 5 2022->(TC25B) KYMC O LIKE 125 4T euro 3 (KA40) KYMC O LIKE 200 ie 4T euro 3 (KA40) KYMC O LIKE CBS 125 ie 4T euro 4 2018-> (TE25) KYMC O LIKE CBS 150 ie 4T euro 4 2018-> KYMC O LIKE S 125 ie 4T LC euro 5 2021->(TE25) KYMC O MOVIE 125 4T euro 3 KYMC O PEOPLE - PEOPLE S 125 4T euro 3 KYMC O PEOPLE - PEOPLE S 125 ie 4T euro 4 2018-> (TF25) KYMC O PEOPLE 150 4T KYMC O PEOPLE One 125 ie 4T euro 3 (KM25) KYMC O PEOPLE S 125 ie 4T euro 5 2021->2024 (TF25B) KYMC O PEOPLE S 150 ie 4T euro 4 2018->2020 (TF30) KYMC O PEOPLE S 200 4T euro 3 2006->2016 (BA 40) KYMC O PEOPLE S 200 4T euro 5 2024->(TF40A) KYMC O SUPER 8 125 4T euro 3 (KL25) KYMC O VIVIO 125 4T KYMC O VIVIO 150 4T MALAGUTI CIAK MASTER 125 4T MALAGUTI CIAK MASTER 150 4T MALAGUTI CIAK MASTER 200 4T |
| 20,4 | 9,7 | 884 | 32° | X K belt | 6115275 | KAWASAKI J 125 ie 4T LC euro 3 <-2016 (WS25) |

COURROIES

COURROIES - Caractéristiques techniques par ordre de largeur

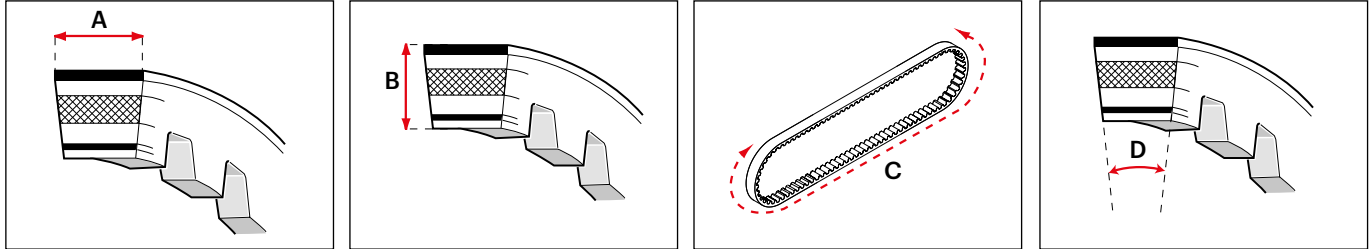

| Largeur mm (A) | Épaisseur mm (B) | Mesure extérieure mm (C) | Angle (D) | Modele | Réf. | Applications |
|----------------|------------------|--------------------------|-----------|--------|------|--------------|
|----------------|------------------|--------------------------|-----------|--------|------|--------------|

| | | | | | | |
|--|--|--|--|--|--|---|
| | | | | | | KAWASAKI J 125 ie 4T LC euro 4 2017-> KYMC O DINK Street 125 ie 4T LC euro 3 (SK25) KYMC O DOWNTOWN 125 ie 4T LC euro 3 <-2016 (SK25) KYMC O DOWNTOWN 125 ie 4T LC euro 4 2017-> (SK25E) KYMC O DT X360 125 ie 4T LC euro 5 2022-> (SK25S) KYMC O GRAND DINK 125 ie 4T LC euro 4 2017-> (KS25A) KYMC O K-XCT 125 ie 4T LC euro 3 KYMC O PEOPLE GTi 125 ie 4T LC euro 3 (BF25) KYMC O SUPER DINK 125 ie 4T LC euro 3 <-2016 (SK25) KYMC O SUPER DINK 125 ie 4T LC euro 4 2017-> (SK25E) KYMC O X-Town 125 ie 4T LC euro 4 <-2020 (KS25A) KYMC O X-Town 125 ie 4T LC euro 5 2021-> (KS25B) KYMC O X-Town CT 125 ie 4T LC euro 4 2020->2021 (KS25C) SYM PHONY ST 200 ie 4T euro 5+ 2025-> |
|--|--|--|--|--|--|---|

| | | | | | | |
|----|----|-----|-----|----------|----------------|---|
| 21 | 13 | 824 | 28° | X K belt | 6115666 | APRILIA ATLANTIC - Arrecife 200 4T LC (PIAGGIO M234M) GILERA DNA 180 4T LC GILERA RUNNER ST 200 4T LC euro 3 GILERA RUNNER VXR 180 4T LC GILERA RUNNER VXR 200 4T LC <-2005 GILERA RUNNER VXR 200 4T LC 2006-> MALAGUTI MADISON 180 4T LC (PIAGGIO) MALAGUTI MADISON 200 4T LC (PIAGGIO) MALAGUTI PHANTOM MAX 200 4T LC (PIAGGIO) PIAGGIO HEXAGON SUPER GTX 180 4T LC PIAGGIO LIBERTY 200 4T euro 3 (LEADER) PIAGGIO LIBERTY S 200 4T euro 3 (LEADER) PIAGGIO TYPHOON - PROTOTIPO Malossi 125 4T LC PIAGGIO X8 200 4T LC PIAGGIO X9 200 4T LC PIAGGIO X9 AMALFI 180 4T LC VESPA Granturismo L - GT 200 4T LC (M312M) |
|----|----|-----|-----|----------|----------------|---|

COURROIES

COURROIES - Caractéristiques techniques par ordre de largeur

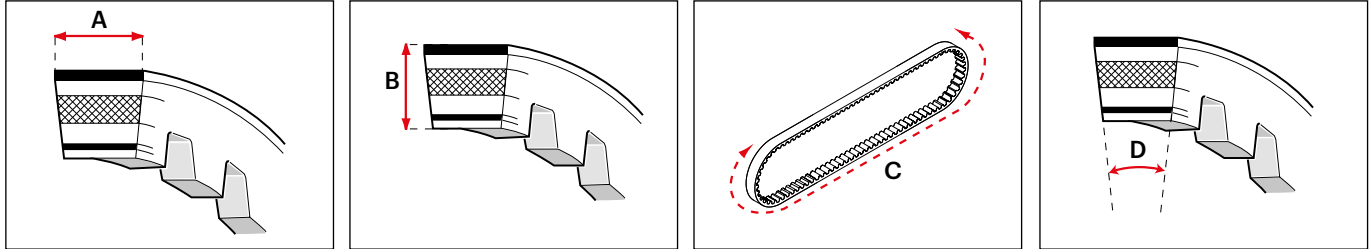

| Largeur mm (A) | Épaisseur mm (B) | Mesure extérieure mm (C) | Angle (D) | Modele | Réf. | Applications |
|----------------|------------------|--------------------------|-----------|----------|----------------|--|
| 21 | 13,4 | 825 | 28° | X K belt | 6120173 | VOGE SFIDA SR3 250 ie 4T LC euro 5 2024-> (LX1P72MM) VOGE SFIDA SR3 250 ie 4T LC euro 5+ 2025-> (LX1P72MM) PIAGGIO MP3 310 ie 4T LC euro 5+ 2025-> (TD11M) PIAGGIO MP3 Sport 310 ie 4T LC euro 5+ 2025-> (TD11M) ROYAL ALLOY GP 350 ie 4T LC euro 5 ROYAL ALLOY GP 350 ie 4T LC euro 5+ 2025-> ROYAL ALLOY TG 350 ie 4T LC euro 5 ROYAL ALLOY TG 350 ie 4T LC euro 5+ 2025-> VESPA GTS 310 ie 4T LC euro 5+ 2025-> (MD38M) VESPA GTS Super 310 ie 4T LC euro 5+ 2025-> (MD38M) VESPA GTS Super Sport 310 ie 4T LC euro 5+ 2025-> (MD38M) VESPA GTS Super Tech 310 ie 4T LC euro 5+ 2025-> (MD38M) |
| 21,8 | 9,3 | 918 | 28° | X K belt | 6113059 | MBK CITYLINER 125 ie 4T LC euro 3 MBK SKYCRUISER 125 ie 4T LC euro 3 YAMAHA X CITY 125 ie 4T LC euro 3 (E3A5E) YAMAHA X MAX 125 ie 4T LC euro 3 <-2008 YAMAHA X MAX 125 ie 4T LC euro 3 2009->2013 YAMAHA X MAX 125 ie 4T LC euro 3 2014->2016 (E3M1E) YAMAHA X MAX 125 ie 4T LC euro 4 2017 (E3V9E) YAMAHA X MAX 125 ie 4T LC euro 4 2018->2020 (E31LE) |
| 22 | 10 | 598 | 28° | X K belt | 6119927 | KYMCO KRV 200 ie 4T LC euro 5 2023-> (SA35AC) KYMCO KRV TYPE S 180 ie 4T LC 2021-> (SA35AC) |
| 22 | 10 | 835 | 30° | X K belt | 6114895 | HONDA PCX 125 ie 4T LC euro 3 <-2011 (JF28E) HONDA PCX 125 ie 4T LC euro 3 2012->2014 (JF47) HONDA PCX 150 ie 4T LC euro 3 2012->2014 (KF12E) |

COURROIES

COURROIES - Caractéristiques techniques par ordre de largeur

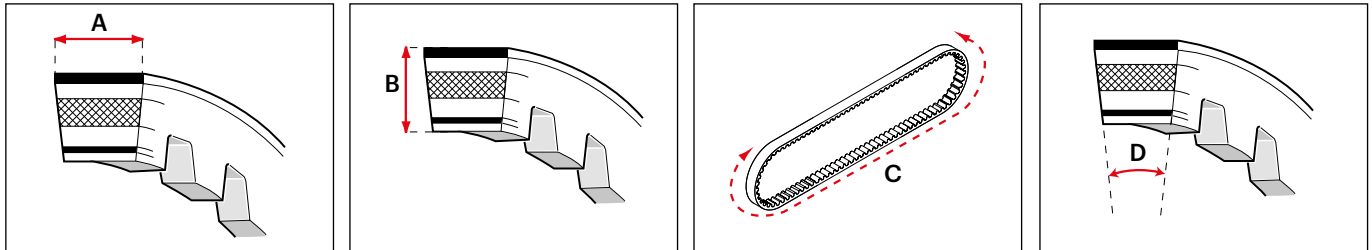

| Largeur mm (A) | Épaisseur mm (B) | Mesure extérieure mm (C) | Angle (D) | Modele | Réf. | Applications |
|----------------|------------------|--------------------------|-----------|----------|----------------|--|
| 22 | 10 | 849 | 30° | X K belt | 6113502 | HONDA SH mode 125 ie 4T LC euro 3 2013->2016 (JF51E) ITALJET DRAGSTER 125 ie 4T LC euro 5 2021-> (JC1P58MI-3) ITALJET DRAGSTER 200 4T LC euro 5 2021-> (JC1P63ML-4B) SUZUKI BURGMAN K 7 125 ie 4T LC euro 3 (F490) |
| 22 | 10,5 | 830 | 28° | X K belt | 6117009 | APRILIA SR 125 2T APRILIA SR 150 2T GILERA RUNNER FX 125 2T LC GILERA RUNNER FXR - SP 180 2T LC GILERA TYPHOON 125 2T GILERA TYPHOON X 125 2T ITALJET DRAGSTER 125 2T LC ITALJET DRAGSTER 180 2T LC PIAGGIO HEXAGON 125 2T LC PIAGGIO HEXAGON 150 2T LC PIAGGIO HEXAGON LX 125 2T LC PIAGGIO HEXAGON LXT 180 2T LC PIAGGIO SKIPPER 125 2T PIAGGIO SKIPPER 150 2T PIAGGIO SKIPPER LX 125 2T PIAGGIO SKIPPER LXT 150 2T |
| 22 | 11,7 | 820 | 28° | X K belt | 6120172 | VESPA Primavera Batik iGet 150 ie 4T euro 5+ 2025-> VESPA Primavera iGet 150 ie 4T euro 5 2021->2023 (MD12M) VESPA Primavera iGet 150 ie 4T euro 5+ 2024-> (MD14M) VESPA Primavera RED iGet 150 ie 4T euro 5+ 2025-> VESPA Primavera S iGet 150 ie 4T euro 5+ 2025-> VESPA Primavera Tech iGet 150 ie 4T euro 5+ 2025-> VESPA Sprint iGet 150 ie 4T euro 5 2021->2023 VESPA Sprint S iGet 150 ie 4T euro 5+ 2024-> |
| 22 | 13 | 945 | 28° | X K belt | 6116697 | APRILIA SPORTCITY 200 4T LC euro 3 (PIAGGIO) PIAGGIO BEVERLY 200 4T LC PIAGGIO CARNABY 200 4T LC euro 3 (LEADER M601M) PIAGGIO CARNABY 300 ie 4T LC euro 3 (QUASAR) |

COURROIES

COURROIES - Caractéristiques techniques par ordre de largeur

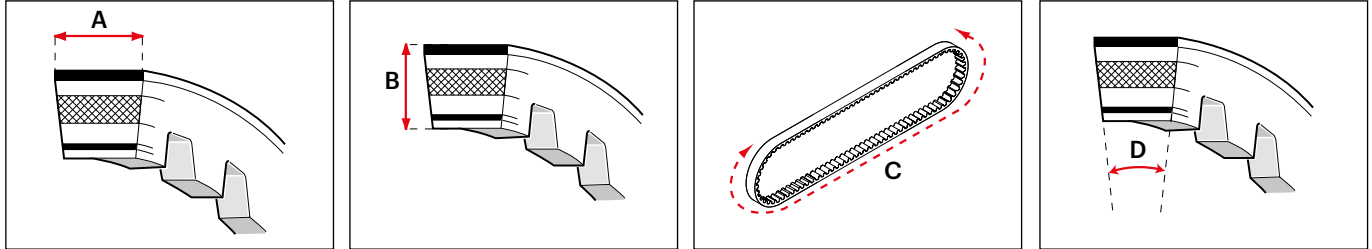

| Largeur mm (A) | Épaisseur mm (B) | Mesure extérieure mm (C) | Angle (D) | Modele | Réf. | Applications |
|----------------|------------------|--------------------------|-----------|----------|----------------|--|
| 22 | 9,3 | 796 | 28° | X K belt | 6116419 | YAMAHA CYGNUS X 125 4T YAMAHA CYGNUS X 125 ie 4T euro 3 |
| 22 | 9,3 | 832 | 28° | X K belt | 6116101 | BENELLI VELVET 125 4T LC BENELLI VELVET 150 4T LC (YAMAHA) ITALJET JUPITER 125 4T LC ITALJET JUPITER 150 4T LC ITALJET MILLENNIUM 125 4T LC ITALJET MILLENNIUM 150 4T LC MALAGUTI MADISON 125 4T LC (YAMAHA) MALAGUTI MADISON 150 4T LC (YAMAHA) MALAGUTI PHANTOM MAX 125 4T LC (YAMAHA) MBK DOODO 125 4T LC MBK DOODO 150 4T LC MBK SKYLINER 125 4T LC MBK SKYLINER 150 4T LC MBK THUNDER 125 4T LC MBK THUNDER 150 4T LC YAMAHA MAJESTY 125 4T LC YAMAHA MAJESTY 150 4T LC YAMAHA MAJESTY 180 4T LC YAMAHA MAXSTER 125 4T LC YAMAHA MAXSTER 150 4T LC YAMAHA TEO'S 125 4T LC YAMAHA TEO'S 150 4T LC |
| 22 | 9,7 | 880 | 28° | X K belt | 6116667 | MBK TRYPTIK 125 ie 4T euro 3 YAMAHA TRICITY 125 ie 4T LC euro 3 <-2016 |
| 22,1 | 10,6 | 825 | 30° | X K belt | 6118204 | HONDA PCX 125 ie 4T LC euro 3 2015->2017 HONDA PCX 150 ie 4T LC euro 3 2015->2017 (KF19E) HONDA VARIO 150 ie 4T LC 2019-> (KF29E) |
| 22,2 | 11 | 888 | 30° | X K belt | 619956 | SUZUKI BURGMAN AN 250 4T LC SUZUKI BURGMAN UH 200 ie 4T LC euro 3 |
| 22,2 | 13 | 825 | 28° | X K belt | 6120066 | ITALJET DRAGSTER 300 ie 4T LC euro 5 2024-> (AZCR) PIAGGIO MP3 HPE 300 ie 4T LC euro 4 2019->2020 (TA21M) PIAGGIO MP3 HPE 300 ie 4T LC euro 5 2021-> (TD21M) PIAGGIO MP3 HPE Sport 300 ie 4T LC euro 5 2021-> (TD21M) VESPA GTS HPE 300 ie 4T LC euro 4 2019->2020 (MA36M) VESPA GTS HPE 300 ie 4T LC euro 5 2021->2022 (MD31M) |

COURROIES

COURROIES - Caractéristiques techniques par ordre de largeur

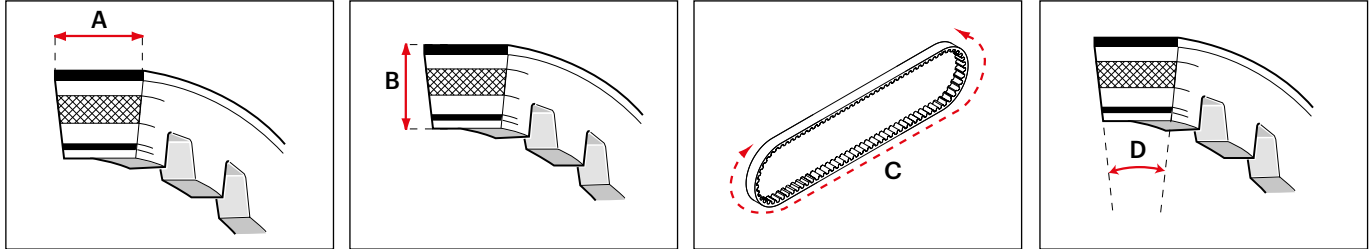

| Largeur mm (A) | Épaisseur mm (B) | Mesure extérieure mm (C) | Angle (D) | Modele | Réf. | Applications |
|----------------|------------------|--------------------------|-----------|--------|------|--------------|
|----------------|------------------|--------------------------|-----------|--------|------|--------------|

| | | | | | | |
|------|------|-----|-----|----------------|----------------|---|
| | | | | | | VESPA GTS HPE 300 ie 4T LC euro 5 2023-> (MD31M) VESPA GTS Super HPE 300 ie 4T LC euro 4 2019->2020 (MA36M) VESPA GTS Super HPE 300 ie 4T LC euro 5 2021->2022 (MD31M) VESPA GTS Super HPE 300 ie 4T LC euro 5 2023-> (MD31M) VESPA GTS Super RACING SIXTIES HPE 300 ie 4T LC euro 5 2021->2022 (MD31M) VESPA GTS Super Sport HPE 300 ie 4T LC euro 4 2019->2020 (MA36M) VESPA GTS Super Sport HPE 300 ie 4T LC euro 5 2021->2022 (MD31M) VESPA GTS Super Sport HPE 300 ie 4T LC euro 5 2023-> VESPA GTS Super Tech HPE 300 ie 4T LC euro 4 2019->2020 (MA36M) VESPA GTS Super Tech HPE 300 ie 4T LC euro 5 2021->2022 (MD31M) VESPA GTS Super Tech HPE 300 ie 4T LC euro 5 2023-> VESPA GTS Touring HPE 300 ie 4T LC euro 4 2019->2020 (MA36M) VESPA GTS Touring HPE 300 ie 4T LC euro 5 2021->2022 (MD31M) VESPA GTV HPE 300 ie 4T LC euro 5 2023-> VESPA SEI GIORNI HPE 300 ie 4T LC euro 4 2019->2020 (MA36M) VESPA SEI GIORNI HPE 300 ie 4T LC euro 5 2021->2022 (MD31M) VESPA SEI GIORNI II EDITION HPE 300 ie 4T LC euro 5 2021->2022 (MD31M) |
| 22,2 | 13,4 | 948 | 28° | X K belt | 6119645 | PIAGGIO BEVERLY 310 ie 4T LC euro 5+ 2025-> (MD23M) PIAGGIO BEVERLY HPE 300 ie 4T LC euro 5 2021-> (MD21M) PIAGGIO BEVERLY S 310 ie 4T LC euro 5+ 2025-> (MD23M) |
| 22,3 | 10,5 | 924 | 30° | X SPECIAL belt | 6114127 | BENELLI CAFFÈNERO 150 4T LC euro 3 (QJ158MJ) CF MOTO URBAN R 150 4T LC (1P 58 MJ) GARELLI XO' 125 ie 4T euro 3 (1P52 QMI-2) GARELLI XO' 150 ie 4T euro 3 (1P58 QMJ) HONDA @ 125 4T LC HONDA @ 150 4T LC |

COURROIES

COURROIES - Caractéristiques techniques par ordre de largeur

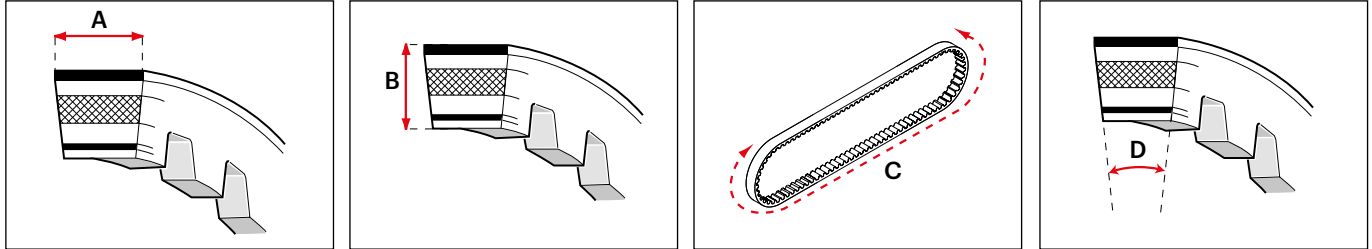

| Largeur mm (A) | Épaisseur mm (B) | Mesure extérieure mm (C) | Angle (D) | Modele | Réf. | Applications |
|----------------|------------------|--------------------------|-----------|--------|------|--------------|
|----------------|------------------|--------------------------|-----------|--------|------|--------------|

HONDA DYLAN 125 4T LC
HONDA DYLAN 150 4T LC
HONDA PANTHEON 125 2T LC
HONDA PANTHEON 125 ie 4T LC
HONDA PANTHEON 150 2T LC
HONDA PANTHEON 150 ie 4T LC
HONDA PS 125 ie 4T LC euro 3
HONDA PS 150 ie 4T LC euro 3
HONDA SH 125 4T LC 2001->2004
HONDA SH 150 4T LC 2001->2004
HONDA SH I 125 ie 4T LC 2005->2008
HONDA SH I 125 ie 4T LC euro 3 2009->2012 (JF14E)
HONDA SH I 150 ie 4T LC 2005->2008
HONDA SH I 150 ie 4T LC euro 3 2009->2012 (KF08E)
HONDA S-Wing 125 ie 4T LC euro 3
HONDA S-Wing 150 ie 4T LC euro 3 (KF06E)
KEEWAY LOGIK 125 4T LC euro 3 (QJ153MI-2)
KEEWAY OUTLOOK 125 4T LC (QJ153MI-2)
KEEWAY OUTLOOK 150 4T LC (QJ158MJ)
MALAGUTI BLOG 125 ie 4T LC euro 3 (03)
MALAGUTI BLOG 160 ie 4T LC euro 3 (04)
MALAGUTI CENTRO 125 ie 4T LC euro 3
MALAGUTI CENTRO 160 ie 4T LC euro 3 (02)
SUZUKI SIXTEEN 125 4T LC euro 3 (F499)
SUZUKI SIXTEEN 150 4T LC euro 3 (G421)
WT MOTORS ATENE 152 4T LC (1P58MJA)

| | | | | | | |
|------|----|-----|-----|----------|---------------|---|
| 22,5 | 10 | 840 | 30° | X K belt | 619584 | HONDA CN 250 4T LC HONDA HELIX 250 4T LC PIAGGIO HEXAGON 250 4T LC |
|------|----|-----|-----|----------|---------------|---|

| | | | | | | |
|------|----|-----|-----|----------|----------------|--|
| 22,5 | 10 | 920 | 30° | X K belt | 6116422 | BENELLI CAFFÈNERO 150 4T LC euro 3 (QJ158MJ) CF MOTO URBAN R 150 4T LC (1P 58 MJ) GARELLI XO' 125 ie 4T euro 3 (1P52 QMI-2) GARELLI XO' 150 ie 4T euro 3 (1P58 QMJ) HONDA @ 125 4T LC HONDA @ 150 4T LC HONDA DYLAN 125 4T LC HONDA DYLAN 150 4T LC HONDA PANTHEON 125 2T LC HONDA PANTHEON 125 ie 4T LC HONDA PANTHEON 150 2T LC HONDA PANTHEON 150 ie 4T LC HONDA PS 125 ie 4T LC euro 3 HONDA PS 150 ie 4T LC euro 3 HONDA SH 125 4T LC 2001->2004 HONDA SH 150 4T LC 2001->2004 |
|------|----|-----|-----|----------|----------------|--|

COURROIES

COURROIES - Caractéristiques techniques par ordre de largeur

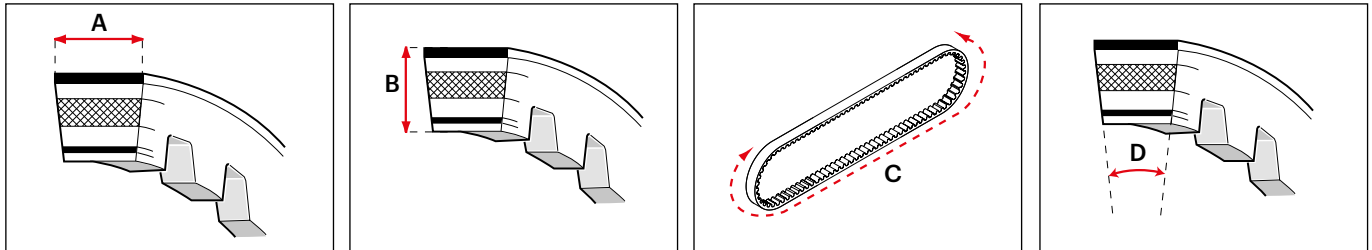

| Largeur mm (A) | Épaisseur mm (B) | Mesure extérieure mm (C) | Angle (D) | Modele | Réf. | Applications |
|----------------|------------------|--------------------------|-----------|--------|------|--------------|
|----------------|------------------|--------------------------|-----------|--------|------|--------------|

| | | | | | | |
|------|------|-----|-----|----------|----------------|---|
| 22,5 | 10,5 | 814 | 30° | X K belt | 6116117 | HONDA SH I 125 ie 4T LC 2005->2008 HONDA SH I 125 ie 4T LC euro 3 2009->2012 (JF14E) HONDA SH I 150 ie 4T LC 2005->2008 HONDA SH I 150 ie 4T LC euro 3 2009->2012 (KF08E) HONDA S-Wing 125 ie 4T LC euro 3 HONDA S-Wing 150 ie 4T LC euro 3 (KF06E) KEEWAY LOGIK 125 4T LC euro 3 (QJ153MI-2) KEEWAY OUTLOOK 125 4T LC (QJ153MI-2) KEEWAY OUTLOOK 150 4T LC (QJ158MJ) MALAGUTI BLOG 125 ie 4T LC euro 3 (03) MALAGUTI BLOG 160 ie 4T LC euro 3 (04) MALAGUTI CENTRO 125 ie 4T LC euro 3 MALAGUTI CENTRO 160 ie 4T LC euro 3 (02) SUZUKI SIXTEEN 125 4T LC euro 3 (F499) SUZUKI SIXTEEN 150 4T LC euro 3 (G421) WT MOTORS ATENE 152 4T LC (1P58MJA) |
| | | | | | | APRILIA ATLANTIC - Arrecife 125 4T LC APRILIA MOJITO RY 125 4T (LEADER) APRILIA SPORTCITY ONE 125 4T (LEADER M38AM) APRILIA SR MAX 125 ie 4T LC euro 3 2011->2014 (M357M) APRILIA SR MOTARD 125 4T euro 3 BENELLI ADIVA 125 4T (LEADER) BENELLI ADIVA 150 4T (LEADER) DERBI BOULEVARD 125 4T (LEADER) DERBI BOULEVARD 150 4T (LEADER) DERBI GP1 125 4T LC euro 2-3 DERBI VARIANT Sport 125 4T GILERA DNA 125 4T LC GILERA NEXUS 125 4T LC euro 3 2007->2008 (M355M) GILERA NEXUS 125 ie 4T LC euro 3 2008->2010 (M357M) GILERA RUNNER ST 125 4T LC euro 3 GILERA RUNNER VX 125 4T LC <-2005 GILERA RUNNER VX 125 4T LC 2006-> ITALJET JET SET 125 4T (LEADER) ITALJET JET SET 150 4T (LEADER) ITALJET TORPEDO 125 4T (LEADER) ITALJET TORPEDO 150 4T (LEADER) MALAGUTI MADISON 3 125 4T LC (PIAGGIO) PIAGGIO FLY 125 4T euro 2-3 2006->2007 (LEADER M422M) PIAGGIO FLY 150 4T euro 2-3 2006->2007 (LEADER M422M) |

COURROIES

COURROIES - Caractéristiques techniques par ordre de largeur

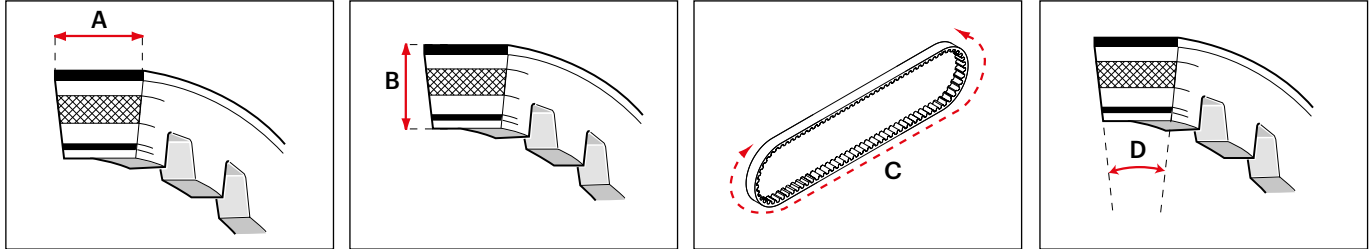

| Largeur mm (A) | Épaisseur mm (B) | Mesure extérieure mm (C) | Angle (D) | Modele | Réf. | Applications |
|----------------|------------------|--------------------------|-----------|--------|------|--------------|
|----------------|------------------|--------------------------|-----------|--------|------|--------------|

PIAGGIO HEXAGON SUPER GTX 125 4T LC
PIAGGIO LIBERTY 125 4T euro 1-2 (LEADER)
PIAGGIO LIBERTY 125 4T euro 3 (LEADER M389M)
PIAGGIO LIBERTY 150 4T euro 1-2 (LEADER)
PIAGGIO LIBERTY 150 4T euro 3 2009->2013 (LEADER M672M)
PIAGGIO LIBERTY 3V 150 ie 4T euro 3 (M738M)
PIAGGIO LIBERTY iGet 150 ie 4T euro 5 2021->2024 (MD42M)
PIAGGIO LIBERTY iGet 150 ie 4T euro 5+ 2025-> (MD44M)
PIAGGIO LIBERTY LE 125 4T euro 1-2 (LEADER)
PIAGGIO LIBERTY LE 150 4T euro 1-2 (LEADER)
PIAGGIO LIBERTY S 125 4T euro 3 (LEADER M381M)
PIAGGIO LIBERTY S iGet 150 ie 4T euro 5 2021->2024 (MD42M)
PIAGGIO LIBERTY S iGet 150 ie 4T euro 5+ 2025-> (MD44M)
PIAGGIO MP3 125 4T LC euro 3 (LEADER)
PIAGGIO NEW FLY 3V 125 ie 4T euro 3 2012->2015 (M793M)
PIAGGIO SKIPPER ST 125 4T (LEADER)
PIAGGIO SKIPPER ST 150 4T (LEADER)
PIAGGIO TYPHOON 125 4T euro 3 (LEADER M701M)
PIAGGIO X7 125 4T LC euro 3 (LEADER)
PIAGGIO X7 EVO 125 ie 4T LC euro 3 2009->2010 (QUASAR M623M)
PIAGGIO X8 125 4T LC euro 2-3 (LEADER)
PIAGGIO X9 4V 125 4T LC
PIAGGIO X9 4V Evolution 125 4T LC euro 2-3
PIAGGIO XEvo 125 4T LC euro 3 (LEADER)
PIAGGIO ZIP 125 4T (LEADER)
RENAULT FULLTIME 125 4T (LEADER)
VESPA 946 3V ABS 125 ie 4T 2013-> (M801M)
VESPA ET4 125 4T (LEADER)
VESPA ET4 150 4T (LEADER)
VESPA Granturismo L - GT 125 4T LC (LEADER)
VESPA GTS 125 4T LC euro 3 <-2013 (M315M)
VESPA GTS Super 125 ie 4T LC euro 3 <-2013 (M455M)

COURROIES

COURROIES - Caractéristiques techniques par ordre de largeur

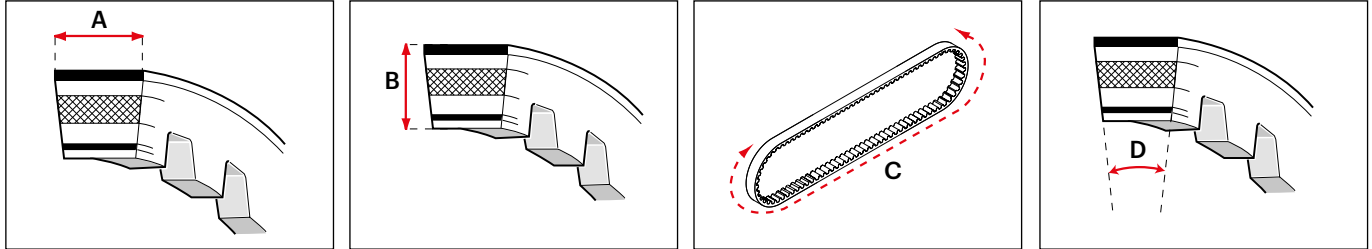

| Largeur mm (A) | Épaisseur mm (B) | Mesure extérieure mm (C) | Angle (D) | Modele | Réf. | Applications |
|----------------|------------------|--------------------------|-----------|--------|------|--------------|
|----------------|------------------|--------------------------|-----------|--------|------|--------------|

| | | | | | | |
|------|------|------|-----|----------|----------------|--|
| 22,5 | 10,5 | 937 | 30° | X K belt | 611618 | VESPA GTS Super 125 ie 4T LC euro 3 2014->2016 (M455M) VESPA GTV 125 4T LC (LEADER) VESPA LX 125 4T euro 2 2006->2007 (LEADER M441M) VESPA LX 125 ie 4T euro 3 2007->2011 (LEADER M443M) VESPA LX 150 4T (LEADER) VESPA LX 150 ie 4T euro 3 (LEADER) VESPA LX 3V 125 ie 4T euro 3 2012-> (M687M) VESPA LX 3V 150 ie 4T euro 3 2012-> (M688M) VESPA LXV 125 ie 4T euro 3 (LEADER) VESPA Primavera 3V 150 ie 4T euro 3 2014->2015 (M812M) VESPA Primavera iGet 150 ie 4T euro 4 2016->2020 (MA12M) VESPA S 125 4T euro 3 2001->2007 (LEADER M444M) VESPA S 150 4T euro 3 2007->2011 (LEADER M445M) VESPA S 3V 125 ie 4T euro 3 2012-> VESPA Sprint 3V 150 ie 4T euro 3 2014-> VESPA Sprint iGet 150 ie 4T euro 4 2016->2020 APRILIA SCARABEO 125 4T LC (PIAGGIO) APRILIA SPORTCITY 125 4T LC euro 2 (PIAGGIO M281M) DERBI RAMBLA 125 4T LC euro 3 (PIAGGIO M287M) PIAGGIO BEVERLY 125 4T LC <-2009 PIAGGIO BEVERLY 125 ie 4T LC euro 3 2010->2015 (QUASAR M691M) PIAGGIO CARNABY 125 4T LC euro 3 (LEADER M28FM) PIAGGIO MP3 YOURBAN 4V 125 ie 4T LC euro 3 2011->2013 (M711M) PIAGGIO X10 125 ie 4T LC euro 3 2010->2015 (M761M) WT MOTORS MIAMI 250 4T LC (172MM) |
| 22,5 | 11 | 1008 | 30° | X K belt | 6112714 | MALAGUTI PassWord CK 250 4T LC MBK EVOLIS 250 ie 4T LC 2014-> MBK KILIBRE 300 4T LC (H314E) YAMAHA VERSITY XC 300 4T LC (H314E) YAMAHA X CITY 250 ie 4T LC euro 3 (G358E) |

COURROIES

COURROIES - Caractéristiques techniques par ordre de largeur

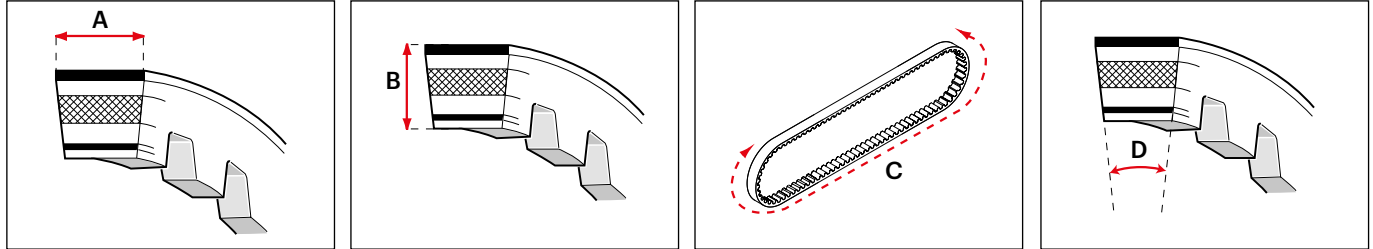

| Largeur mm (A) | Épaisseur mm (B) | Mesure extérieure mm (C) | Angle (D) | Modele | Réf. | Applications |
|----------------|------------------|--------------------------|-----------|----------------|----------------|---|
| 22,6 | 10,6 | 845 | 30° | X SPECIAL belt | 6118634 | YAMAHA X CITY 250 ie 4T LC euro 3 2014->(G3B7E) YAMAHA X MAX 250 4T LC YAMAHA X MAX 250 ie 4T LC euro 3 2008->2009 (G362E) YAMAHA X MAX 250 ie 4T LC euro 3 2010->2013 (G389E) YAMAHA X MAX 250 ie 4T LC euro 3 2014->2017 (G3B3E) HONDA ADV 150 ie 4T LC 2020->2022 (KF39E) HONDA PCX 125 ie 4T LC euro 4 2018->2020 (JF64E) HONDA PCX 150 ie 4T LC euro 4 2018-> HONDA SH mode 125 ie 4T LC euro 4 2017->2020 KYMCO DINK X 125 ie 4T LC euro 5+ 2025->(KA25W) VOGE SFIDA SR1 125 ie 4T LC euro 5 2023->2024 (LC1P52MI) VOGE SFIDA SR1 125 ie 4T LC euro 5+ 2025->(LC1P52MI) VOGE SFIDA SR1 ADV 125 ie 4T LC euro 5 <-2024 (LC1P52MI) VOGE SFIDA SR1 ADV 125 ie 4T LC euro 5+ 2025-> (LC1P52MI) VOGE SFIDA SR16 125 ie 4T LC euro 5+ 2025->(LC1P52MI) |
| 22,6 | 13 | 834 | 28° | X K belt | 6113027 | APRILIA ATLANTIC - Arrecife 250 4T LC (PIAGGIO M237M) APRILIA SR MAX 300 ie 4T LC euro 3 DERBI GP1 250 4T LC euro 2-3 GILERA NEXUS 250 ie 4T LC euro 3 GILERA NEXUS 300 ie 4T LC euro 3 MALAGUTI MADISON 3 250 4T LC (PIAGGIO) MALAGUTI MADISON RS 250 4T LC (PIAGGIO M237M) MALAGUTI PHANTOM MAX 250 4T LC (PIAGGIO M361M) PEUGEOT SATELIS 250 4T LC euro 3 PIAGGIO MP3 250 ie 4T LC euro 3 (QUASAR M472M) PIAGGIO MP3 300 ie 4T LC euro 3 2009->2014 (QUASAR M634M) PIAGGIO MP3 300 ie 4T LC euro 3 2014->2016 (M862M) |

COURROIES

COURROIES - Caractéristiques techniques par ordre de largeur

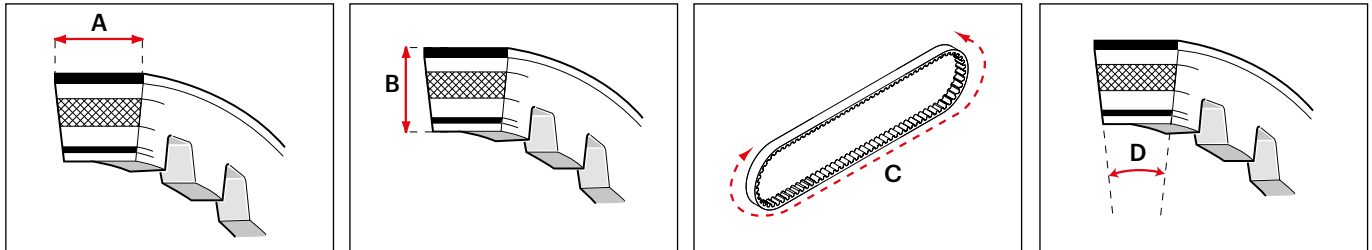

| Largeur mm (A) | Épaisseur mm (B) | Mesure extérieure mm (C) | Angle (D) | Modele | Réf. | Applications |
|----------------|------------------|--------------------------|-----------|--------|------|--------------|
|----------------|------------------|--------------------------|-----------|--------|------|--------------|

| | | | | | | |
|------|----|-----|-----|----------|----------------|---|
| 22,6 | 13 | 955 | 28° | X K belt | 6116069 | <p>PIAGGIO MP3 300 ie 4T LC euro 4 2016->2018 (TA11M) PIAGGIO MP3 YOURBAN 4V 300 ie 4T LC euro 3 2011->2016 PIAGGIO MP3 YOURBAN SPORT 4V 300 ie 4T LC euro 4 2017->2018 PIAGGIO X7 250 ie 4T LC euro 3 (QUASAR M622M) PIAGGIO X7 EVO 300 ie 4T LC euro 3 (QUASAR) PIAGGIO X8 250 4T LC euro 2 PIAGGIO X8 250 ie 4T LC euro 3 (QUASAR) PIAGGIO X9 Evolution 250 4T LC (M237M) PIAGGIO XEvo 250 ie 4T LC euro 3 (QUASAR) ROYAL ALLOY GP 300 LC euro 4 VESPA GTS 250 ie 4T LC VESPA GTS 300 ie 4T LC euro 4 2017->2018 (MA33M) VESPA GTS Super 300 ie 4T LC euro 3 <-2013 (QUASAR M454M) VESPA GTS Super 300 ie 4T LC euro 3 2014->2016 (QUASAR M454M) VESPA GTS Super 300 ie 4T LC euro 4 2017->2018 (QUASAR M458M-M45EM) VESPA GTV 250 ie 4T LC VESPA GTV 300 ie 4T LC euro 3 (QUASAR) VESPA SEI GIORNI 300 ie 4T LC euro 4 2018-></p> <p>APRILIA SCARABEO 250 4T LC (PIAGGIO M285M) APRILIA SCARABEO Light 250 ie 4T LC 2007-> APRILIA SCARABEO Special 300 ie 4T LC euro 3 (PIAGGIO M28RM) APRILIA SPORTCITY 250 ie 4T LC euro 3 (PIAGGIO M288M) APRILIA SPORTCITY CUBE 300 ie 4T LC euro 3 (LEADER M28LM) DERBI RAMBLA 250 ie 4T LC euro 3 DERBI RAMBLA i 300 ie 4T LC euro 3 (PIAGGIO) PEUGEOT GEOPOLIS 250 ie 4T LC euro 3 PEUGEOT GEOPOLIS R/GT 300 ie 4T LC euro 3 PEUGEOT GeoRS 300 ie 4T LC euro 3 (PIAGGIO M28MM)</p> |
|------|----|-----|-----|----------|----------------|---|

COURROIES

COURROIES - Caractéristiques techniques par ordre de largeur

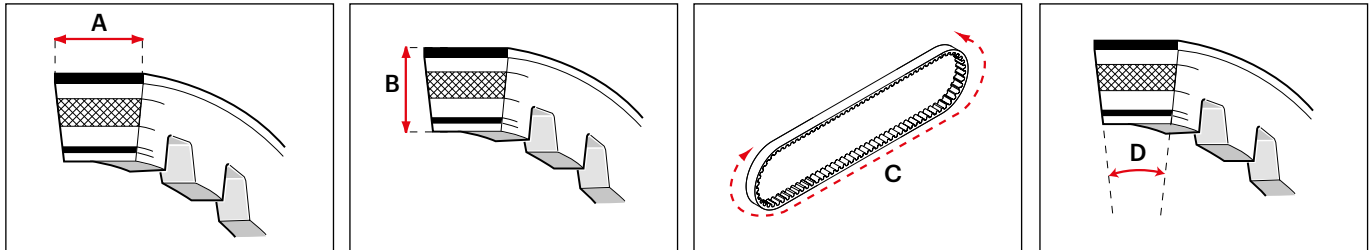

| Largeur mm (A) | Épaisseur mm (B) | Mesure extérieure mm (C) | Angle (D) | Modele | Réf. | Applications |
|----------------|------------------|--------------------------|-----------|----------------|----------------|---|
| 22,7 | 10,5 | 931 | 28° | X SPECIAL belt | 6115676 | PIAGGIO BEVERLY 250 4T LC euro 1-2 (M285M) PIAGGIO BEVERLY 250 ie 4T LC euro 3 PIAGGIO BEVERLY 300 ie 4T LC euro 3 <-2009 (M28MM) PIAGGIO BEVERLY 300 ie 4T LC euro 3 2010->2016 (M692M) PIAGGIO BEVERLY 300 ie 4T LC euro 4 2017->2020 (MA21M) PIAGGIO BEVERLY S 250 ie 4T LC euro 3 PIAGGIO BEVERLY TOURER 300 ie 4T LC euro 3 |
| 23 | 11,4 | 871 | 28° | X K belt | 6116094 | HONDA FORZA 125 ie 4T LC euro 3 <-2016 (JF60E) HONDA FORZA 125 ie 4T LC euro 4 2017->2020 (JF69E) HONDA SH I 125 ie 4T LC euro 3 2013->2016 (JF41E) HONDA SH i 125 ie 4T LC euro 4 2017->2019 (JFG8E) HONDA SH i 150 ie 4T LC euro 3 2013->2016 (KF13E) HONDA SH i 150 ie 4T LC euro 4 2017->2019 |
| 23 | 14,8 | 947 | 28° | X K belt | 6112713 | SUZUKI BURGMAN AN - Business 400 4T LC <-2007 SUZUKI BURGMAN AN 400 ie 4T LC <-2007 (K429) |
| 23,2 | 10,5 | 949,5 | 30° | X K belt | 6116421 | HONDA FORESIGHT 250 4T LC HONDA FORZA 250 4T LC 2001-> HONDA JAZZ 250 4T LC 2001-> HONDA REFLEX 250 4T LC 2001-> PEUGEOT SV 250 4T LC PIAGGIO X9 250 4T LC (HONDA) |
| 23,2 | 11,6 | 864,3 | 28° | X K belt | 6119482 | HONDA PCX 125 ie 4T LC euro 5 2021->2024 (JK05E) HONDA PCX 125 ie 4T LC euro 5+ 2025-> (JK05E) |

COURROIES

COURROIES - Caractéristiques techniques par ordre de largeur

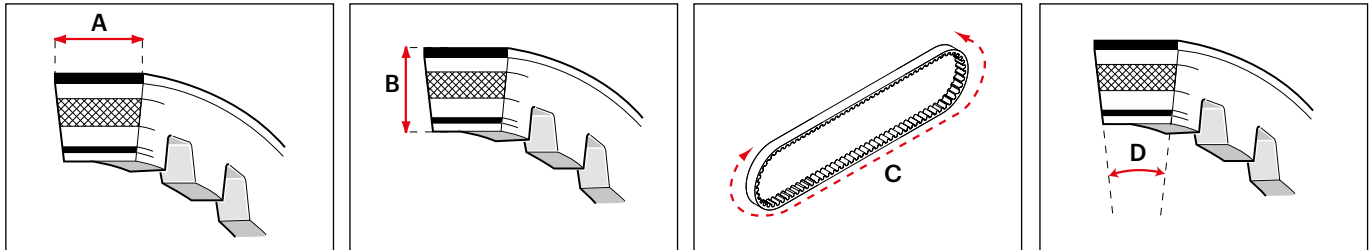

| Largeur mm (A) | Épaisseur mm (B) | Mesure extérieure mm (C) | Angle (D) | Modele | Réf. | Applications |
|----------------|------------------|--------------------------|-----------|----------|----------------|---|
| 23,4 | 11,7 | 822,5 | 28° | X K belt | 6117478 | APRILIA SR GT 125 ie 4T LC euro 5 2022->2024 (MD51M) APRILIA SR GT 125 ie 4T LC euro 5+ 2025-> APRILIA SR GT 200 ie 4T LC euro 5 2023->2024 (MD52M) APRILIA SR GT 200 ie 4T LC euro 5+ 2025-> APRILIA SR GT Sport 125 ie 4T LC euro 5 2022->2024 (MD51M) APRILIA SR GT Sport 125 ie 4T LC euro 5+ 2025-> APRILIA SR GT Sport 200 ie 4T LC euro 5 2022->2024 APRILIA SR GT Sport 200 ie 4T LC euro 5+ 2025-> PIAGGIO MEDLEY 125 ie 4T LC euro 4 2016->2019 (MA01M) PIAGGIO MEDLEY 125 ie 4T LC euro 4 2020->(MB01M) PIAGGIO MEDLEY 125 ie 4T LC euro 5 2021->2024 (MD01M) PIAGGIO MEDLEY 125 ie 4T LC euro 5+ 2025->(MD03M) PIAGGIO MEDLEY 150 ie 4T LC euro 4 2016->2019 PIAGGIO MEDLEY 150 ie 4T LC euro 4 2020-> PIAGGIO MEDLEY 150 ie 4T LC euro 5 2021->2024 (MD02M) PIAGGIO MEDLEY 200 ie 4T LC euro 5+ 2025-> PIAGGIO MEDLEY S 125 ie 4T LC euro 4 2020->(MB01M) PIAGGIO MEDLEY S 125 ie 4T LC euro 5 2021->2024 (MD01M) PIAGGIO MEDLEY S 125 ie 4T LC euro 5+ 2025->(MD03M) PIAGGIO MEDLEY S 150 ie 4T LC euro 4 2020-> PIAGGIO MEDLEY S 150 ie 4T LC euro 5 2021->2024 (MD02M) PIAGGIO MEDLEY S 200 ie 4T LC euro 5+ 2025-> VESPA GTS 125 ie 4T LC euro 4 2017->2020 VESPA GTS 125 ie 4T LC euro 5 2021->2022 VESPA GTS 125 ie 4T LC euro 5 2023->2024 VESPA GTS 150 ie 4T LC euro 4 2017->2020 VESPA GTS Super 125 ie 4T LC euro 4 2017->2020 |

COURROIES

COURROIES - Caractéristiques techniques par ordre de largeur

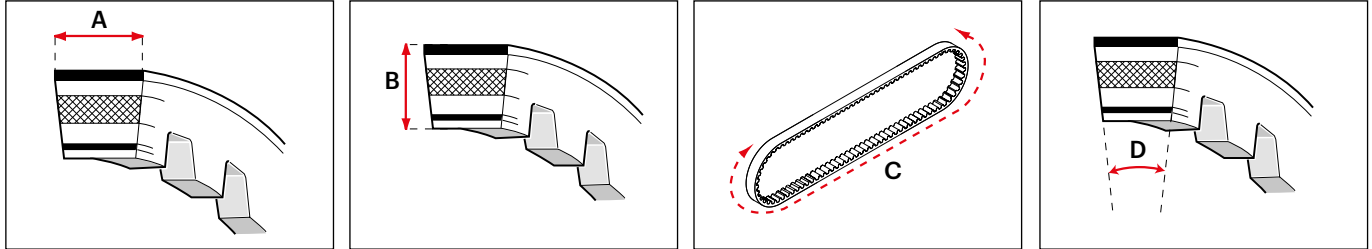

| Largeur mm (A) | Épaisseur mm (B) | Mesure extérieure mm (C) | Angle (D) | Modele | Réf. | Applications |
|----------------|------------------|--------------------------|-----------|----------|----------------|--|
| 23,7 | 14,7 | 1004 | 30° | X K belt | 6115277 | VESPA GTS Super 125 ie 4T LC euro 5 2021->2022 VESPA GTS Super 125 ie 4T LC euro 5 2023->2024 VESPA GTS Super 150 ie 4T LC euro 4 2017->2020 VESPA GTS Super Sport 125 ie 4T LC euro 5 2023->2024 VESPA GTS Super Tech 125 ie 4T LC euro 5 2023->2024 KAWASAKI J 300 ie 4T LC euro 3 (WS60) KAWASAKI J 300 ie 4T LC euro 4 2018->(WS60B) KYMC0 AGILITY S 350 ie 4T LC euro 5 2024->(KS64B) KYMC0 DINK Street 300 ie 4T LC euro 3 (SK60) KYMC0 DINK Street 300 ie 4T LC euro 3 2012-> (SK60A) KYMC0 DOWNTOWN 300 ie 4T LC euro 3 (SK60) KYMC0 DOWNTOWN 300 ie 4T LC euro 3 2012-> (SK60A) KYMC0 DOWNTOWN GT 350 ie 4T LC euro 5+ 2024-> KYMC0 DOWNTOWN i ABS 350 ie 4T LC euro 3 (SK64) KYMC0 DOWNTOWN i ABS 350 ie 4T LC euro 4 2016->2020 (SK64G) KYMC0 DOWNTOWN i ABS 350 ie 4T LC euro 5 2021-> (SK64H) KYMC0 DT X360 350 ie 4T LC euro 5 2021->2024 (SK64D) KYMC0 DT X360 350 ie 4T LC euro 5+ 2025-> (SK64K) KYMC0 K-XCT 300 ie 4T LC euro 3 (SK60B) KYMC0 NIKITA 300 ie 4T LC euro 3 KYMC0 PEOPLE GTi 300 ie 4T LC euro 3 <-2018 (BF60) KYMC0 PEOPLE GTi 300 ie 4T LC euro 4 2019-> (BF60B) KYMC0 PEOPLE S 300 ie 4T LC euro 4 2019-> (BF60C) KYMC0 SUPER DINK 300 ie 4T LC euro 3 (SK60) |

COURROIES

COURROIES - Caractéristiques techniques par ordre de largeur

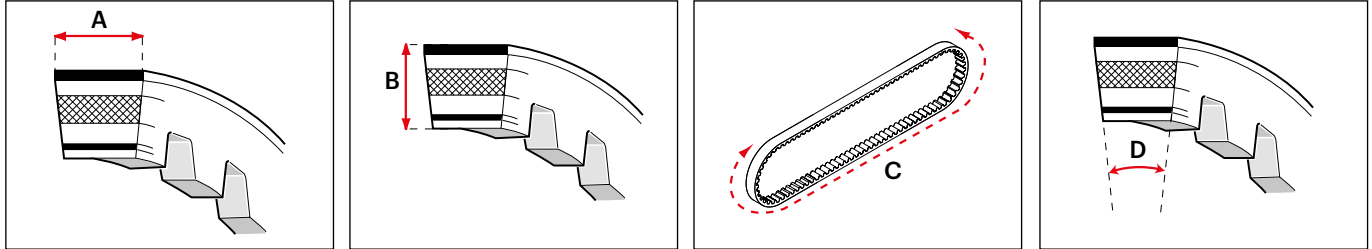

| Largeur mm (A) | Épaisseur mm (B) | Mesure extérieure mm (C) | Angle (D) | Modele | Réf. | Applications |
|----------------|------------------|--------------------------|-----------|----------------|----------------|--|
| 24 | 10,2 | 987 | 30° | X K belt | 6115276 | KYMCO SUPER DINK 300 ie 4T LC euro 3 2012-> (SK60A) KYMCO SUPER DINK 350 ie 4T LC euro 4 2017-> (SK64G) SYM HD 300 ie 4T LC euro 5 2022-> (MC953215) SYM JOYRIDE 16 300 ie 4T LC euro 5 2022->2024 (XS1P75MN-2) SYM JOYRIDE 16 300 ie 4T LC euro 5+ 2025-> |
| 24 | 10,5 | 912 | 30° | X K belt | 6116568 | KYMCO DINK Street 200 ie 4T LC euro 3 (SK40) KYMCO DOWNTOWN 200 ie 4T LC euro 3 (SK40) KYMCO NIKITA 200 ie 4T LC euro 3 KYMCO PEOPLE GTi 200 ie 4T LC euro 3 (BF40) KYMCO SUPER DINK 200 ie 4T LC euro 3 (SK40) |
| 24 | 10,6 | 952 | 30° | X SPECIAL belt | 6118987 | HONDA SH i 125 ie 4T LC euro 5 2020->2023 (JF90E) HONDA SH i 125 ie 4T LC euro 5+ 2024-> (JF90E) HONDA SH i 150 ie 4T LC euro 5 2020->2023 HONDA SH I 150 ie 4T LC euro 5+ 2024-> (KF40E) |
| 24 | 11,4 | 995 | 32° | X K belt | 6113028 | KYMCO AGILITY 300 ie 4T LC euro 4 2020-> (KS60A) KYMCO GRAND DINK 300 ie 4T LC euro 4 2017-> (KS60A) KYMCO PEOPLE - PEOPLE S 250 4T LC euro 2 KYMCO PEOPLE - PEOPLE S 250 ie 4T LC euro 3 KYMCO PEOPLE S 300 ie 4T LC euro 3 <-2018 (BB60) KYMCO XCITING - XCITING R 300 ie 4T LC euro 3 KYMCO XCITING 250 4T LC euro 2 KYMCO X-Town 300 ie 4T LC euro 4 2016->2020 (KS60A) |

COURROIES

COURROIES - Caractéristiques techniques par ordre de largeur

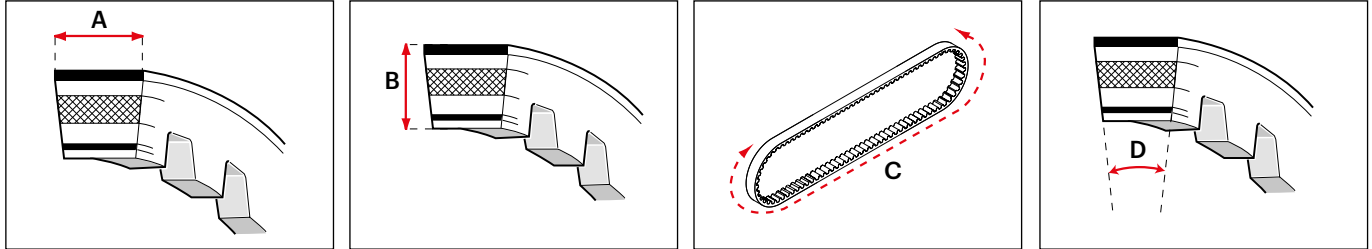

| Largeur mm (A) | Épaisseur mm (B) | Mesure extérieure mm (C) | Angle (D) | Modele | Réf. | Applications |
|----------------|------------------|--------------------------|-----------|----------|----------------|--|
| | | | | | | KYMCO X-Town 300 ie 4T LC euro 5 2021->2024 (KS60F) KYMCO X-Town 300 ie 4T LC euro 5+ 2025-> (KS60F) KYMCO X-Town CT 300 ie 4T LC euro 5 2021-> (KS60J) |
| 24 | 15 | 1041 | 30° | X K belt | 6113021 | BENELLI VELVET DUSK 400 4T LC MALAGUTI MADISON K 400 4T LC |
| 24,4 | 10,6 | 924 | 30° | X K belt | 6117205 | SYM JOYMAX I 250 ie 4T LC euro 3 (HMA-1) |
| 24,5 | 10,5 | 888 | 31° | X K belt | 6120274 | YAMAHA X MAX 125 ie 4T LC euro 5 2021->2022 (E33FE) |
| 24,9 | 14,6 | 974 | 28° | X K belt | 6117832 | YAMAHA TRICITY 300 ie 4T LC euro 4 2020 YAMAHA TRICITY 300 ie 4T LC euro 5 2021-> YAMAHA X MAX 250 ie 4T LC 2021-> APAC YAMAHA X MAX 300 ie 4T LC euro 4 2017->2020 (H336E) YAMAHA X MAX 300 ie 4T LC euro 5 2021->2022 YAMAHA X MAX 300 ie 4T LC euro 5 2023->2024 (H348E) YAMAHA X MAX 300 ie 4T LC euro 5+ 2025-> (H353E) YAMAHA X MAX Tech MAX 300 ie 4T LC euro 5 2021->2022 YAMAHA X MAX Tech MAX 300 ie 4T LC euro 5 2023->2024 (H348E) YAMAHA X MAX Tech MAX 300 ie 4T LC euro 5+ 2025-> (H353E) YAMAHA X MAX Tech MAX+ 300 ie 4T LC euro 5+ 2025-> (H353E) |
| 25 | 13,6 | 1093 | 28° | X K belt | 6115279 | PIAGGIO BEVERLY HPE 400 ie 4T LC euro 5 2021->2024 (MD22M) PIAGGIO BEVERLY HPE 400 ie 4T LC euro 5+ 2025-> (MD24M) PIAGGIO BEVERLY S HPE 400 ie 4T LC euro 5+ 2025-> (MD24M) PIAGGIO BEVERLY Sport Touring 350 ie 4T LC euro 3 <-2016 (M693M) PIAGGIO BEVERLY Sport Touring 350 ie 4T LC euro 4 2017-> PIAGGIO MP3 350 ie 4T LC euro 4 2018-> (TA14M) PIAGGIO MP3 Sport 400 ie 4T LC euro 5 2021->2024 |

COURROIES

COURROIES - Caractéristiques techniques par ordre de largeur

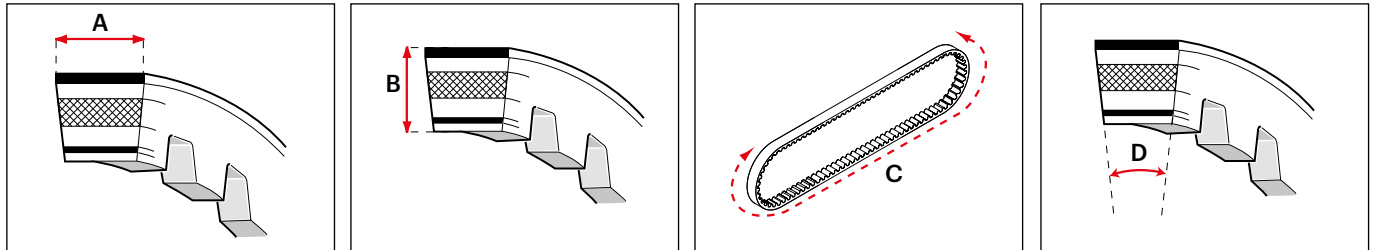

| Largeur mm (A) | Épaisseur mm (B) | Mesure extérieure mm (C) | Angle (D) | Modele | Réf. | Applications |
|----------------|------------------|--------------------------|-----------|----------------|----------------|--|
| 25,5 | 10,5 | 902 | 31° | X SPECIAL belt | 6117244 | PIAGGIO MP3 Sport 400 ie 4T LC euro 5+ 2025-> PIAGGIO X10 350 ie 4T LC euro 3 (M762M) MBK OCITO 125 ie 4T euro 3 YAMAHA AEROX 155 ie 4T LC 2017-> YAMAHA BW'S 125 ie 4T LC euro 4 2019-> YAMAHA CYGNUS GRYPHUS 125 ie 4T LC euro 4 2019-> YAMAHA N MAX 125 ie 4T LC euro 3 <-2016 (E3S3E) YAMAHA N MAX 125 ie 4T LC euro 4 2017->2020 (E3X7E) YAMAHA N MAX 155 ie 4T LC euro 3 <-2016 YAMAHA N MAX 155 ie 4T LC euro 4 2017-> YAMAHA NVX 155 ie 4T LC euro 4 2017-> YAMAHA TRICITY 125 ie 4T LC euro 4 2017-> (E3V8E) YAMAHA TRICITY 155 ie 4T LC euro 4 2017-> (G3H3E) |
| 25,7 | 13,6 | 1007 | 28° | X K belt | 6119157 | BMW C 400 GT ie 4T LC euro 4 2019->2020 BMW C 400 GT ie 4T LC euro 5 2021->2024 BMW C 400 GT ie 4T LC euro 5+ 2025-> BMW C 400 X ie 4T LC euro 4 2019->2020 BMW C 400 X ie 4T LC euro 5 2021->2024 BMW C 400 X ie 4T LC euro 5+ 2025-> VOGE SFIDA SR4 400 ie 4T LC euro 5 2023-> (LX1P8OMP) VOGE SFIDA SR4 MAX 400 ie 4T LC euro 5 2023-> (LX1P8OMP) |
| 26,2 | 10,5 | 969 | 31° | X K belt | 6115278 | YAMAHA MAJESTY S 125 ie 4T LC YAMAHA SMax 125 ie 4T LC YAMAHA SMax 160 ie 4T LC YAMAHA Xenter 125 ie 4T LC euro 3 <-2018 YAMAHA Xenter 125 ie 4T LC euro 4 2018-> YAMAHA Xenter 150 ie 4T LC euro 3 <-2018 (G397E) YAMAHA Xenter 150 ie 4T LC euro 4 2018-> |
| 26,25 | 14,5 | 1012 | 28° | X K belt | 6113396 | SUZUKI BURGMAN AN 400 ie 4T LC 2007->2009 SUZUKI BURGMAN AN 400 ie 4T LC euro 3 2010->2016 SUZUKI BURGMAN AN 400 ie 4T LC euro 4 2017->2020 (K432) SUZUKI BURGMAN AN 400 ie 4T LC euro 5 2021-> (K432) |

COURROIES

COURROIES - Caractéristiques techniques par ordre de largeur

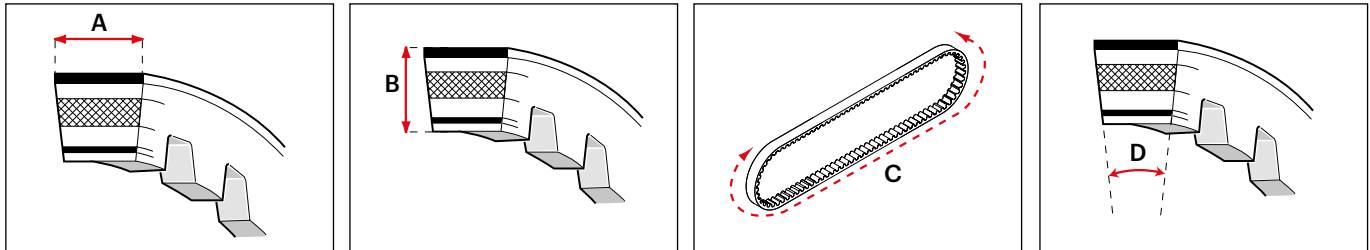

| Largeur mm (A) | Épaisseur mm (B) | Mesure extérieure mm (C) | Angle (D) | Modele | Réf. | Applications |
|----------------|------------------|--------------------------|-----------|----------|----------------|---|
| | | | | | | ZONTES 368D ie 4T LC euro 5+ 2025-> (ZT1P79MP) ZONTES 368E ie 4T LC euro 5+ 2025-> (ZT1P79MP) ZONTES 368G ie 4T LC euro 5+ 2025-> (ZT1P79MP) |
| 26,4 | 13 | 1026 | 32° | X K belt | 6113590 | HONDA FORZA 300 ie 4T LC euro 3 <-2017 (NF04E) HONDA FORZA 300 ie 4T LC euro 4 2018->2020 (NF07E) HONDA SH I 300 ie 4T LC euro 2 <-2010 (NF02E) HONDA SH I 300 ie 4T LC euro 3 2011->2014 (NF02E) HONDA SH I 300 ie 4T LC euro 4 2015->2017 (NF05E) HONDA SH I 300 ie 4T LC euro 4 2018-> |
| 26,5 | 14,4 | 1244 | 30° | X K belt | 6113500 | HONDA SILVER WING 400 4T LC HONDA SW-T 400 4T LC euro 3 (NF01E) |
| 26,5 | 14,4 | 1262 | 30° | X K belt | 6115803 | HONDA SILVER WING 600 4T LC |
| 27,8 | 14,7 | 1036 | 28° | X K belt | 6116100 | KYMCO XCITING 500 4T LC euro 2-3 KYMCO XCITING R 500 ie 4T LC euro 3 (SB AO) |
| 28,1 | 13,3 | 1062 | 33° | X K belt | 6118984 | HONDA ADV 350 ie 4T LC euro 5 2021->2024 (NF13E) HONDA ADV 350 ie 4T LC euro 5+ 2025-> (NF13E) HONDA FORZA 350 ie 4T LC euro 5 2021->2024 (NF09E) HONDA FORZA 350 ie 4T LC euro 5+ 2025-> (NF09E) HONDA SH I 350 ie 4T LC euro 5 2021->2022 (NF11E) HONDA SH I 350 ie 4T LC euro 5 2023->2024 (NF11E) HONDA SH I 350 ie 4T LC euro 5+ 2025-> |
| 28,4 | 15,6 | 1030 | 28° | X K belt | 6119797 | PIAGGIO MP3 ABS HPE 530 ie 4T LC euro 5 2022->2024 (TD31M) PIAGGIO MP3 Exclusive 530 ie 4T LC euro 5 2022->2024 (TD31M) PIAGGIO MP3 Exclusive 530 ie 4T LC euro 5+ 2025-> (TD31M) |
| 28,7 | 16 | 1044 | 28° | X K belt | 6115125 | APRILIA ATLANTIC SPRINT - Arrecife 400 4T LC (PIAGGIO M348M) |

COURROIES

COURROIES - Caractéristiques techniques par ordre de largeur

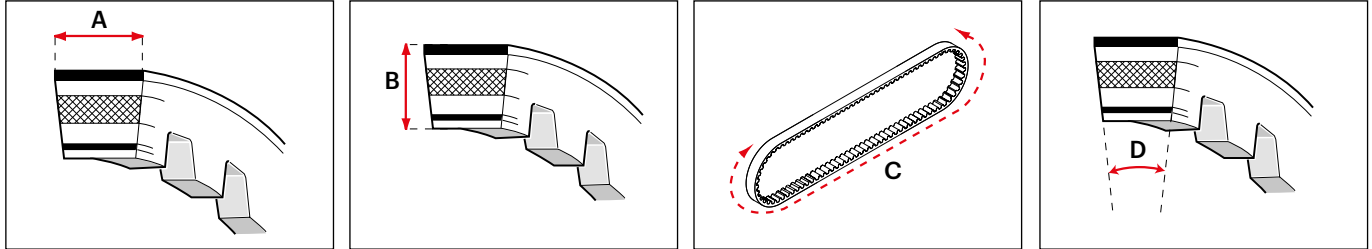

| Largeur mm (A) | Épaisseur mm (B) | Mesure extérieure mm (C) | Angle (D) | Modele | Réf. | Applications |
|----------------|------------------|--------------------------|-----------|--------|------|--------------|
|----------------|------------------|--------------------------|-----------|--------|------|--------------|

| | | | | | | |
|----|------|------|-----|----------|----------------|---|
| 30 | 14,7 | 1018 | 26° | X K belt | 6116079 | <p>APRILIA SCARABEO 400 ie 4T LC 2007-> APRILIA SCARABEO Light 400 ie 4T LC 2007-> APRILIA SCARABEO Light 500 ie 4T LC 2007-> (M343M) GILERA FUOCO 500 ie 4T LC euro 3 GILERA NEXUS 500 ie 4T LC euro 2-3 MALAGUTI SPIDERMAX GT 500 4T LC (PIAGGIO M341M) PEUGEOT GEOPOLIS 400 4T LC euro 3 PEUGEOT SATELIS 400 4T LC euro 3 <-2014 (PIAGGIO) PEUGEOT SATELIS 500 4T LC euro 3 PGO BUG RACER 500 4T LC (PIAGGIO) PIAGGIO BEVERLY 400 ie 4T LC euro 3 (M345M) PIAGGIO BEVERLY 500 ie 4T LC euro 2-3 PIAGGIO BEVERLY CRUISER 500 ie 4T LC euro 3 PIAGGIO BEVERLY TOURER 400 ie 4T LC euro 3 (M345M) PIAGGIO MP3 400 ie 4T LC euro 3 (MASTER M474M) PIAGGIO MP3 500 ie 4T LC euro 3 PIAGGIO MP3 500 ie 4T LC euro 4 2017-> PIAGGIO MP3 HPE Business ABS ASR 500 ie 4T LC euro 4 2020-> PIAGGIO MP3 HPE Sport ABS ASR 500 ie 4T LC euro 4 2020-> PIAGGIO MP3 HPE Sport Advanced 500 ie 4T LC euro 4 2020-> PIAGGIO X10 500 ie 4T LC euro 3 PIAGGIO X8 400 ie 4T LC euro 3 (M521M) PIAGGIO X9 Evolution - Street 500 4T LC PIAGGIO XEvo 400 ie 4T LC euro 3 (M521M)</p> <p>KYMCO XCITING 400 ie 4T LC euro 3 (SK80) KYMCO XCITING 400 ie 4T LC euro 4 (SK80B) KYMCO XCITING 400i S 400 ie 4T LC euro 4 2018->2020 (SK80C) KYMCO XCITING 400i S 400 ie 4T LC euro 5 2021-> (SK80D) KYMCO XCITING VS 400 ie 4T LC euro 5 2023->2024 (SK80E) KYMCO XCITING VS 400 ie 4T LC euro 5+ 2025-></p> |
|----|------|------|-----|----------|----------------|---|

COURROIES

COURROIES - Caractéristiques techniques par ordre de largeur

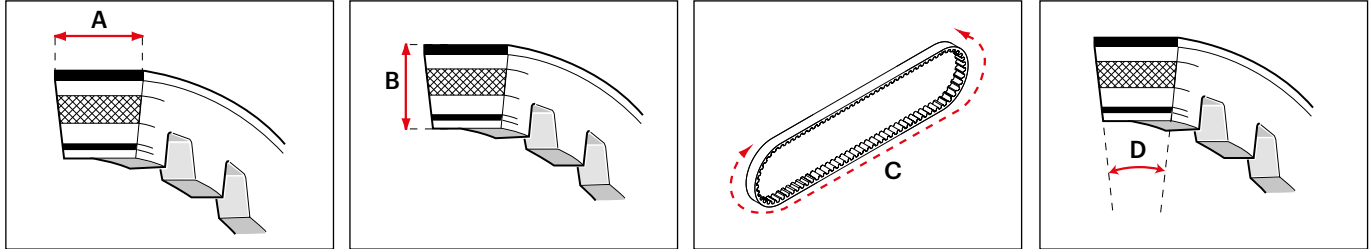

| Largeur mm (A) | Épaisseur mm (B) | Mesure extérieure mm (C) | Angle (D) | Modele | Réf. | Applications |
|----------------|------------------|--------------------------|-----------|----------|----------------|---|
| 30 | 15 | 912 | 26° | X K belt | 6112960 | YAMAHA MAJESTY 400 4T LC <-2008 (H317E) |
| 30,1 | 14,7 | 931 | 28° | X K belt | 6115280 | MBK EVOLIS 400 ie 4T LC YAMAHA MAJESTY 400 4T LC euro 3 2009->(H322E) YAMAHA X MAX 400 ie 4T LC euro 3 <-2016 (H330E) YAMAHA X MAX 400 ie 4T LC euro 4 2017->2019 (H340E) YAMAHA X MAX Tech MAX 400 ie 4T LC euro 4 2019->2021 (H340E) |
| 31 | 14,9 | 892 | 28° | X K belt | 6114674 | YAMAHA T MAX (carb.) 500 4T LC 2001->2003 YAMAHA T MAX 500 ie 4T LC 2004->2007 YAMAHA T MAX 500 ie 4T LC 2008->2011 |
| 31 | 16,9 | 894 | 28° | X K belt | 6115687 | BMW C 600 Sport ie 4T LC euro 3 <-2015 BMW C 650 GT ie 4T LC euro 3 <-2015 BMW C 650 GT ie 4T LC euro 4 2016-> BMW C 650 Sport ie 4T LC euro 4 2016->(652EA) |
| 31,2 | 16 | 908 | 28° | X K belt | 6116011 | YAMAHA T MAX 530 ie 4T LC 2012->2014 (J409E) YAMAHA T MAX 530 ie 4T LC 2015->2016 (J409E) |
| 31,5 | 16,9 | 945 | 28° | X K belt | 6115126 | APRILIA SRV 850 ie 4T LC euro 3 (PIAGGIO M554M) GILERA GP 800 4T LC (PIAGGIO M554M) |
| 32,2 | 14,9 | 908 | 28° | X K belt | 6118071 | KYMCO AK 550 ie 4T LC euro 4 2017->2020 (SAA1) KYMCO AK 550 ie 4T LC euro 5 2021-> (SBA1) KYMCO AK Premium 550 ie 4T LC euro 5 2023-> (SBA1B) YAMAHA T MAX 530 ie 4T LC euro 4 2017->(J415E) YAMAHA T MAX 560 ie 4T LC euro 5 2020->2021 (J420E) YAMAHA T MAX 560 ie 4T LC euro 5 2022->2024 YAMAHA T MAX 560 ie 4T LC euro 5+ 2025->(J421E) YAMAHA T MAX DX 530 ie 4T LC euro 4 2017->(J415E) YAMAHA T MAX SX 530 ie 4T LC euro 4 2017->(J415E) |

COURROIES

COURROIES - Caractéristiques techniques par ordre de largeur

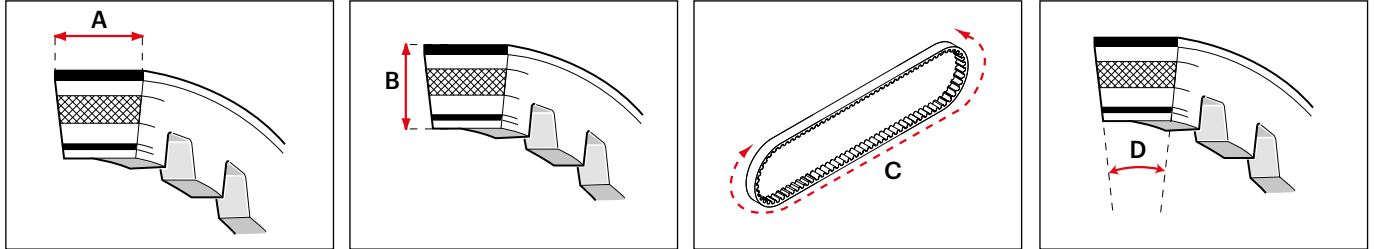

| Largeur mm (A) | Épaisseur mm (B) | Mesure extérieure mm (C) | Angle (D) | Modele | Réf. | Applications |
|----------------|------------------|--------------------------|-----------|--------|------|--------------|
|----------------|------------------|--------------------------|-----------|--------|------|--------------|

YAMAHA T MAX Tech MAX 560 ie 4T LC euro 5 2020->2021 (J420E)
YAMAHA T MAX Tech MAX 560 ie 4T LC euro 5 2022->2024
YAMAHA T MAX Tech MAX 560 ie 4T LC euro 5+ 2025-> (J421E)