

# A01141 - 1141 CARB. PHVA 12 PS

## FICHE DE PIÈCES DÉTACHÉES CARBURATEUR

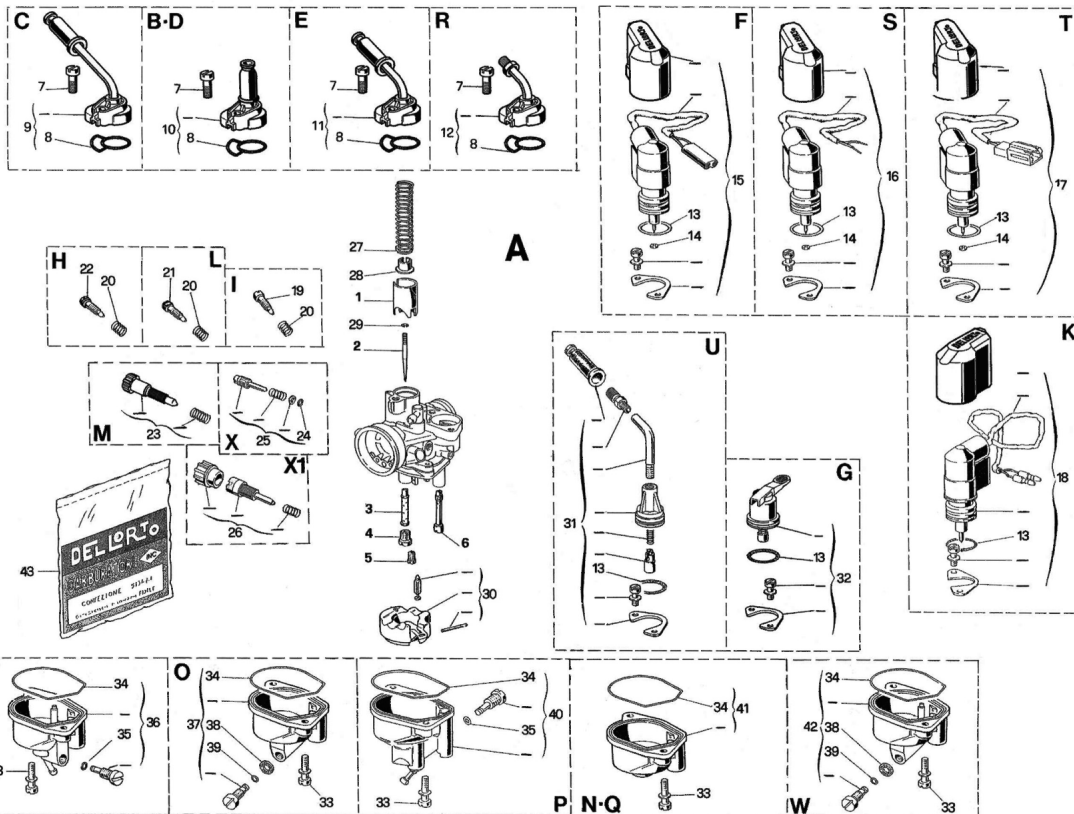

| N° | Référence         | Description                           | Qté |
|----|-------------------|---------------------------------------|-----|
| 0  | <b>A01141</b>     | 1141 CARB. PHVA 12 PS                 | 1   |
| 1  | <b>B15249.040</b> | 15249 BOISSEAU GAZ 40                 | 1   |
| 2  | <b>B13680.012</b> | 13680 AIGUILLE CONIQUE A 12           | 1   |
| 3  | <b>B14671.211</b> | 14671 ATOMISEUR GA 211                | 1   |
| 4  | <b>B06413.865</b> | GICLEUR                               | 1   |
| 5  | <b>B11600.038</b> | 11600 GICLEUR 38                      | 1   |
| 6  | <b>B15280.048</b> | 15280 GICLEUR 48                      | 1   |
| 7  | <b>B07526</b>     | 7526 VIS                              | 1   |
| 17 | <b>B53081</b>     | 53081 KIT STARTER AUTOM. PHVA         | 1   |
| 20 | <b>B01411</b>     | 1411 RESSORT                          | 1   |
| 21 | <b>B14740</b>     | 14740 VIS                             | 1   |
| 23 | <b>B53029</b>     | 53029 KIT VIS REG. BOISSEAU GAZ PHVA  | 1   |
| 25 | <b>B53086</b>     | 53086 KIT VIS REG. BOISSEAU GAZ       | 1   |
| 26 | <b>B53072</b>     | 53072 KIT VIS BOISSEAU PHVA           | 1   |
| 27 | <b>B15058</b>     | 15058 RESSORT                         | 1   |
| 28 | <b>B13687</b>     | 13687 CLIP                            | 1   |
| 29 | <b>B13681</b>     | 13681 ARRET                           | 1   |
| 30 | <b>B53053</b>     | 53053 KIT FLOTTEUR PHVA-PHBN          | 1   |
| 33 | <b>B13709</b>     | 13709 VIS                             | 2   |
| 36 | <b>B14699</b>     | 14699 CUVE                            | 1   |
| 43 | <b>B52622</b>     | 52622 KIT JOINTS PHVA...B-C-D-E-G-H-L | 1   |

