

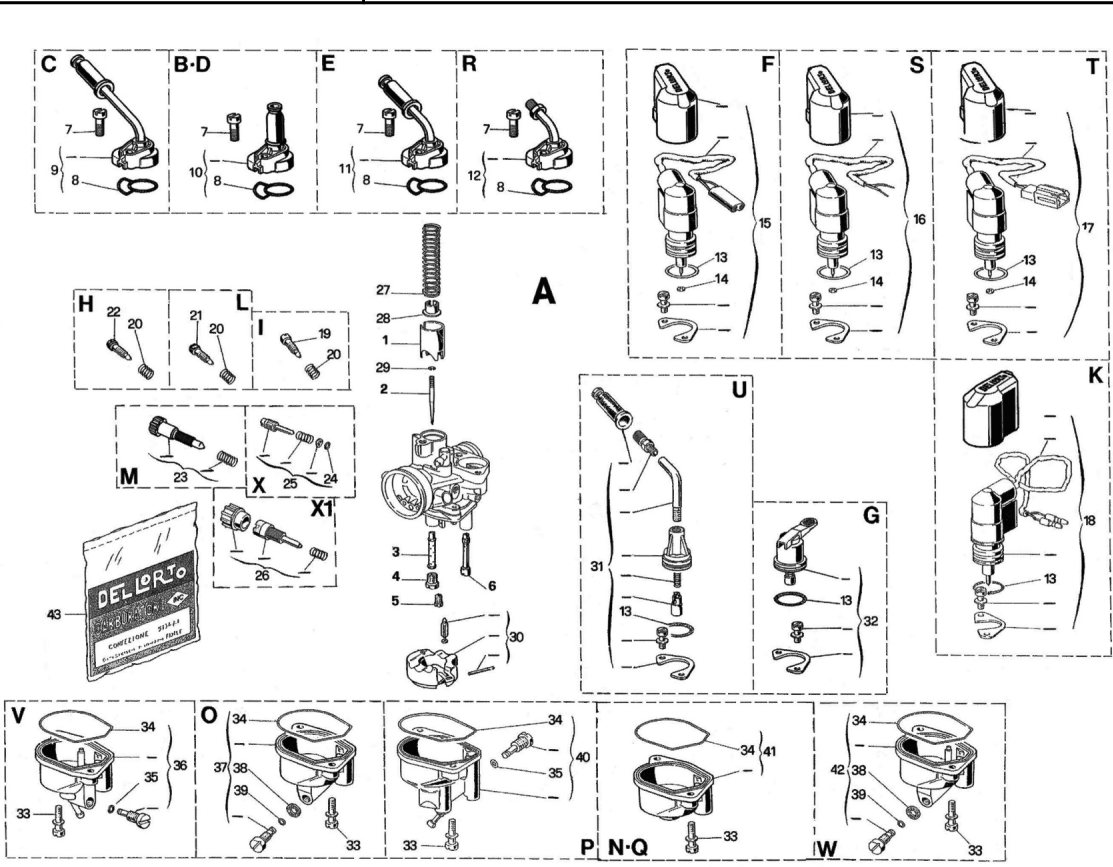

A01391 - 1391 CARB. PHVA 12 PS

CARBURETOR SPARE PARTS FILE



| N° | Part Number | Description | Qty |
|----|-------------------|---------------------------------------|-----|
| 0 | A01391 | 1391 CARB. PHVA 12 PS | 1 |
| 1 | B15249.040 | 15249 SLIDE 40 | 1 |
| 2 | B13680.020 | 13680 CONICAL NEEDLE A 20 | 1 |
| 3 | B14671.211 | 14671 NEEDLE JET GA 211 | 1 |
| 4 | B06413.074 | 6413 MAIN JET 74 | 1 |
| 5 | B11600.038 | 11600 JET 38 | 1 |
| 6 | B15280.048 | 15280 JET 48 | 1 |
| 7 | B07526 | 7526 SCREW | 1 |
| 17 | B53081 | 53081 AUTOMATIC CHOKE KIT PHVA | 1 |
| 20 | B01411 | 1411 SPRING | 1 |
| 22 | B14130 | 14130 SCREW | 1 |
| 23 | B53029 | 53029 SCREW KIT for SLIDE REG. PHVA | 1 |
| 25 | B53086 | 53086 SLIDE SCREW KIT | 1 |
| 26 | B53072 | 53072 VALVE SCREW KIT PHVA | 1 |
| 27 | B15058 | 15058 SPRING | 1 |
| 28 | B13687 | 13687 CLIP | 1 |
| 29 | B13681 | 13681 CLIP | 1 |
| 30 | B53053 | 53053 FLOAT KIT PHVA-PHBN | 1 |
| 33 | B13709 | 13709 SCREW | 2 |
| 36 | B14699 | 14699 BOWL | 1 |
| 43 | B52622 | 52622 GASKET KIT PHVA...B-C-D-E-G-H-L | 1 |

