

# A01403 - 1403 CARB. PHVA 17 5 TS

## CARBURETOR SPARE PARTS FILE

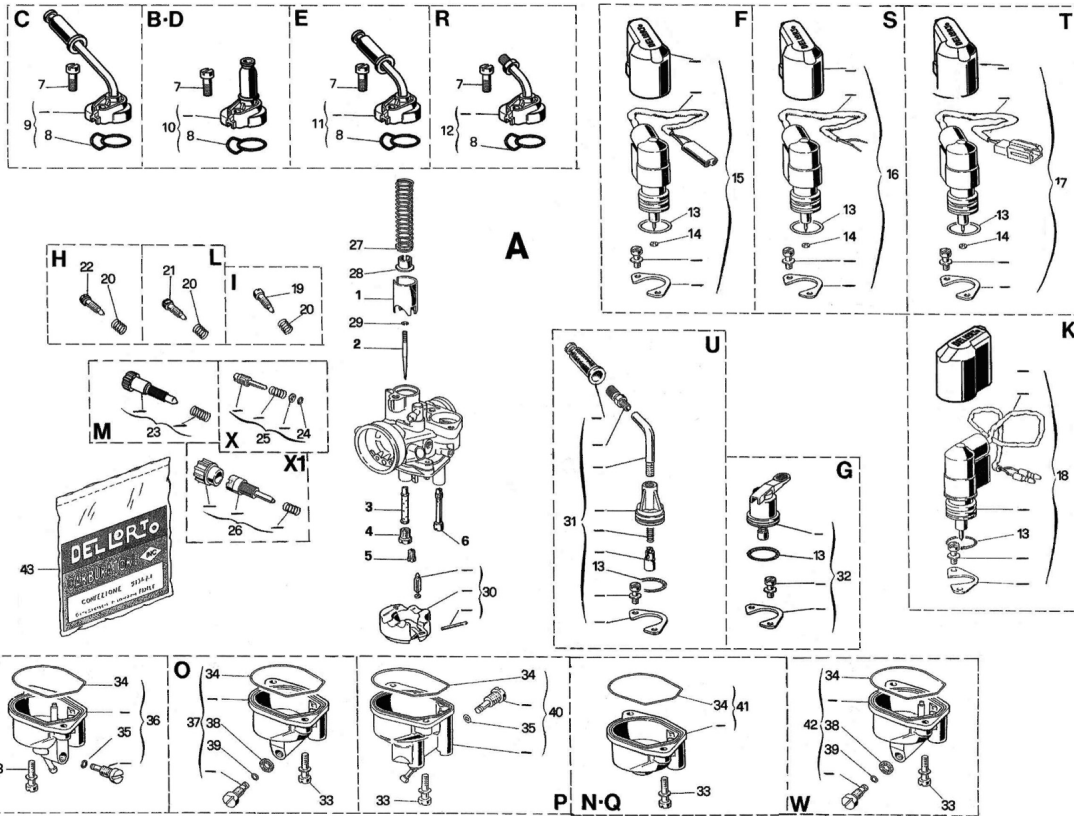

N°	Part Number	Description	Qty
0	<b>A01403</b>	1403 CARB. PHVA 17 5 TS	1
1	<b>B15362.040</b>	15362 SLIDE 40	1
2	<b>B16250.002</b>	16250 CONICAL NEEDLE A 2	1
3	<b>B14671.209</b>	14671 NEEDLE JET GA 209	1
4	<b>B06413.095</b>	6413 MAIN JET 95	1
5	<b>B11600.038</b>	11600 JET 38	1
6	<b>B15150.045</b>	15150 JET 45	1
7	<b>B07526</b>	7526 SCREW	1
10	<b>B14562</b>	14562 VALVE COVER	1
20	<b>B01411</b>	1411 SPRING	1
22	<b>B14130</b>	14130 SCREW	1
23	<b>B53029</b>	53029 SCREW KIT for SLIDE REG. PHVA	1
25	<b>B53086</b>	53086 SLIDE SCREW KIT	1
26	<b>B53072</b>	53072 VALVE SCREW KIT PHVA	1
27	<b>B15349</b>	15349 SPRING	1
28	<b>B13687</b>	13687 CLIP	1
29	<b>B13681</b>	13681 CLIP	1
30	<b>B53053</b>	53053 FLOAT KIT PHVA-PHBN	1
33	<b>B13709</b>	13709 SCREW	2
41	<b>B13678</b>	13678 BOWL	1
43	<b>B52622</b>	52622 GASKET KIT PHVA...B-C-D-E-G-H-L	1