

# A01463 - 1463 CARB. PHVA 12 PS

## FICHE DE PIÈCES DÉTACHÉES CARBURATEUR

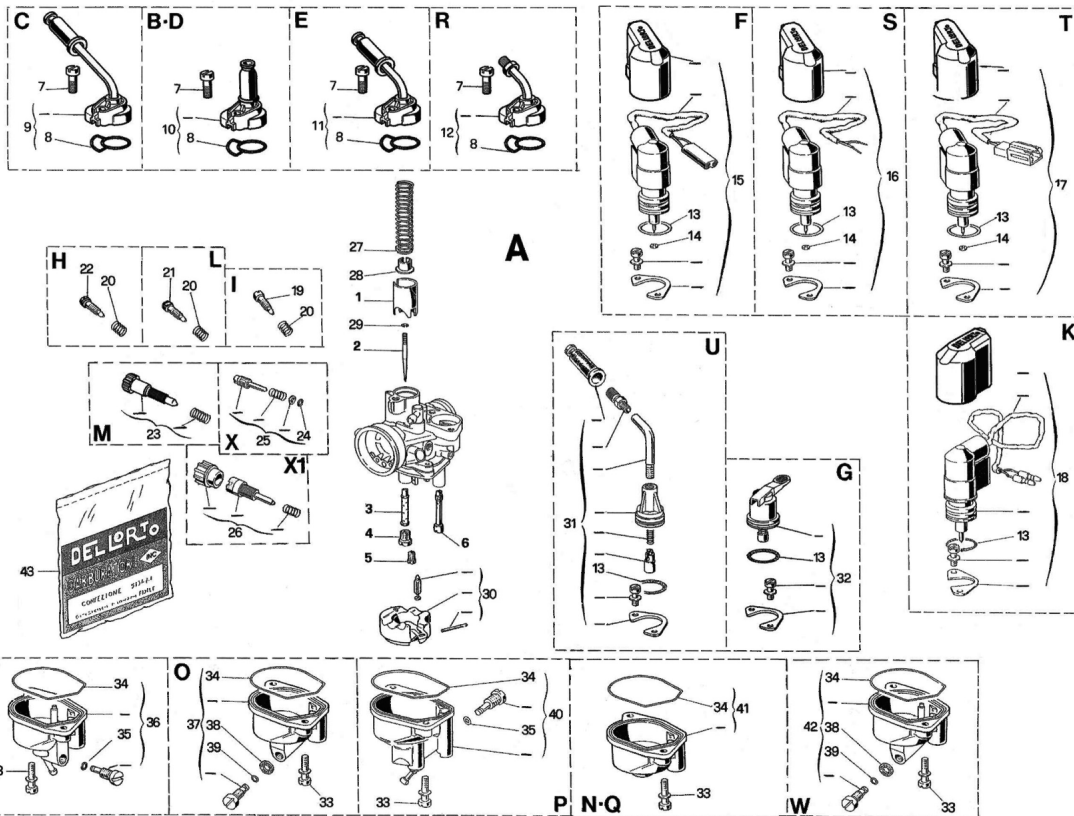

N°	Référence	Description	Qté
0	<b>A01463</b>	1463 CARB. PHVA 12 PS	1
1	<b>B15249.040</b>	15249 BOISSEAU GAZ 40	1
2	<b>B13680.012</b>	13680 AIGUILLE CONIQUE A 12	1
3	<b>B14671.211</b>	14671 ATOMISEUR GA 211	1
4	<b>B06413.068</b>	6413 GICLEUR 68	1
5	<b>B11600.038</b>	11600 GICLEUR 38	1
6	<b>B15280.048</b>	15280 GICLEUR 48	1
7	<b>B07526</b>	7526 VIS	1
17	<b>B53081</b>	53081 KIT STARTER AUTOM. PHVA	1
20	<b>B01411</b>	1411 RESSORT	1
22	<b>B14130</b>	14130 VIS	1
23	<b>B53029</b>	53029 KIT VIS REG. BOISSEAU GAZ PHVA	1
25	<b>B53086</b>	53086 KIT VIS REG. BOISSEAU GAZ	1
26	<b>B53072</b>	53072 KIT VIS BOISSEAU PHVA	1
27	<b>B15058</b>	15058 RESSORT	1
28	<b>B13687</b>	13687 CLIP	1
29	<b>B13681</b>	13681 ARRET	1
30	<b>B53053</b>	53053 KIT FLOTTEUR PHVA-PHBN	1
33	<b>B13709</b>	13709 VIS	2
36	<b>B14699</b>	14699 CUVE	1
43	<b>B52622</b>	52622 KIT JOINTS PHVA...B-C-D-E-G-H-L	1

