

# A01515 - 1515 VERG. SHA 14 12L

## ERSATZTEILLISTE VERGASER

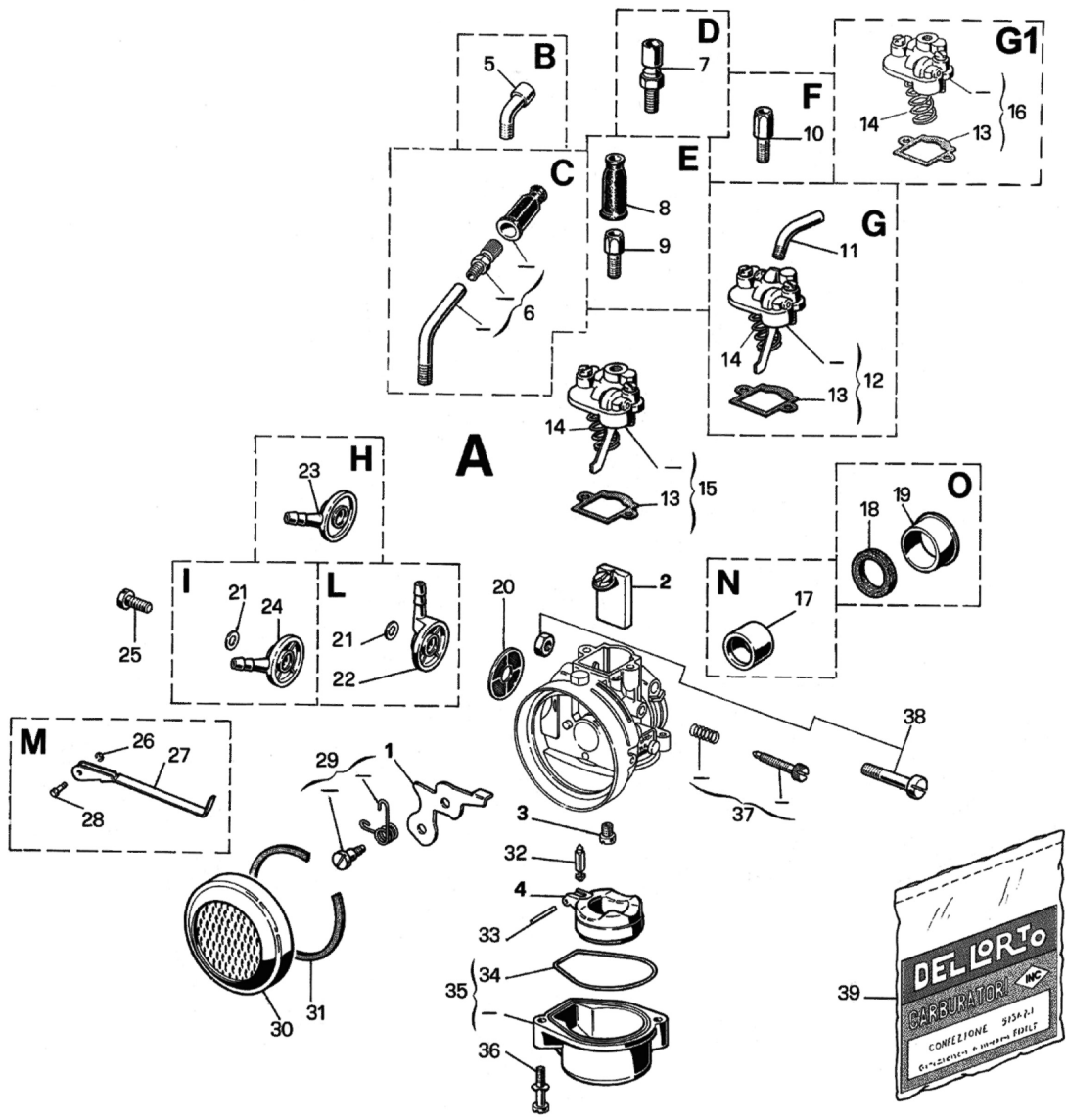

| N° | Artikelnummer     | Beschreibung   | Mg. |
|----|-------------------|--|-----|
| 0  | <b>A01515</b>     | 1515 VERG. SHA 14 12L  | 1   |
| 1  | <b>B06114.050</b> | 6114 AIR VALVE 50  | 1   |
| 2  | <b>B06108.002</b> | 6108 SLIDE 2   | 1   |
| 3  | <b>B01486.057</b> | 1486 PILOT JET 57  | 1   |
| 4  | <b>B06122.002</b> | 6122 FLOAT 2 gr. 3,5   | 1   |
| 13 | <b>B52579</b>     | 52579 GASKET KIT SHA 14...C-H-L-N-P-R-S-15...N-C-G-16...C-G  | 1   |
| 15 | <b>B09603</b>     | 9603 FUEL MIXING CHAMBER COVER                               | 1   |
| 18 | <b>B52579</b>     | 52579 GASKET KIT SHA 14...C-H-L-N-P-R-S-15...N-C-G-16...C-G  | 1   |
| 19 | <b>B11362</b>     | 11362 REDUCTION  | 1   |
| 20 | <b>B06109</b>     | 6109 FUEL FILTER   | 1   |
| 21 | <b>B52579</b>     | 52579 GASKET KIT SHA 14...C-H-L-N-P-R-S-15...N-C-G-16...C-G  | 1   |
| 23 | <b>B09249</b>     | 9249 INLET PIPE  | 1   |
| 25 | <b>B04190</b>     | 4190 SCREW   | 1   |
| 29 | <b>B53045</b>     | 53045 AIR VALVE PIN KIT SHA 14-L-N-R-C-SS-..H-15-C-.         | 1   |
| 30 | <b>B06117</b>     | 6117 FILTER GAUZE  | 1   |
| 31 | <b>B52579</b>     | 52579 GASKET KIT SHA 14...C-H-L-N-P-R-S-15...N-C-G-16...C-G  | 1   |
| 32 | <b>B02838</b>     | 2838 FUEL BLANKING NEEDLE                                    | 1   |
| 33 | <b>B08773</b>     | 8773 PIN   | 1   |
| 34 | <b>B52579</b>     | 52579 GASKET KIT SHA 14...C-H-L-N-P-R-S-15...N-C-G-16...C-G  | 1   |
| 35 | <b>B13412</b>     | 13412 BOWL   | 1   |
| 36 | <b>B11837</b>     | 11837 SCREW  | 2   |
| 37 | <b>B53030</b>     | 53030 SCREW KIT for SLIDE REG. SHA 10...-12...-13...-14...-1 | 1   |
| 38 | <b>B53049</b>     | 53049 RUBBER SCREW KIT SHA 14-15-16                          | 1   |
| 39 | <b>B52579</b>     | 52579 GASKET KIT SHA 14...C-H-L-N-P-R-S-15...N-C-G-16...C-G  | 1   |