

# A01515 - 1515 CARB. SHA 14 12L

## FICHA DE REPUESTOS CARBURADOR

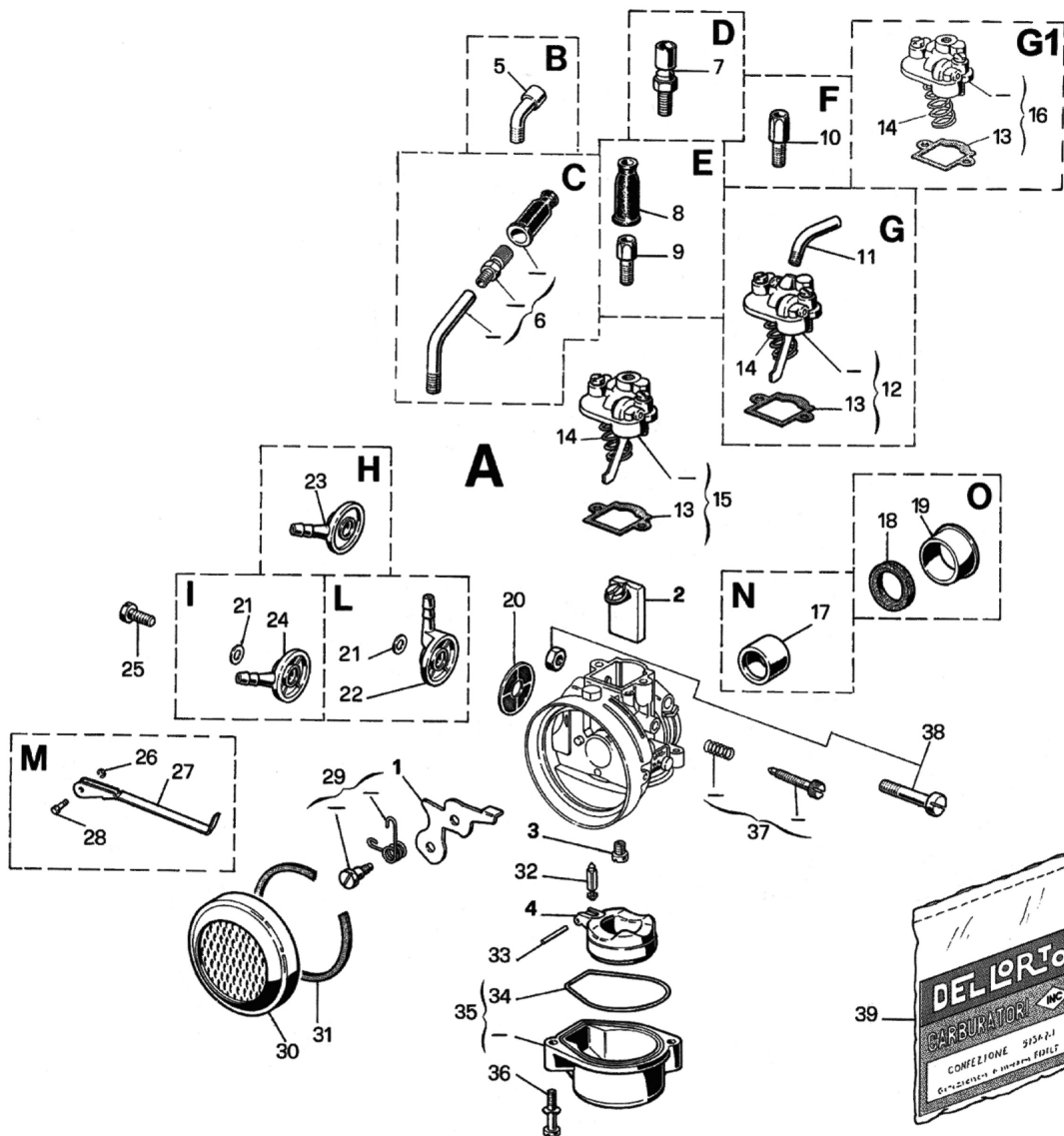

Nº	Referencia	Descripción	Cant.
0	<b>A01515</b>	1515 CARB. SHA 14 12L	1
1	<b>B06114.050</b>	6114 VÁLVULA AIRE 50	1
2	<b>B06108.002</b>	6108 VÁLVULA GAS 2	1
3	<b>B01486.057</b>	1486 CHORRO 57	1
4	<b>B06122.002</b>	6122 FLOTADOR 2 gr. 3,5	1
13	<b>B52579</b>	52579 KIT JUNTAS SHA 14...C-H-L-N-P-R-S-15...N-C-G-16...C-G	1
15	<b>B09603</b>	9603 TAPA CAMARA MEZCLA CARBUR.	1
18	<b>B52579</b>	52579 KIT JUNTAS SHA 14...C-H-L-N-P-R-S-15...N-C-G-16...C-G	1
19	<b>B11362</b>	11362 REDUCCIÓN AISLANTE	1
20	<b>B06109</b>	6109 FILTRO GASOLINA	1
21	<b>B52579</b>	52579 KIT JUNTAS SHA 14...C-H-L-N-P-R-S-15...N-C-G-16...C-G	1
23	<b>B09249</b>	9249 PIPA	1
25	<b>B04190</b>	4190 TORNILLO	1
29	<b>B53045</b>	53045 KIT EJE VÁLVULA AIRE SHA 14-LL-N-R-C-S-...H-15-C-	1
30	<b>B06117</b>	6117 ELEMENTO FILTRANTE	1
31	<b>B52579</b>	52579 KIT JUNTAS SHA 14...C-H-L-N-P-R-S-15...N-C-G-16...C-G	1
32	<b>B02838</b>	2838 PUNZON CIERRE GASOLINA	1
33	<b>B08773</b>	8773 EJE	1
34	<b>B52579</b>	52579 KIT JUNTAS SHA 14...C-H-L-N-P-R-S-15...N-C-G-16...C-G	1
35	<b>B13412</b>	13412 CUBETA	1
36	<b>B11837</b>	11837 TORNILLO	2
37	<b>B53030</b>	53030 KIT TORNILLO REG. VÁLVULA GASS SHA10...-12...-13...-14...-1	1
38	<b>B53049</b>	53049 KIT TORNILLO APRET. MANGUITO SHA144-15-16	1
39	<b>B52579</b>	52579 KIT JUNTAS SHA 14...C-H-L-N-P-R-S-15...N-C-G-16...C-G	1