

# A02521 - 2521 CARB. PHBG 19 AS

## CARBURETOR SPARE PARTS FILE

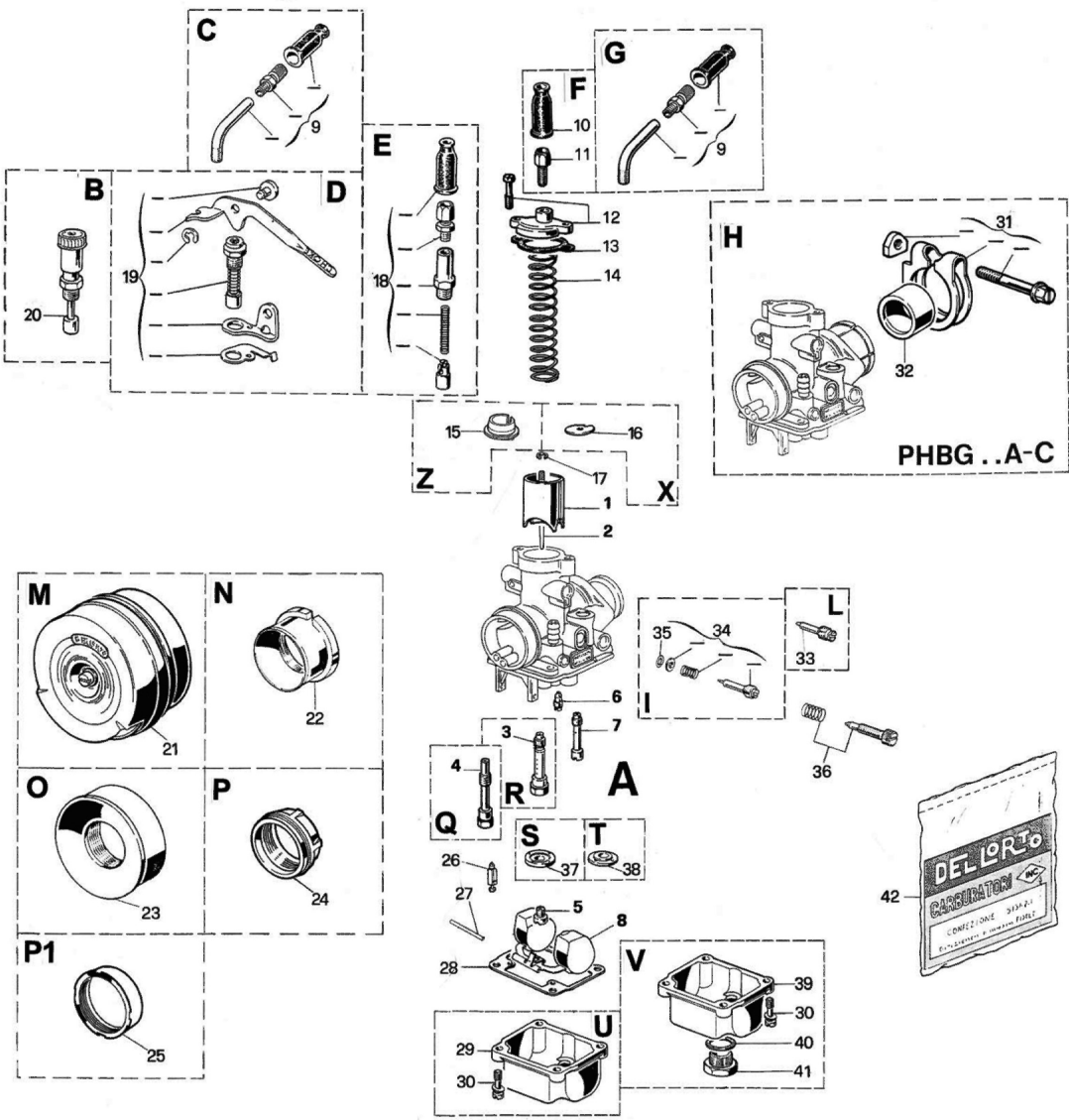

N°	Part Number	Description	Qty
0	<b>A02521</b>	2521 CARB. PHBG 19 AS	1
1	<b>B09475.040</b>	9475 SLIDE 40	1
2	<b>B09595.006</b>	9595 CONICAL NEEDLE W 6	1
3	<b>B09511.262</b>	9511 NEEDLE JET AN 262	1
5	<b>B01486.088</b>	1486 PILOT JET 88	1
6	<b>B01488.050</b>	1488 JET 50	1
7	<b>B09501.055</b>	9501 JET 55	1
8	<b>B09450.002</b>	9450 FLOAT 2 gr. 5	1
10	<b>B01476</b>	1476 CAP	1
11	<b>B01104</b>	1104 SCREW	1
12	<b>B53031</b>	53031 SLIDE COVER KIT PHBG	1
13	<b>B52526</b>	52526 GASKETS KIT PHBG/A-B-C-D	1
14	<b>B09597</b>	9597 SPRING	1
15	<b>B14958</b>	14958 CLIP	1
17	<b>B09596</b>	9596 CLIP	1
20	<b>B09538</b>	9538 STARTER	1
26	<b>B02838</b>	2838 FUEL BLANKING NEEDLE	1
27	<b>B09506</b>	9506 PIN	1
28	<b>B52526</b>	52526 GASKETS KIT PHBG/A-B-C-D	1
29	<b>B09444</b>	9444 BOWL	1
30	<b>B11836</b>	11836 SCREW	4
31	<b>B53016</b>	53016 CLAMP KIT Ø 30 PHBG-SHBC	1
32	<b>B08376</b>	8376 INSULATING ADAPTER	1
34	<b>B53024</b>	53024 SCREW KIT for MIN.REG. PHBG	1
35	<b>B52526</b>	52526 GASKETS KIT PHBG/A-B-C-D	1
36	<b>B53027</b>	53027 SCREW KIT for SLIDE REG. PHBG	1
40	<b>B52526</b>	52526 GASKETS KIT PHBG/A-B-C-D	1
42	<b>B52526</b>	52526 GASKETS KIT PHBG/A-B-C-D	1

