

# A02527 - 2527 CARB. PHBG 20 AS

## CARBURETOR SPARE PARTS FILE

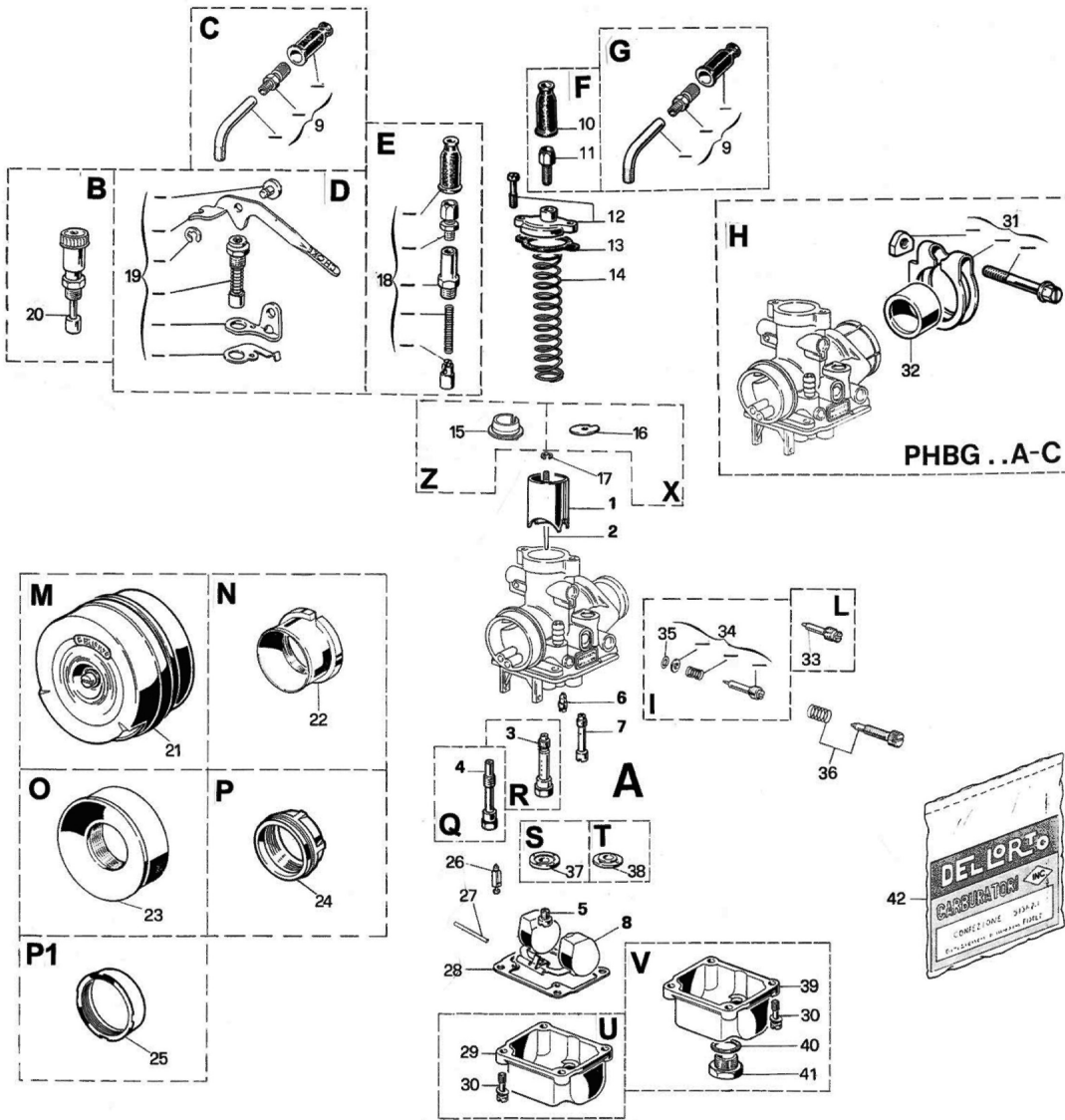

N°	Part Number	Description	Qty
0	<b>A02527</b>	2527 CARB. PHBG 20 AS	1
1	<b>B09475.040</b>	9475 SLIDE 40	1
2	<b>B09595.007</b>	9595 CONICAL NEEDLE W 7	1
4	<b>B09654.262</b>	9654 NEEDLE JET AU 262	1
5	<b>B01486.090</b>	1486 PILOT JET 90	1
6	<b>B01488.050</b>	1488 JET 50	1
7	<b>B09501.060</b>	9501 JET 60	1
8	<b>B09450.001</b>	9450 FLOAT 1 gr. 4	1
10	<b>B01476</b>	1476 CAP	1
11	<b>B01104</b>	1104 SCREW	1
12	<b>B53031</b>	53031 SLIDE COVER KIT PHBG	1
13	<b>B52526</b>	52526 GASKETS KIT PHBG/A-B-C-D	1
14	<b>B09597</b>	9597 SPRING	1
15	<b>B14958</b>	14958 CLIP	1
17	<b>B09596</b>	9596 CLIP	1
20	<b>B09538</b>	9538 STARTER	1
26	<b>B02838</b>	2838 FUEL BLANKING NEEDLE	1
27	<b>B09506</b>	9506 PIN	1
28	<b>B52526</b>	52526 GASKETS KIT PHBG/A-B-C-D	1
29	<b>B09444</b>	9444 BOWL	1
30	<b>B11836</b>	11836 SCREW	4
31	<b>B53016</b>	53016 CLAMP KIT Ø 30 PHBG-SHBC	1
32	<b>B08376</b>	8376 INSULATING ADAPTER	1
34	<b>B53024</b>	53024 SCREW KIT for MIN.REG. PHBG	1
35	<b>B52526</b>	52526 GASKETS KIT PHBG/A-B-C-D	1
36	<b>B53027</b>	53027 SCREW KIT for SLIDE REG. PHBG	1
37	<b>B13548</b>	13548 BOTTOM	1
40	<b>B52526</b>	52526 GASKETS KIT PHBG/A-B-C-D	1
42	<b>B52526</b>	52526 GASKETS KIT PHBG/A-B-C-D	1