

# A02724 - 2724 CARB. PHBL 24 BS

## CARBURETOR SPARE PARTS FILE

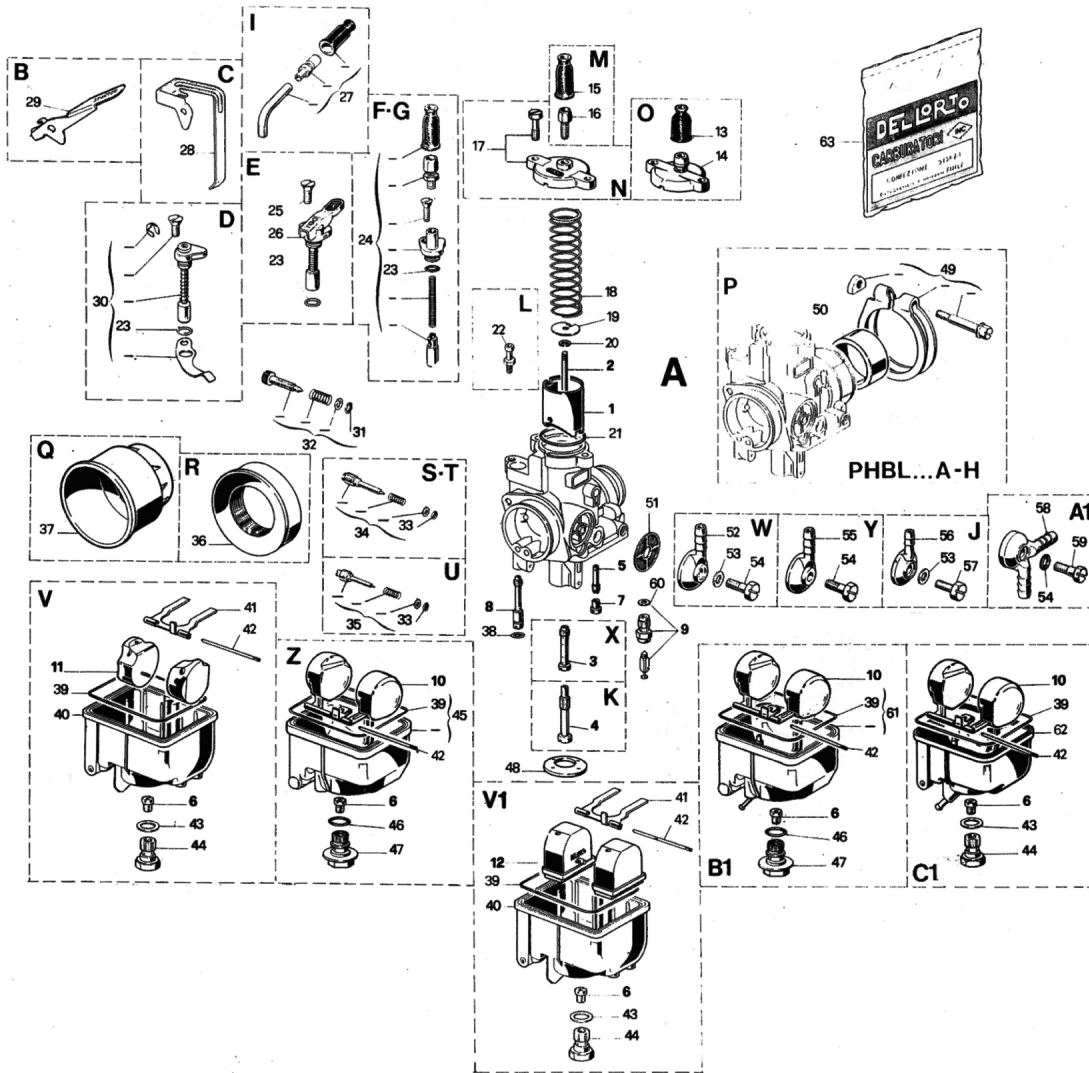

N°	Part Number	Description	Qty
0	<a href="#">A02724</a>	2724 CARB. PHBL 24 BS	1
1	<a href="#">B09645.040</a>	9645 SLIDE 40	1
2	<a href="#">B02265.022</a>	2265 CONICAL NEEDLE D 22	1
4	<a href="#">B09564.264</a>	9564 NEEDLE JET AQ 264	1
6	<a href="#">B06413.100</a>	6413 MAIN JET 100	1
7	<a href="#">B01486.050</a>	1486 PILOT JET 50	1
8	<a href="#">B07746.060</a>	7746 JET 60	1
9	<a href="#">B09436.200</a>	9436 FLOAT NEEDLE VALVE 200	1
9	<a href="#">B10375.200</a>	10375 FLOAT NEEDLE VALVE 200	1
10	<a href="#">B09010.002</a>	9010 FLOAT 2 gr. 6,5	1
16	<a href="#">B01104</a>	1104 SCREW	1
17	<a href="#">B53033</a>	53033 SLIDE COVER KIT PHBL	1
18	<a href="#">B09644</a>	9644 SPRING	1
19	<a href="#">B09563</a>	9563 TAB WASHER	1
20	<a href="#">B09596</a>	9596 CLIP	1
21	<a href="#">B52524</a>	52524 GASKET KIT PHBL...A-B-E-G-H	1
23	<a href="#">B52524</a>	52524 GASKET KIT PHBL...A-B-E-G-H	1
25	<a href="#">B07745</a>	7745 SCREW	1
26	<a href="#">B08294</a>	8294 STARTER	1
31	<a href="#">B52524</a>	52524 GASKET KIT PHBL...A-B-E-G-H	1
32	<a href="#">B53028</a>	53028 SCREW KIT for SLIDE REG. PHBE	1
33	<a href="#">B52524</a>	52524 GASKET KIT PHBL...A-B-E-G-H	1
34	<a href="#">B53022</a>	53022 SCREW KIT for MIN. REG. PHBH-PHBL-PHF-PHM	1
38	<a href="#">B52524</a>	52524 GASKET KIT PHBL...A-B-E-G-H	1
39	<a href="#">B52524</a>	52524 GASKET KIT PHBL...A-B-E-G-H	1
42	<a href="#">B07346</a>	7346 PIN	1
43	<a href="#">B52524</a>	52524 GASKET KIT PHBL...A-B-E-G-H	1
45	<a href="#">B13781</a>	13781 BOWL	1
46	<a href="#">B52524</a>	52524 GASKET KIT PHBL...A-B-E-G-H	1
47	<a href="#">B11771</a>	11771 PLUG	1
48	<a href="#">B09996</a>	9996 BOTTOM	1
51	<a href="#">B06109</a>	6109 FUEL FILTER	1
53	<a href="#">B52524</a>	52524 GASKET KIT PHBL...A-B-E-G-H	1
54	<a href="#">B04568</a>	4568 SCREW	1
55	<a href="#">B09250</a>	9250 INLET PIPE	1
60	<a href="#">B52524</a>	52524 GASKET KIT PHBL...A-B-E-G-H	1
63	<a href="#">B52524</a>	52524 GASKET KIT PHBL...A-B-E-G-H	1