

COD. 15396-96

COD. 14699-96

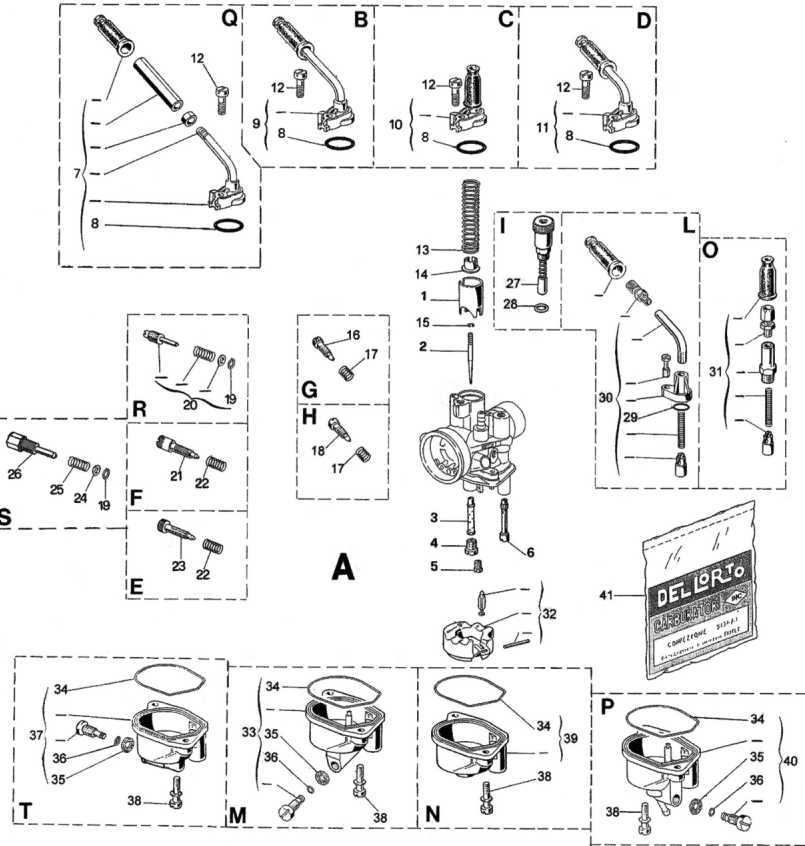
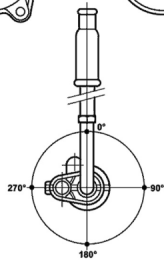
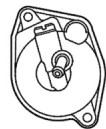

N°	Part Number	Description	Qty
0	<b>A03097</b>	3097 CARB. PHBN 12 GS	1
1	<b>B15249.040</b>	15249 SLIDE 40	1
2	<b>B13680.012</b>	13680 CONICAL NEEDLE A 12	1
3	<b>B14671.211</b>	14671 NEEDLE JET GA 211	1
4	<b>B06413.084</b>	6413 MAIN JET 84	1
5	<b>B11600.038</b>	11600 JET 38	1
6	<b>B13815.045</b>	13815 JET 45	1
11	<b>B15763</b>	15763 FUEL CHAMBER COVER	1
12	<b>B07526</b>	7526 SCREW	1
13	<b>B15058</b>	15058 SPRING	1
14	<b>B13687</b>	13687 CLIP	1
15	<b>B13681</b>	13681 CLIP	1
17	<b>B01411</b>	1411 SPRING	1
18	<b>B14130</b>	14130 SCREW	1
18	<b>B53053</b>	53053 FLOAT KIT PHVA-PHBN	1
24	<b>B08260</b>	8260 WASHER	1
25	<b>B09336</b>	9336 SPRING	1
26	<b>B15807</b>	15807 SCREW	1
30	<b>B53004</b>	53004 LEVER STARTER KIT PHBN	1
33	<b>B14478</b>	14478 BOWL	1
38	<b>B13709</b>	13709 SCREW	2
41	<b>B52620</b>	52620 GASKET KIT PHBN...B-C	1