

COD. 15396-96

COD. 14699-96

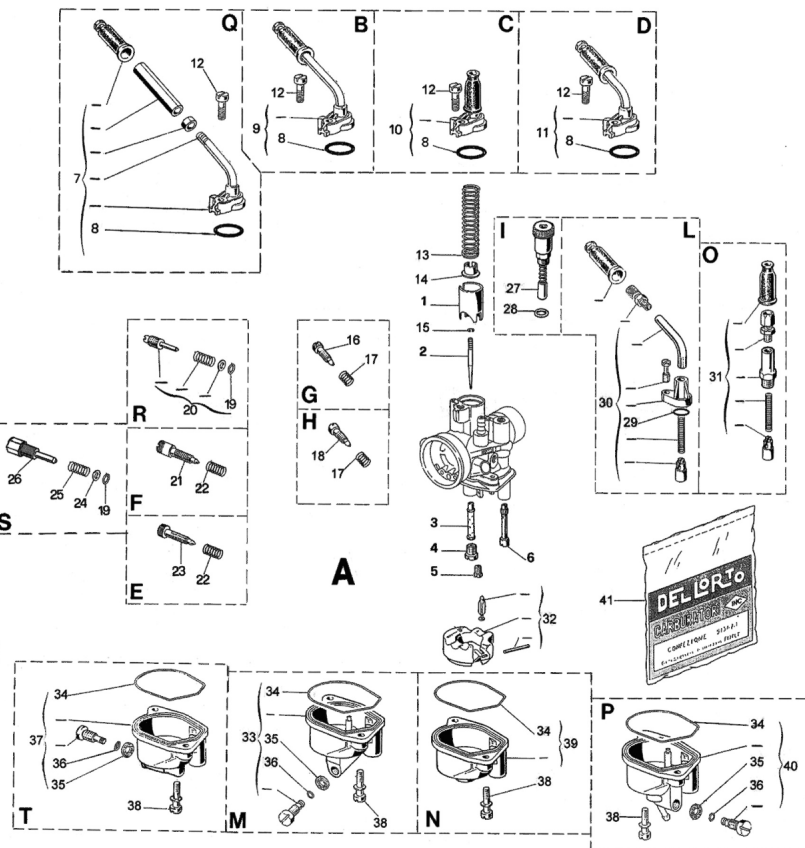
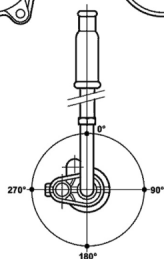
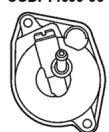
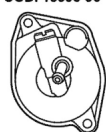

N°	Référence	Description	Qté
0	A03119	3119 CARB. PHBN 12 GS	1
1	B15249.030	15249 BOISSEAU GAZ 30	1
2	B13680.012	13680 AIGUILLE CONIQUE A 12	1
3	B14671.211	14671 ATOMISEUR GA 211	1
4	B06413.062	6413 GICLEUR 62	1
5	B11600.034	11600 GICLEUR 34	1
6	B14770.045	14770 GICLEUR 45	1
8	B52620	52620 KIT JOINTS PHBN...B-C	1
9	B15292	15292 COUVERCLE BOISSEAU	1
12	B07526	7526 VIS	1
13	B15058	15058 RESSORT	1
14	B13687	13687 CLIP	1
15	B13681	13681 ARRET	1
17	B01411	1411 RESSORT	1
18	B14130	14130 VIS	1
19	B52620	52620 KIT JOINTS PHBN...B-C	1
20	B53086	53086 KIT VIS REG. BOISSEAU GAZ	1
28	B52620	52620 KIT JOINTS PHBN...B-C	1
29	B52620	52620 KIT JOINTS PHBN...B-C	1
30	B53004	53004 KIT STARTER A CABLE PHBN	1
32	B53053	53053 KIT FLOTTEUR PHVA-PHBN	1
33	B14478	14478 CUVE	1
34	B52620	52620 KIT JOINTS PHBN...B-C	1
35	B52620	52620 KIT JOINTS PHBN...B-C	1
36	B52620	52620 KIT JOINTS PHBN...B-C	1
38	B13709	13709 VIS	2
41	B52620	52620 KIT JOINTS PHBN...B-C	1