

COD. 15396-96

COD. 14699-96

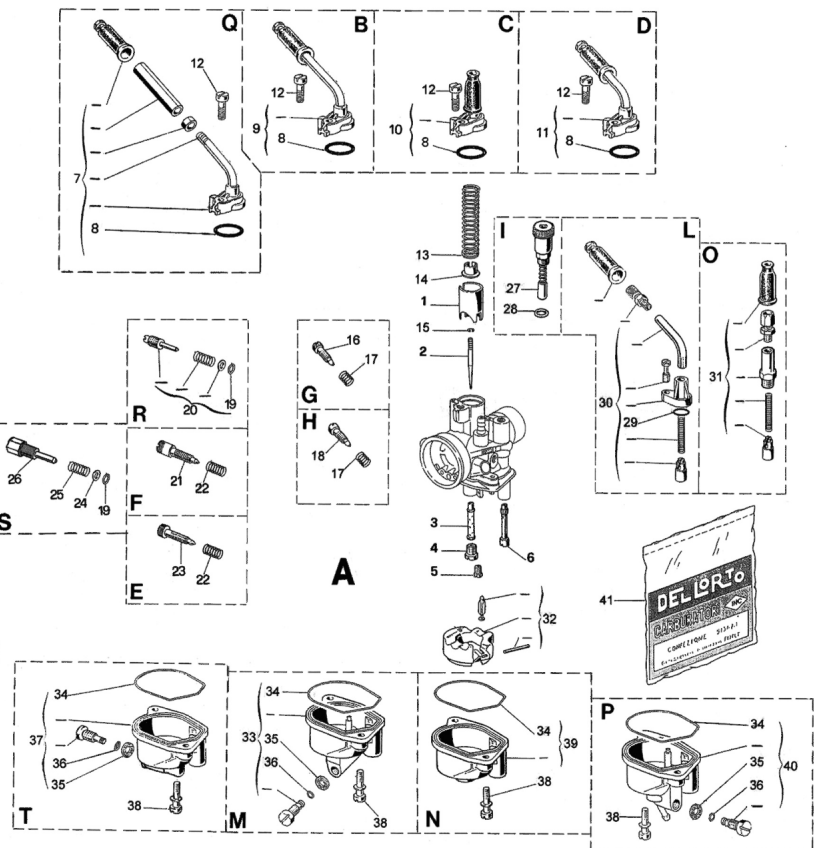
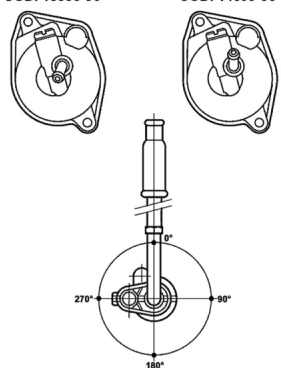

N°	Référence	Description	Qté
0	<b>A03126</b>	3126 CARB. PHBN 12 HS	1
1	<b>B15249.040</b>	15249 BOISSEAU GAZ 40	1
2	<b>B16250.034</b>	16250 AIGUILLE CONIQUE A 34	1
3	<b>B14225.210</b>	ATOMISEUR FP	1
4	<b>B06413.068</b>	6413 GICLEUR 68	1
5	<b>B11600.032</b>	11600 GICLEUR 32	1
6	<b>B15280.045</b>	15280 GICLEUR 45	1
8	<b>B52620</b>	52620 KIT JOINTS PHBN...B-C	1
10	<b>B16064</b>	16064 COUVERCLE CHAMBRE MELANGE	1
12	<b>B07526</b>	7526 VIS	1
13	<b>B15058</b>	15058 RESSORT	1
14	<b>B13687</b>	13687 CLIP	1
15	<b>B13681</b>	13681 ARRET	1
17	<b>B01411</b>	1411 RESSORT	1
18	<b>B14130</b>	14130 VIS	1
19	<b>B52620</b>	52620 KIT JOINTS PHBN...B-C	1
20	<b>B53086</b>	53086 KIT VIS REG. BOISSEAU GAZ	1
28	<b>B52620</b>	52620 KIT JOINTS PHBN...B-C	1
29	<b>B52620</b>	52620 KIT JOINTS PHBN...B-C	1
30	<b>B53004</b>	53004 KIT STARTER A CABLE PHBN	1
32	<b>B53053</b>	53053 KIT FLOTTEUR PHVA-PHBN	1
34	<b>B52620</b>	52620 KIT JOINTS PHBN...B-C	1
35	<b>B52620</b>	52620 KIT JOINTS PHBN...B-C	1
36	<b>B52620</b>	52620 KIT JOINTS PHBN...B-C	1
37	<b>B15769</b>	15769 CUVE	1
38	<b>B13709</b>	13709 VIS	2
41	<b>B52620</b>	52620 KIT JOINTS PHBN...B-C	1