

COD. 15396-96

COD. 14699-96

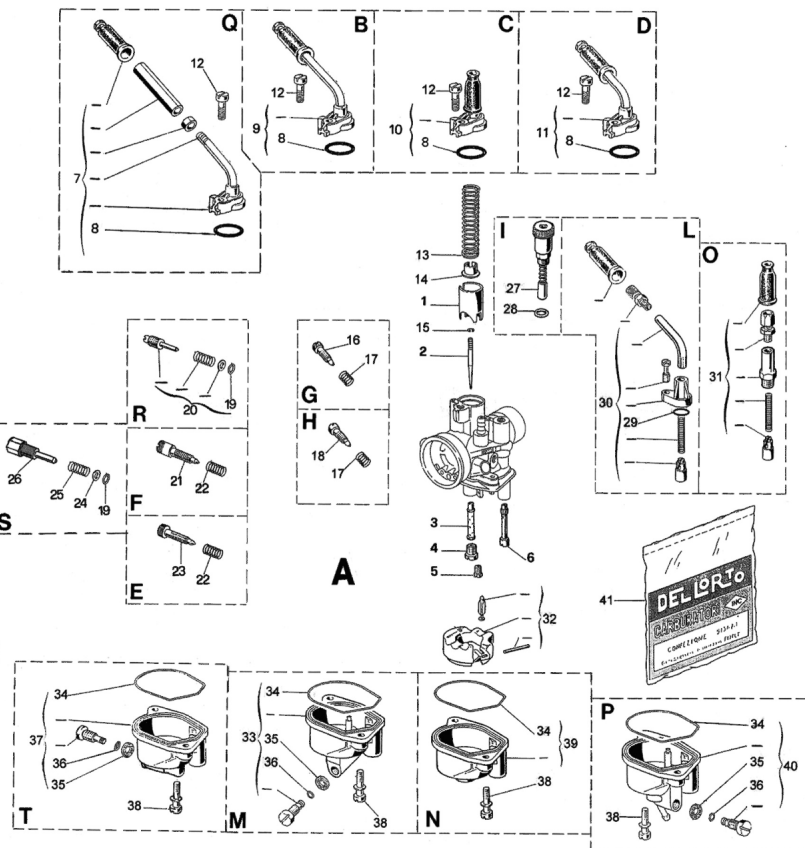
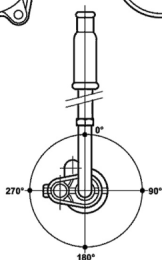
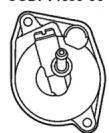
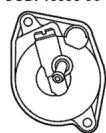

N°	Référence	Description	Qté
0	<b>A03129</b>	3129 CARB. PHBN 12 HS	1
1	<b>B15249.030</b>	15249 BOISSEAU GAZ 30	1
2	<b>B13680.020</b>	13680 AIGUILLE CONIQUE A 20	1
3	<b>B14671.209</b>	14671 ATOMISEUR GA 209	1
4	<b>B06413.072</b>	6413 GICLEUR 72	1
5	<b>B11600.038</b>	11600 GICLEUR 38	1
6	<b>B14770.045</b>	14770 GICLEUR 45	1
7	<b>B15475</b>	COUVERCLE CHAMBRE DE MELANGE	1
8	<b>B52620</b>	52620 KIT JOINTS PHBN...B-C	1
12	<b>B07526</b>	7526 VIS	1
13	<b>B15058</b>	15058 RESSORT	1
14	<b>B13687</b>	13687 CLIP	1
15	<b>B13681</b>	13681 ARRET	1
17	<b>B01411</b>	1411 RESSORT	1
18	<b>B14130</b>	14130 VIS	1
19	<b>B52620</b>	52620 KIT JOINTS PHBN...B-C	1
20	<b>B53086</b>	53086 KIT VIS REG. BOISSEAU GAZ	1
28	<b>B52620</b>	52620 KIT JOINTS PHBN...B-C	1
29	<b>B52620</b>	52620 KIT JOINTS PHBN...B-C	1
30	<b>B53004</b>	53004 KIT STARTER A CABLE PHBN	1
32	<b>B53053</b>	53053 KIT FLOTTEUR PHVA-PHBN	1
34	<b>B52620</b>	52620 KIT JOINTS PHBN...B-C	1
35	<b>B52620</b>	52620 KIT JOINTS PHBN...B-C	1
36	<b>B52620</b>	52620 KIT JOINTS PHBN...B-C	1
38	<b>B13709</b>	13709 VIS	2
40	<b>B15396</b>	15396 CUVE	1
41	<b>B52620</b>	52620 KIT JOINTS PHBN...B-C	1