

COD. 15396-96

COD. 14699-96

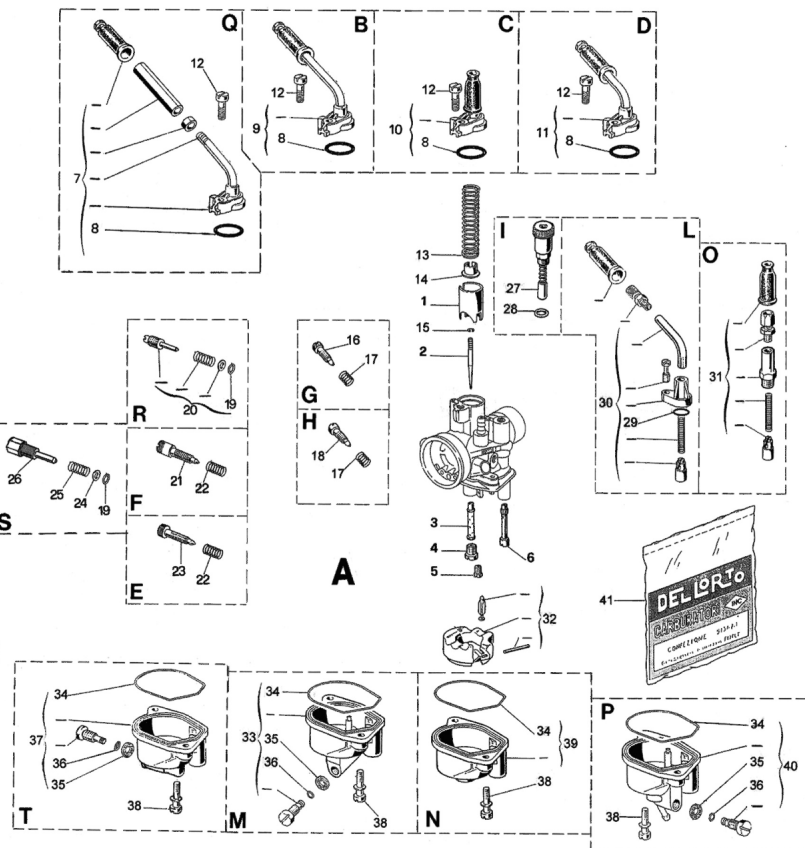
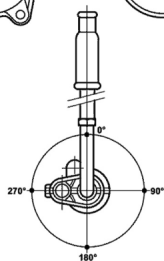
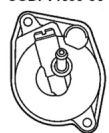

N°	Référence	Description	Qté
0	A03139	3139 CARB. PHBN 14 MS	1
1	B15362.040	15362 BOISSEAU GAZ 40	1
2	B16250.011	16250 AIGUILLE CONIQUE A 11	1
3	B14671.212	14671 ATOMISEUR GA 212	1
4	B06413.075	6413 GICLEUR 75	1
5	B11600.038	11600 GICLEUR 38	1
6	B06217.050	6217 GICLEUR 50	1
8	B52620	52620 KIT JOINTS PHBN...B-C	1
10	B14166	14166 COUVERCLE CHAMBRE MELANGE	1
12	B07526	7526 VIS	1
13	B15058	15058 RESSORT	1
14	B13687	13687 CLIP	1
15	B13681	13681 ARRET	1
16	B14056	14056 VIS	1
17	B01411	1411 RESSORT	1
19	B52620	52620 KIT JOINTS PHBN...B-C	1
20	B53086B	53086 KIT VIS REG. BOISSEAU GAZ	1
27	B08366	8366 STARTER	1
28	B52620	52620 KIT JOINTS PHBN...B-C	1
29	B52620	52620 KIT JOINTS PHBN...B-C	1
32	B53053	53053 KIT FLOTTEUR PHVA-PHBN	1
34	B52620	52620 KIT JOINTS PHBN...B-C	1
35	B52620	52620 KIT JOINTS PHBN...B-C	1
36	B52620	52620 KIT JOINTS PHBN...B-C	1
38	B13709	13709 VIS	2
39	B13678	13678 CUVE	1
41	B52620	52620 KIT JOINTS PHBN...B-C	1