

# A03311 - 3311 CARB. PHBH 28 BS

## CARBURETOR SPARE PARTS FILE

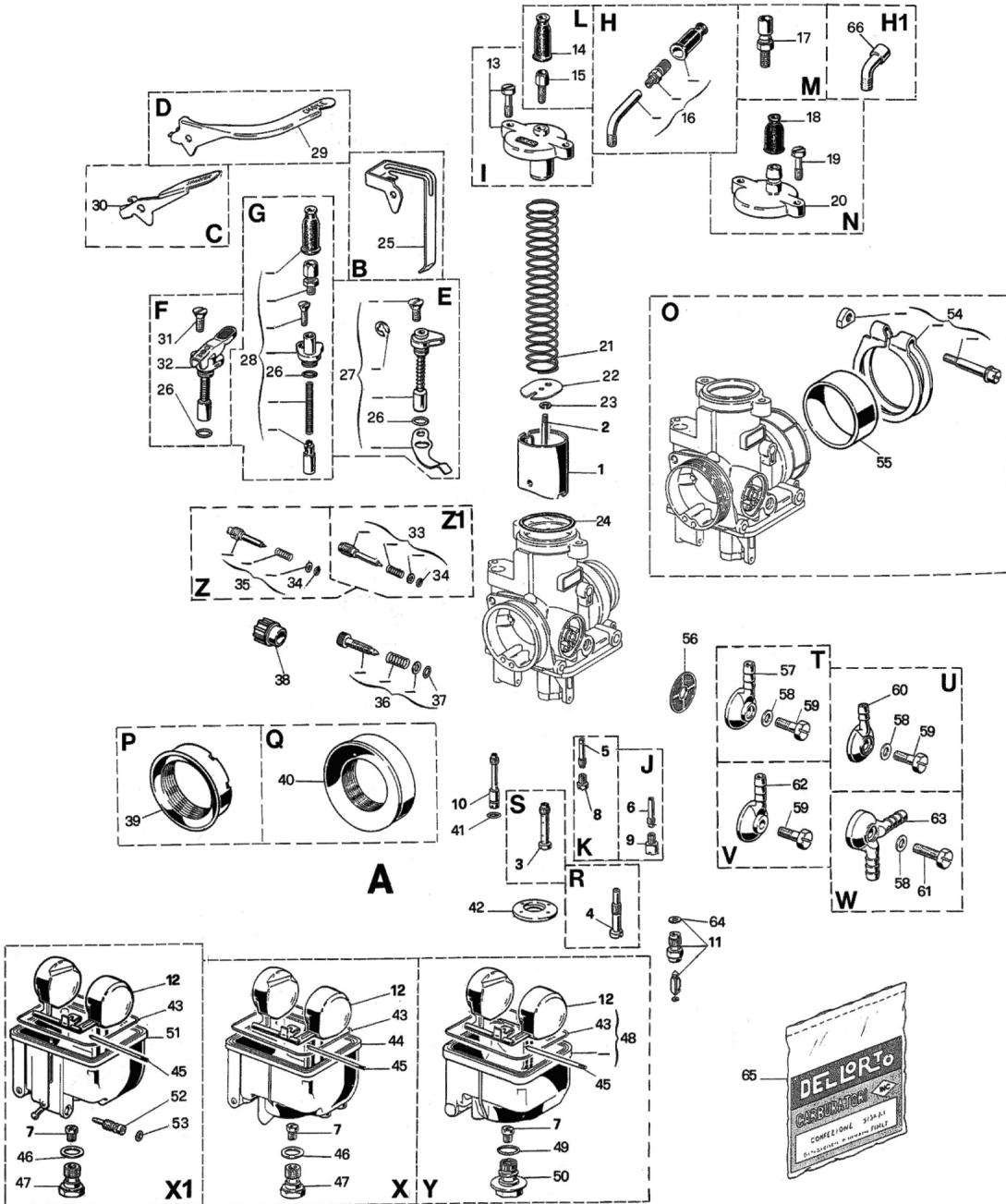

N°	Part Number	Description	Qty
0	<b>A03311</b>	3311 CARB. PHBH 28 BS	1
1	<b>B09374.040</b>	9374 SLIDE 40	1
2	<b>B09477.006</b>	9477 CONICAL NEEDLE X 6	1
3	<b>B07972.268</b>	7972 NEEDLE JET T 268	1
7	<b>B06413.130</b>	6413 MAIN JET 130	1
8	<b>B01486.050</b>	1486 PILOT JET 50	1
10	<b>B07746.060</b>	7746 JET 60	1
11	<b>B09436.200</b>	9436 FLOAT NEEDLE VALVE 200	1
11	<b>B10375.200</b>	10375 FLOAT NEEDLE VALVE 200	1
12	<b>B09010.001</b>	9010 FLOAT 1 gr. 9,5	1
13	<b>B53032</b>	53032 SLIDE COVER KIT PHBH	1
15	<b>B01104</b>	1104 SCREW	1
21	<b>B09425</b>	9425 SPRING	1
22	<b>B09375</b>	9375 PLATE	1
23	<b>B09596</b>	9596 CLIP	1
24	<b>B52523</b>	52523 GASKET KIT PHBH...A-B-D-E-F-G-H-I-L-M-N-R-S-T-U-V-Z-P	1
26	<b>B52523</b>	52523 GASKET KIT PHBH...A-B-D-E-F-G-H-I-L-M-N-R-S-T-U-V-Z-P	1
31	<b>B07745</b>	7745 SCREW	1
32	<b>B08294</b>	8294 STARTER	1
33	<b>B53022</b>	53022 SCREW KIT for MIN. REG. PHBH-PHBL-PHF-PHM	1
34	<b>B52523</b>	52523 GASKET KIT PHBH...A-B-D-E-F-G-H-I-L-M-N-R-S-T-U-V-Z-P	1
36	<b>B53028</b>	53028 SCREW KIT for SLIDE REG. PHBE	1
37	<b>B52523</b>	52523 GASKET KIT PHBH...A-B-D-E-F-G-H-I-L-M-N-R-S-T-U-V-Z-P	1
41	<b>B52523</b>	52523 GASKET KIT PHBH...A-B-D-E-F-G-H-I-L-M-N-R-S-T-U-V-Z-P	1
43	<b>B52523</b>	52523 GASKET KIT PHBH...A-B-D-E-F-G-H-I-L-M-N-R-S-T-U-V-Z-P	1
45	<b>B07346</b>	7346 PIN	1
46	<b>B52523</b>	52523 GASKET KIT PHBH...A-B-D-E-F-G-H-I-L-M-N-R-S-T-U-V-Z-P	1
48	<b>B13781</b>	13781 BOWL	1
49	<b>B52523</b>	52523 GASKET KIT PHBH...A-B-D-E-F-G-H-I-L-M-N-R-S-T-U-V-Z-P	1
50	<b>B11771</b>	11771 PLUG	1
53	<b>B52523</b>	52523 GASKET KIT PHBH...A-B-D-E-F-G-H-I-L-M-N-R-S-T-U-V-Z-P	1
56	<b>B06109</b>	6109 FUEL FILTER	1
58	<b>B52523</b>	52523 GASKET KIT PHBH...A-B-D-E-F-G-H-I-L-M-N-R-S-T-U-V-Z-P	1
59	<b>B04568</b>	4568 SCREW	1
62	<b>B09250</b>	9250 INLET PIPE	1
64	<b>B52523</b>	52523 GASKET KIT PHBH...A-B-D-E-F-G-H-I-L-M-N-R-S-T-U-V-Z-P	1
65	<b>B52523</b>	52523 GASKET KIT PHBH...A-B-D-E-F-G-H-I-L-M-N-R-S-T-U-V-Z-P	1